

This supplementary instruction manual contains only the steps specific to the LAZER ZX-RR assembly. Use it together with the LAZER ZX-R instruction manual.

### 1 • The shocks changed. Use Bag No.1,3,6

- |                                    |   |
|------------------------------------|---|
| <p>16 E-ring</p> <p>8</p>          | <p>163 3×7×2mm Collar</p> <p>8</p>                            |
| <p>159 O-ring (Blue)</p> <p>8</p>  | <p>154 3×6×3mm Collar<br/>(incl.with front hubs)</p> <p>2</p> |
| <p>160 3×6×2mm Collar</p> <p>4</p> |   |
| <p>161 3×7×1mm Collar</p> <p>4</p> |   |
| <p>162 C-ring</p> <p>4</p>         |   |
| <p>20 5.8mm Ball</p> <p>8</p>      |   |

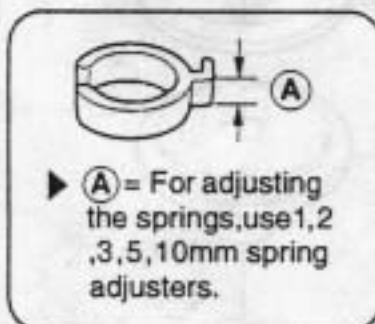
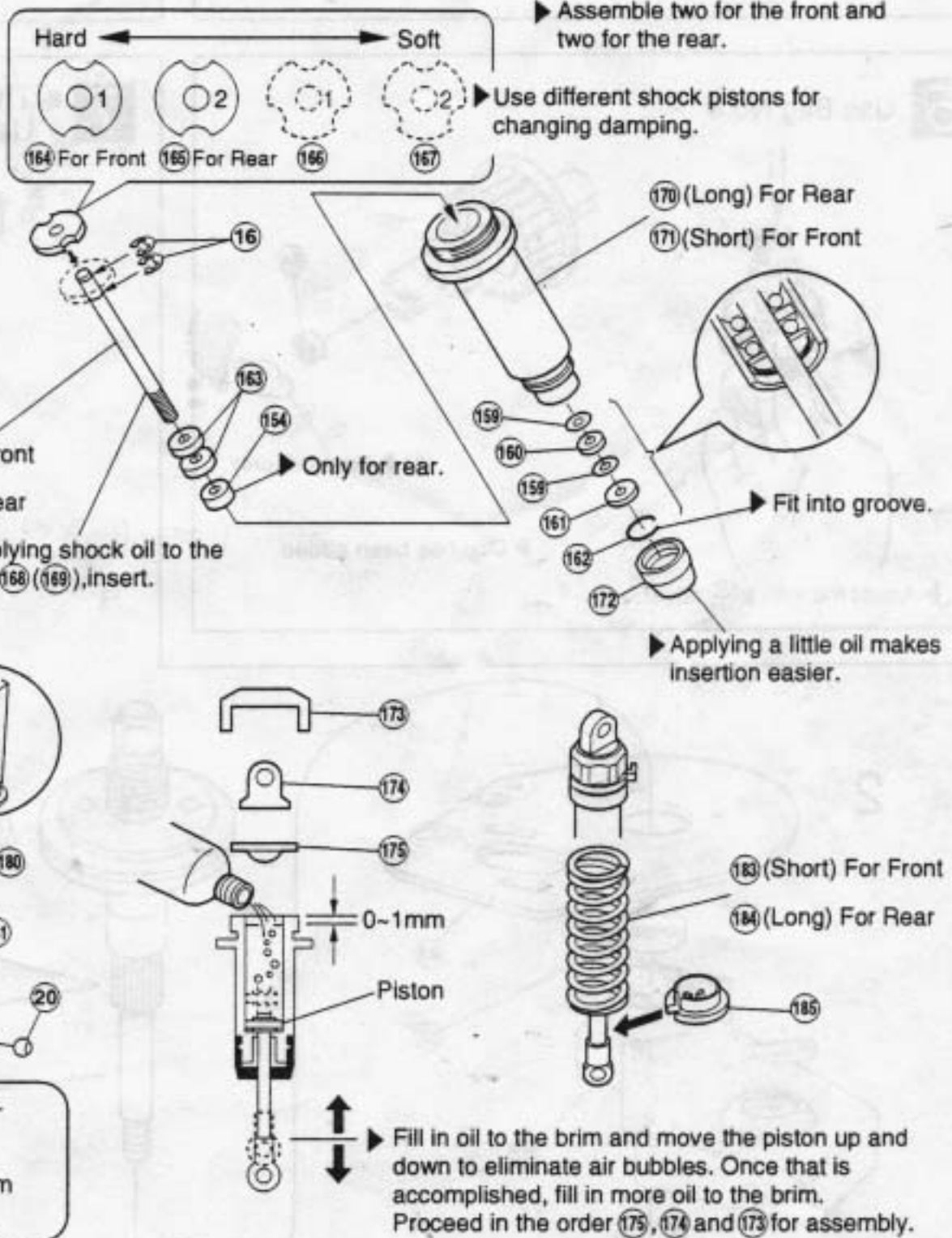

### 2 • Assemble the control rods. as shown below. Use Bag No.3

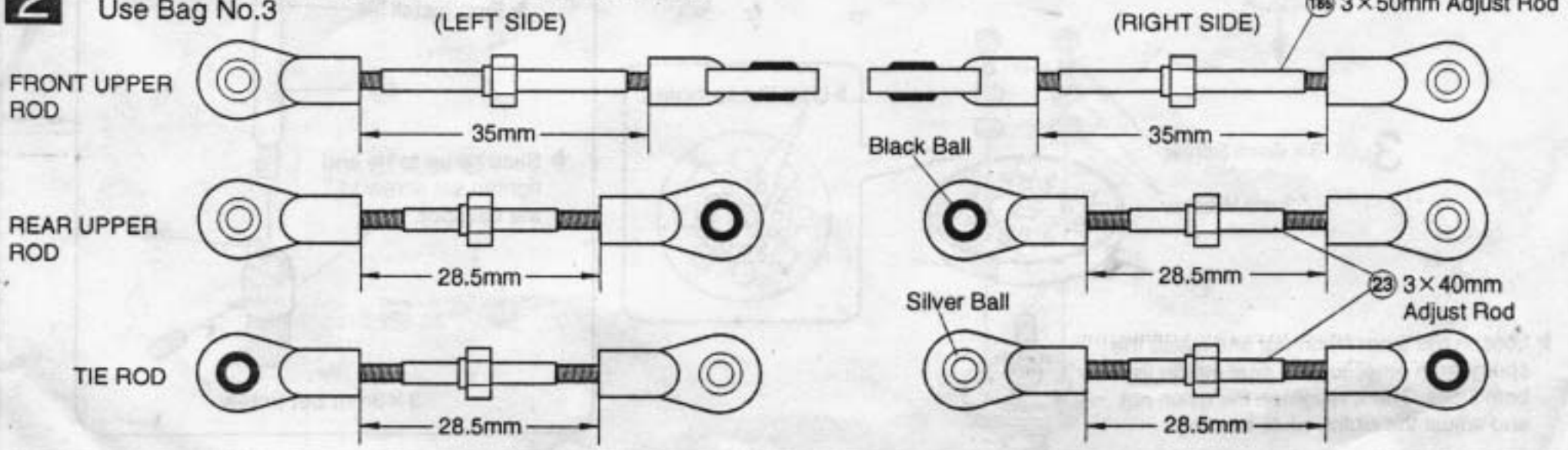

- 3** • Trim the gear cover as shown.  
Use Bag No.4

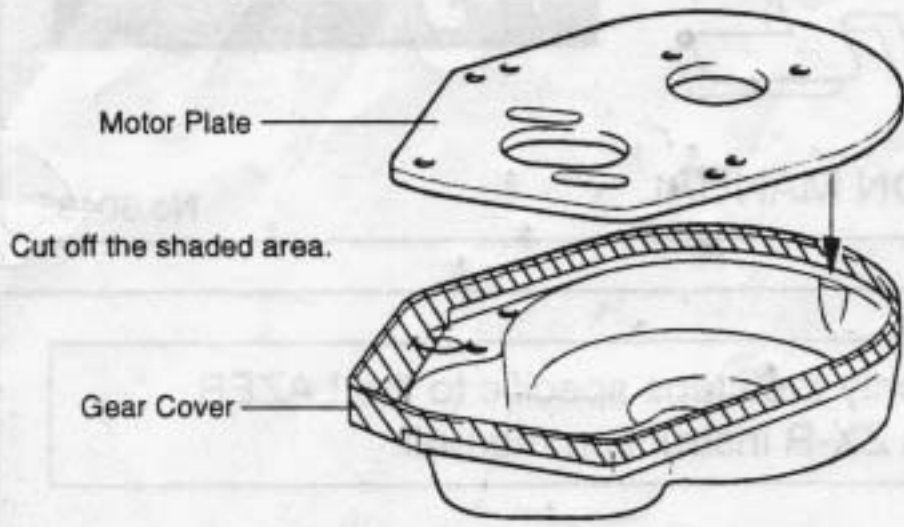

- 4** • Instead of 3mm nuts, tapered washers are used.  
Use Bag No.3

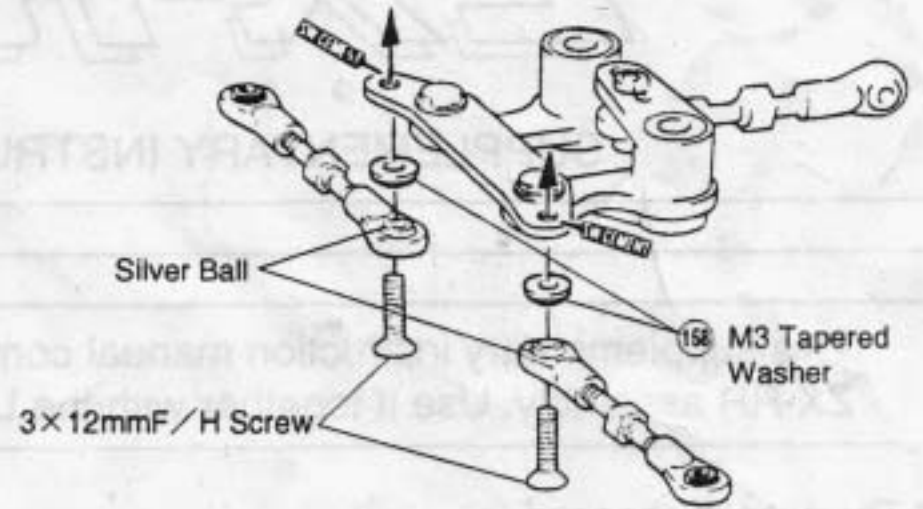

- 5** Use Bag No.4

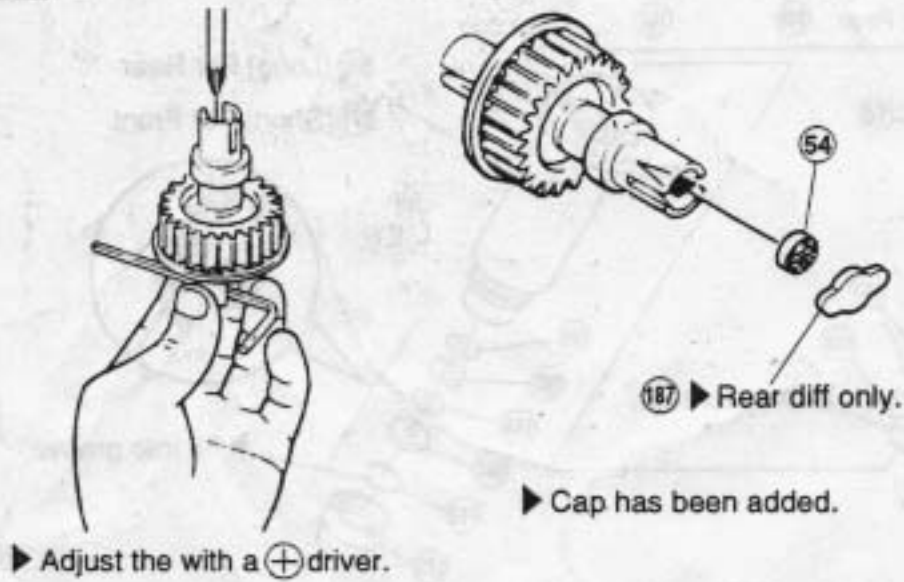

- 7** • The slipper clutch changed.  
Use Bag No.4

1

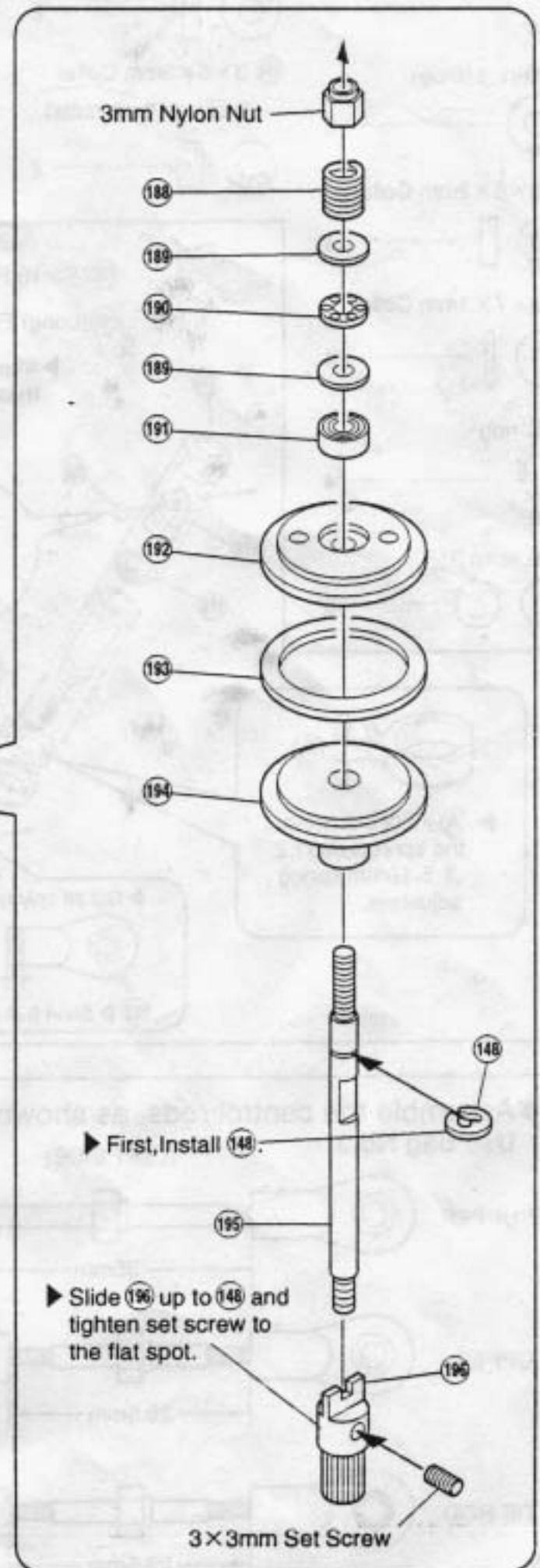

2

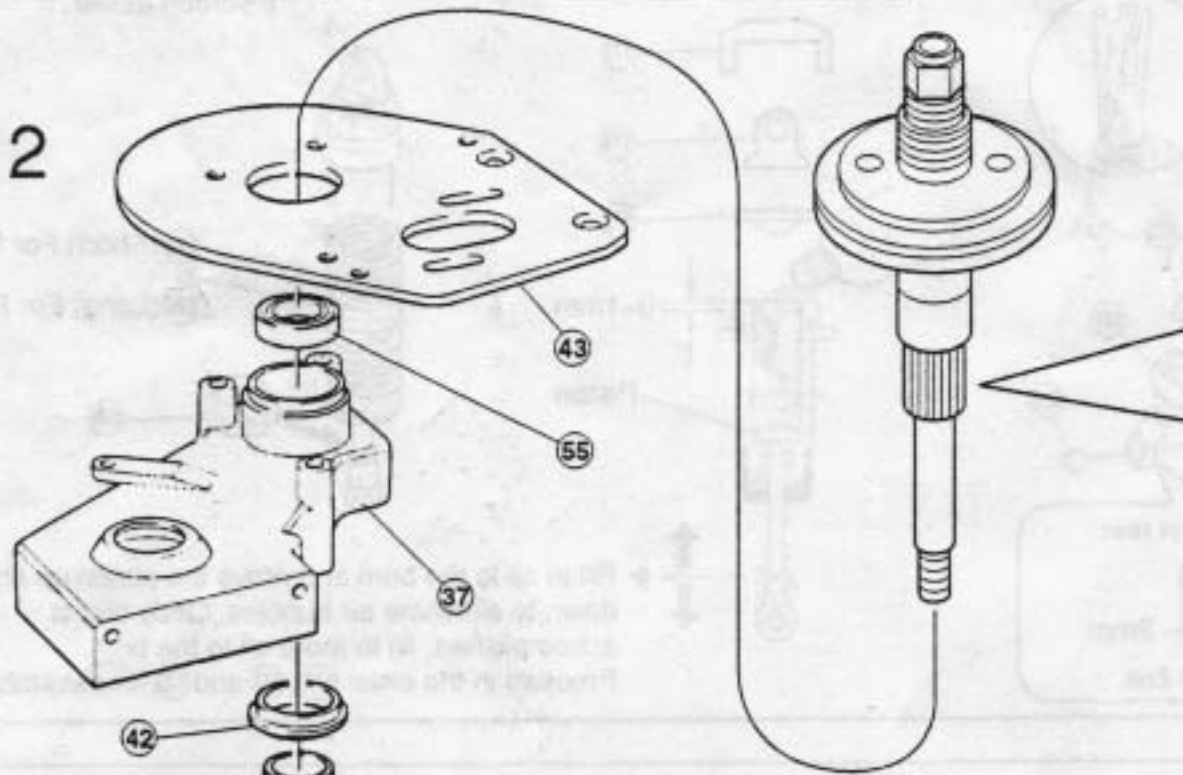

3

3x6mm Screw  
3mm Washer

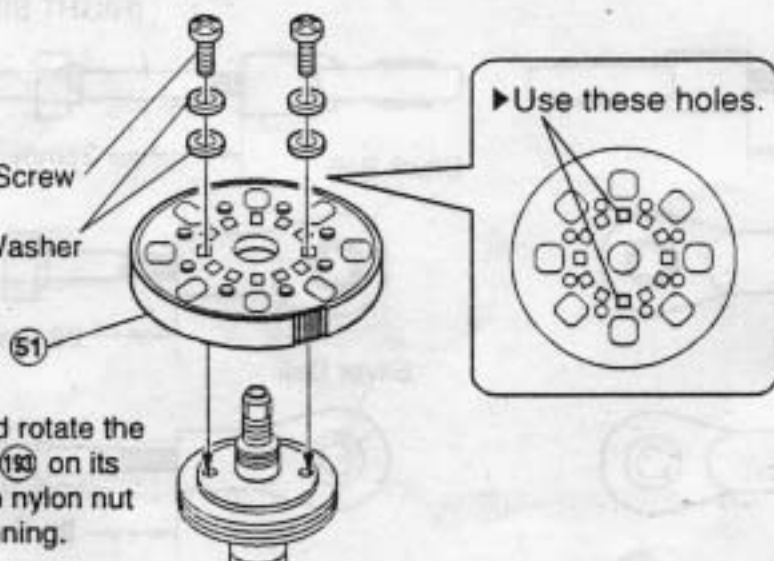

▶ Loosen the 3mm nylon nut and rotate the spur gear in order to help seat 190 on its both sides. Then, retighten the nylon nut and adjust the clutch while running.