

**ROADRUNNER**



**ROAR & NORRCA  
National  
Championships**

**XPERIENCES**

1:10 Touring Car Chassis Kit

# 1. [ ASSEMBLING DIFFERENTIAL GEAR ]

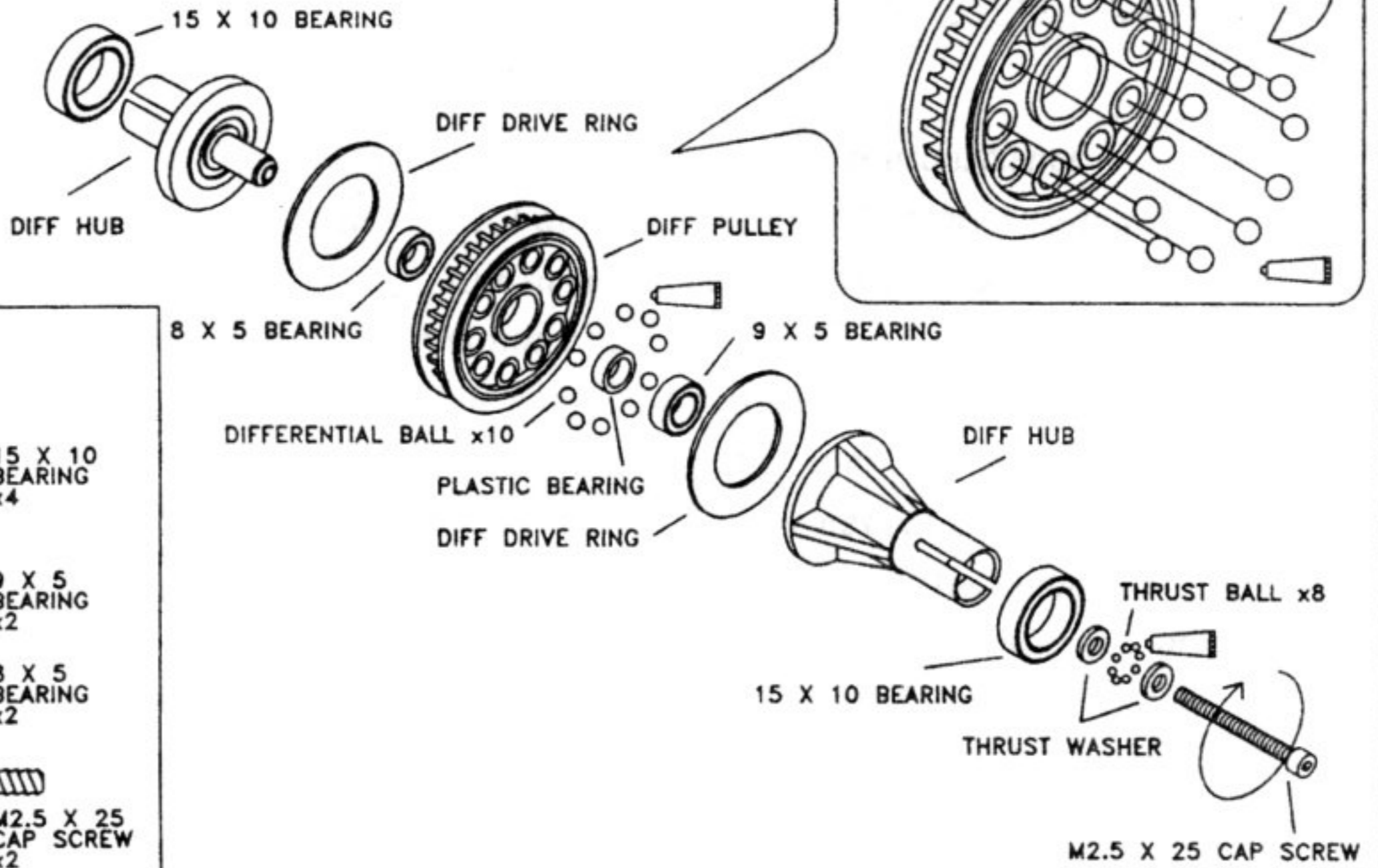

- BAG A-1**
- 15 X 10 BEARING x4
  - 9 X 5 BEARING x2
  - 8 X 5 BEARING x2
  - M2.5 X 25 CAP SCREW x2
- DIFF HUB (LEFT & RIGHT) x2  
 DIFF DRIVER RING x4  
 DIFF PULLEY x2  
 DIFFERENTIAL BALL x20  
 THRUST WASHER x4  
 THRUST BALL x16  
 PLASTIC BEARING x2

# 2. [ ASSEMBLING CENTER SHAFT ]

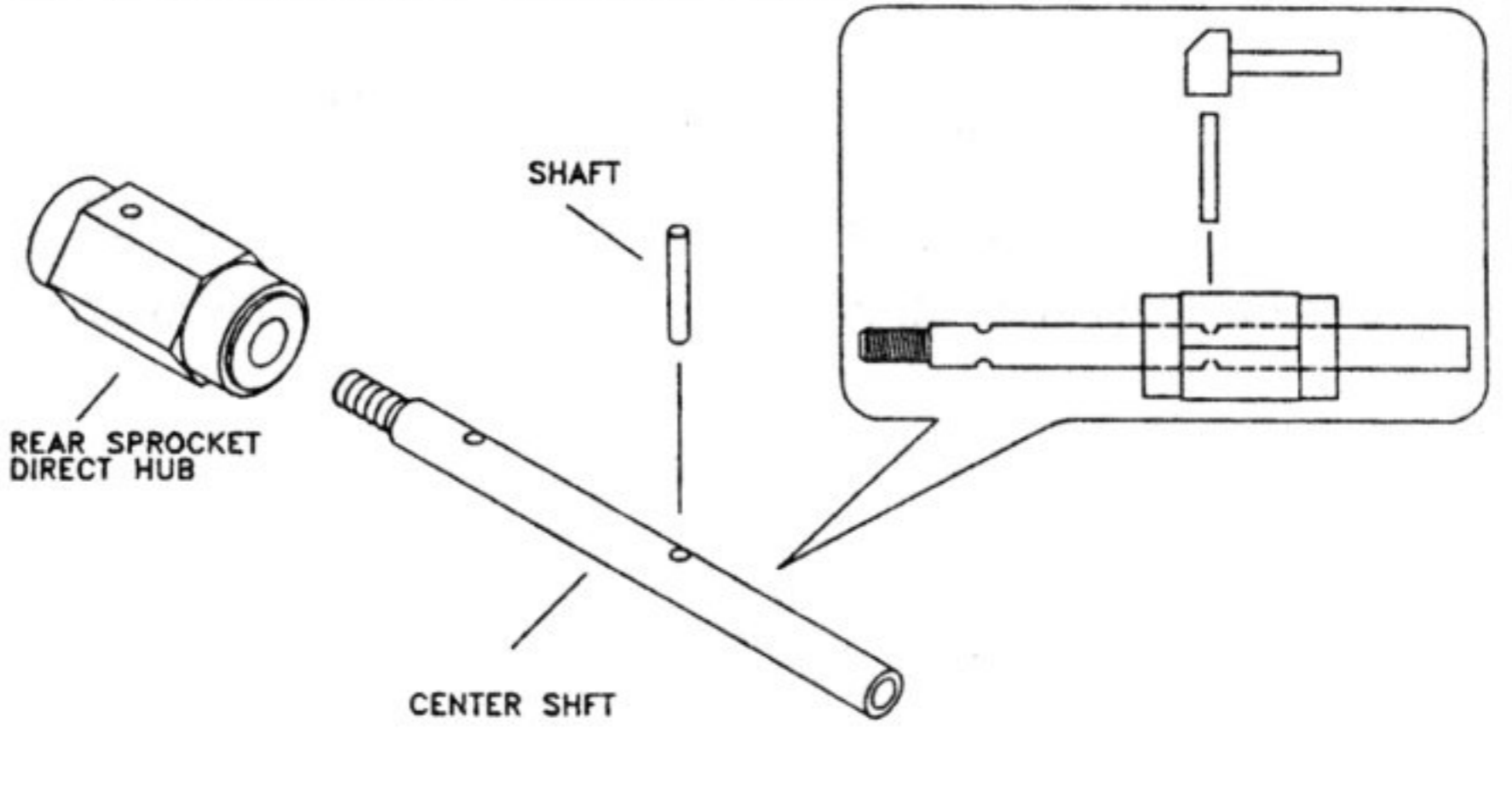

- BAG A-1**
- SPROCKET DIRECT HUB x1
  - SHAFT x1
- CENTER SHAFT x1

# 2.1 [ ASSEMBLING CENTER SHAFT ]

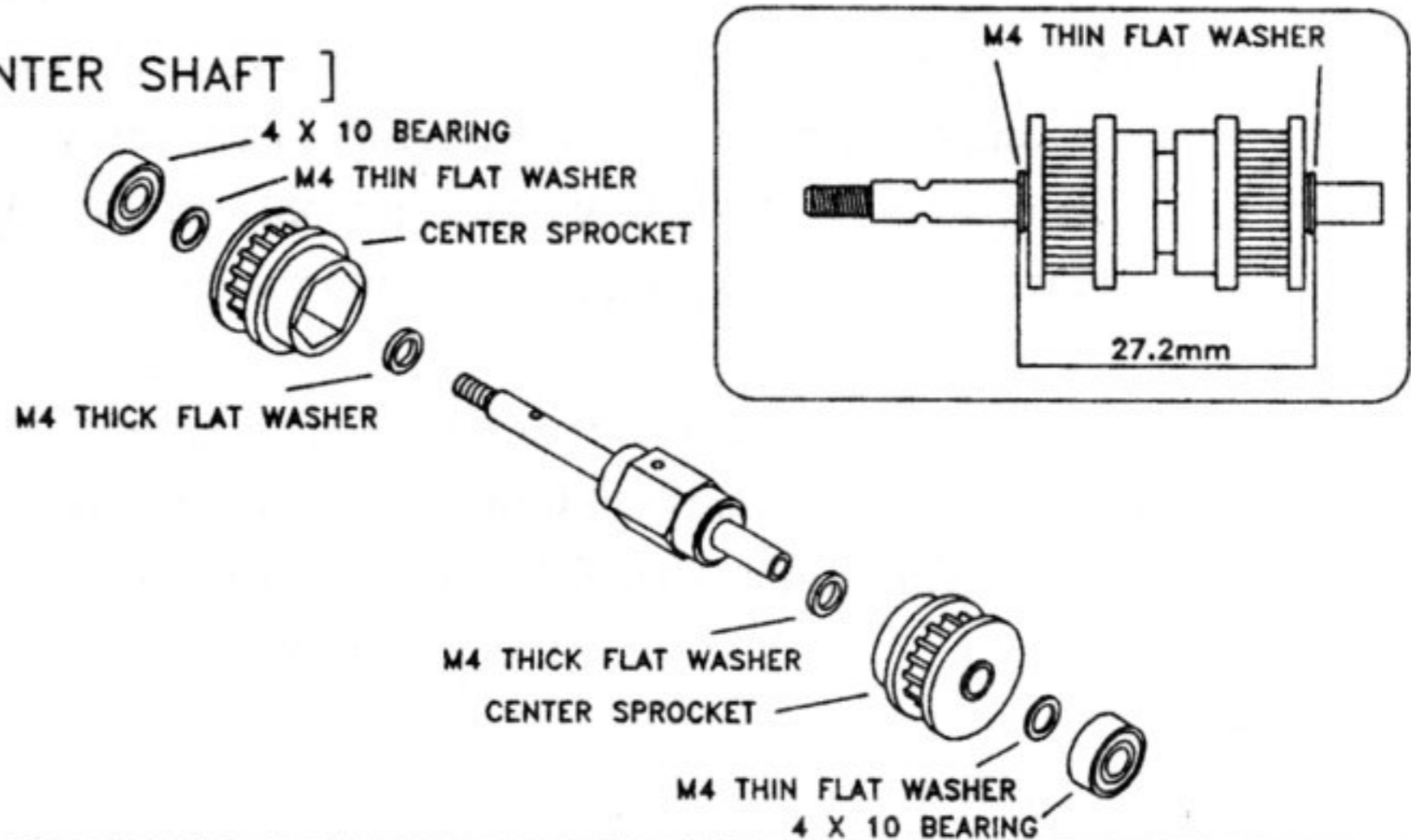

- BAG A-1**
- 4 X 10 BEARING x2
  - M4 THICK FLAT WASHER
  - M4 THIN FLAT WASHER
  - CENTER SPROCKET x2

### 3. [ MOUNTING CENTER SHAFT AND DIFF GEARS ]

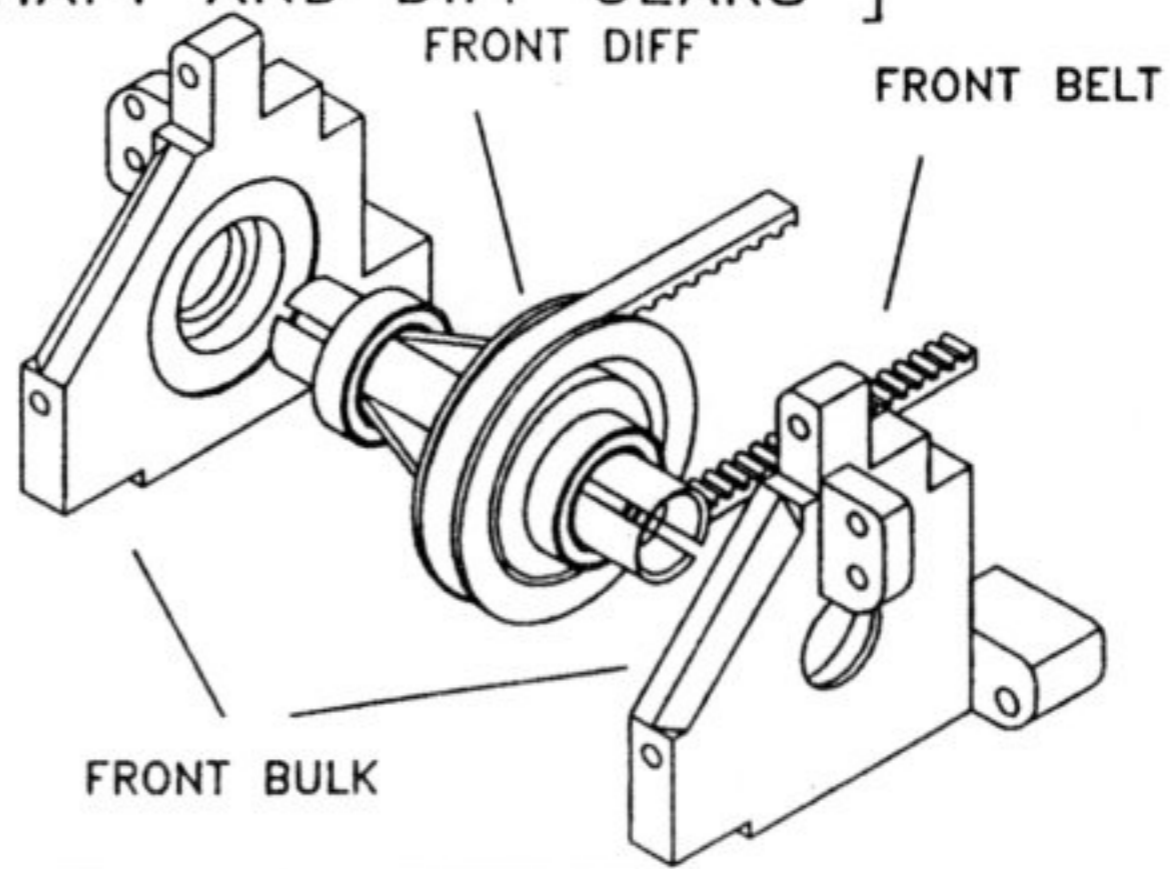

- BAG A-1**  
 FRONT BELT x1  
 FRONT BULK (LEFT & RIGHT) x1

### 3.1 [ MOUNTING CENTER SHAFT AND DIFF GEARS ]

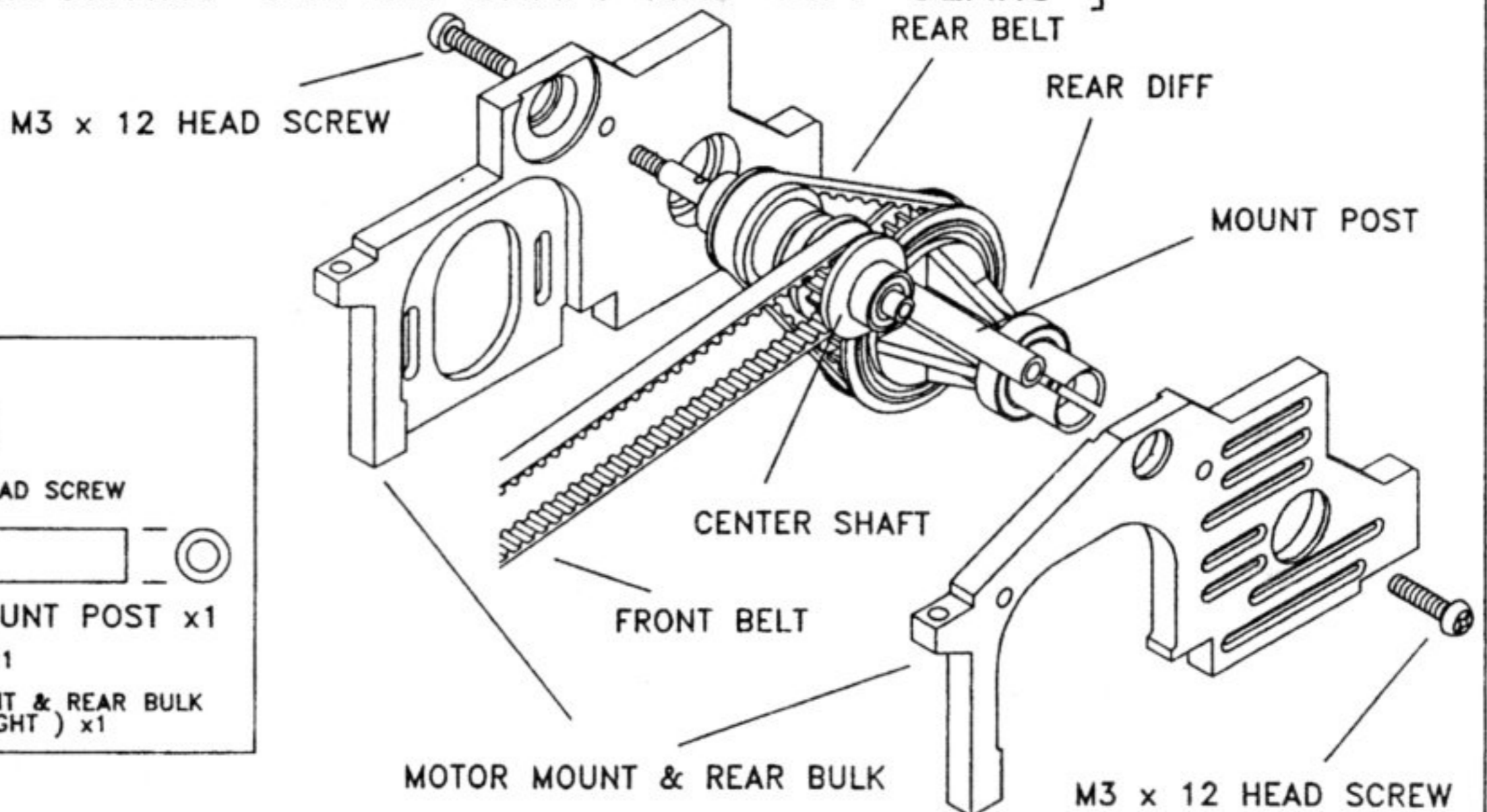

- BAG A-1**  
 M3 x 12 HEAD SCREW x2  
 MOUNT POST x1  
 REAR BELT x1  
 MOTOR MOUNT & REAR BULK (LEFT & RIGHT) x1

### 3.2 [ MOUNTING CENTER SHAFT AND DIFF GEARS ]

- BAG A-1**  
 REAR LOWER ARM HOLDER x1

- BAG A-2**  
 M3 x 8 TAPPING SCREW x 4  
 M3 x 10 SCREW x 6  
 M3 x 16 SCREW x 2  
 POST x 4

- MAIN CHASSIS** x1

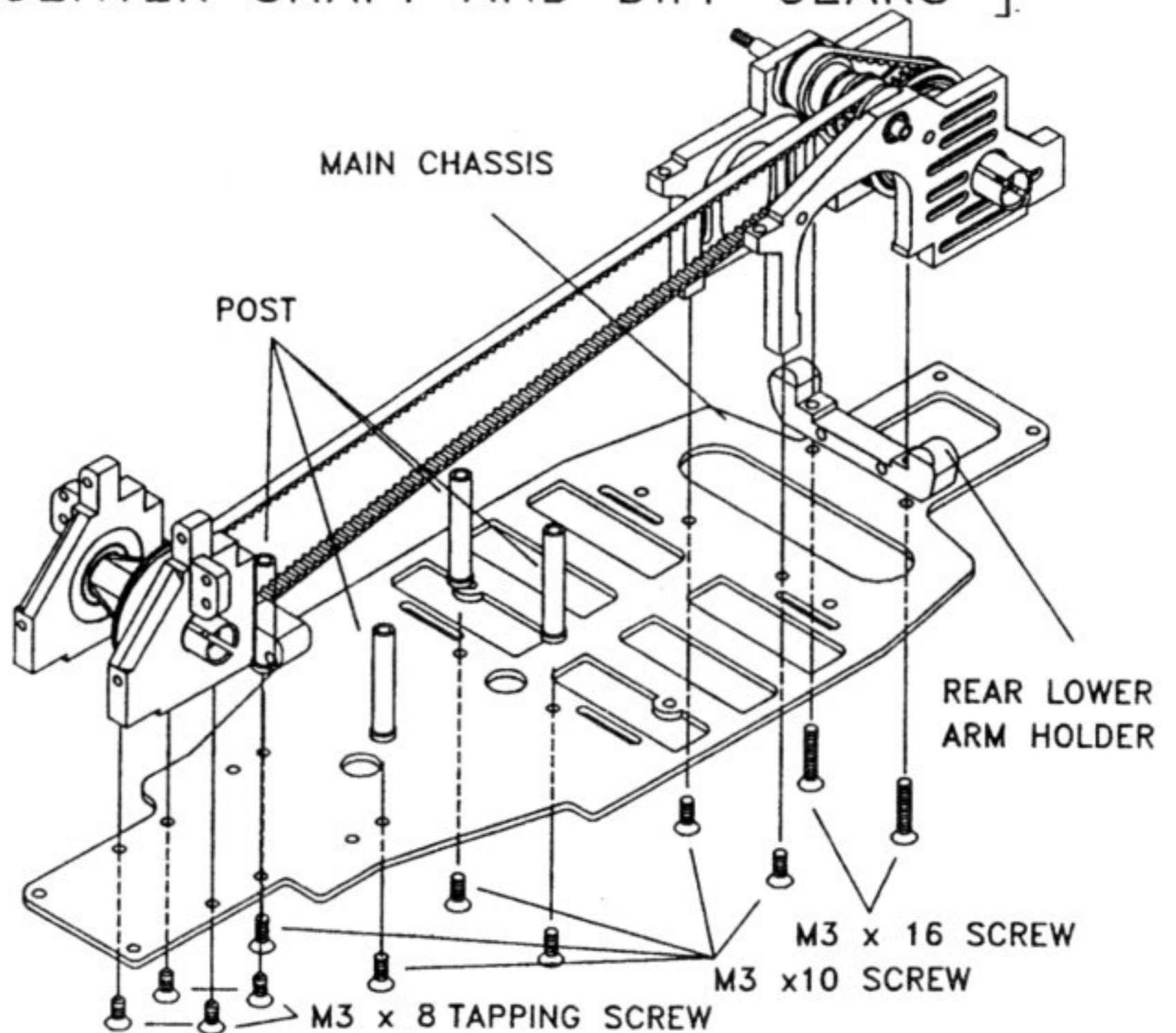

## 4. [ ASSEMBLING SPUR GEAR ]

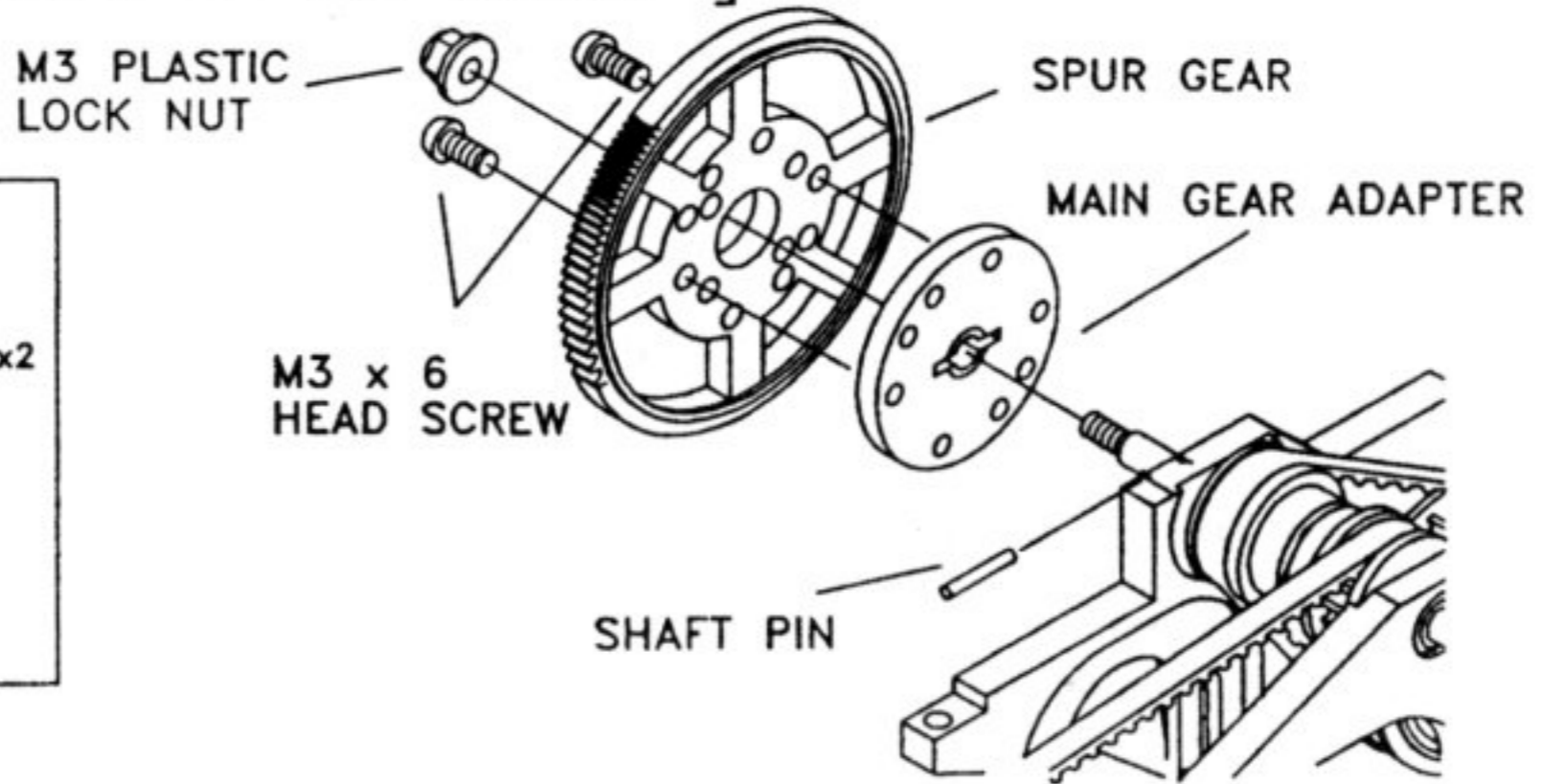

- BAG A-2**
-  M3 x 6 HEAD SCREW x2
  - M3 PLASTIC LOCK NUT x1
  - SPUR GEAR x1
  - MAIN GEAR ADAPTER x1
  - SHAFT PIN x1

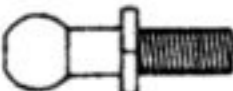

## 5. [ MOUNTING UPPER DECK ]

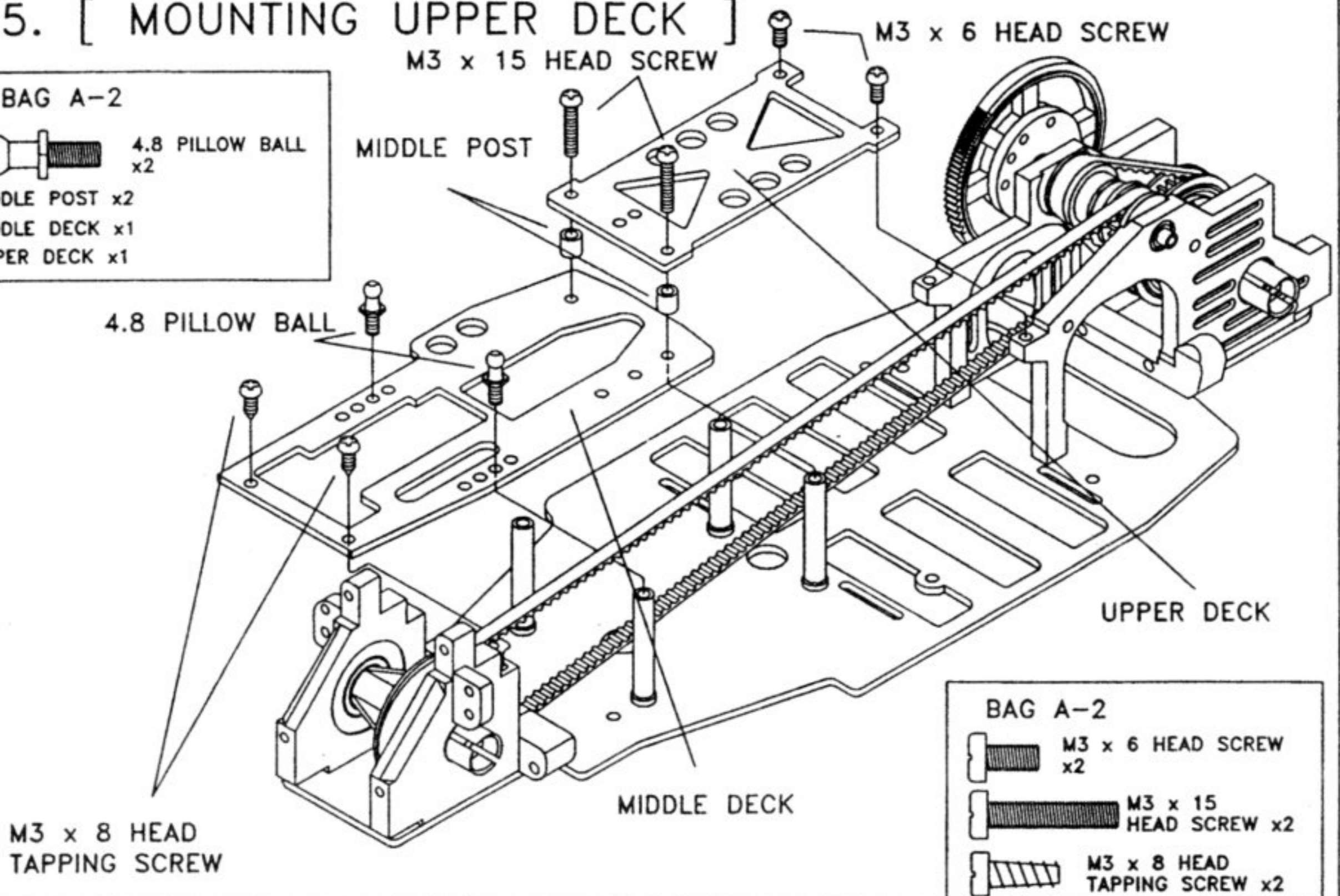
- BAG A-2**
-  4.8 PILLOW BALL x2
  - MIDDLE POST x2
  - MIDDLE DECK x1
  - UPPER DECK x1

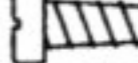

- BAG A-2**
-  M3 x 6 HEAD SCREW x2
  -  M3 x 15 HEAD SCREW x2
  -  M3 x 8 HEAD TAPPING SCREW x2

## 6. [ MOUNTING FRONT SHOCK TOWER ]

- BAG A-1**
-  M3 x 25 CAP SCREW x2
- BAG A-2**
-  M3 x 8 TAPPING SCREW x4
  - DAMPER HOLDER x2
  - M3 FLAT NUT x2
  - FRONT SHOCK TOWER x1
- BAG A-8**
- COLLAR x2

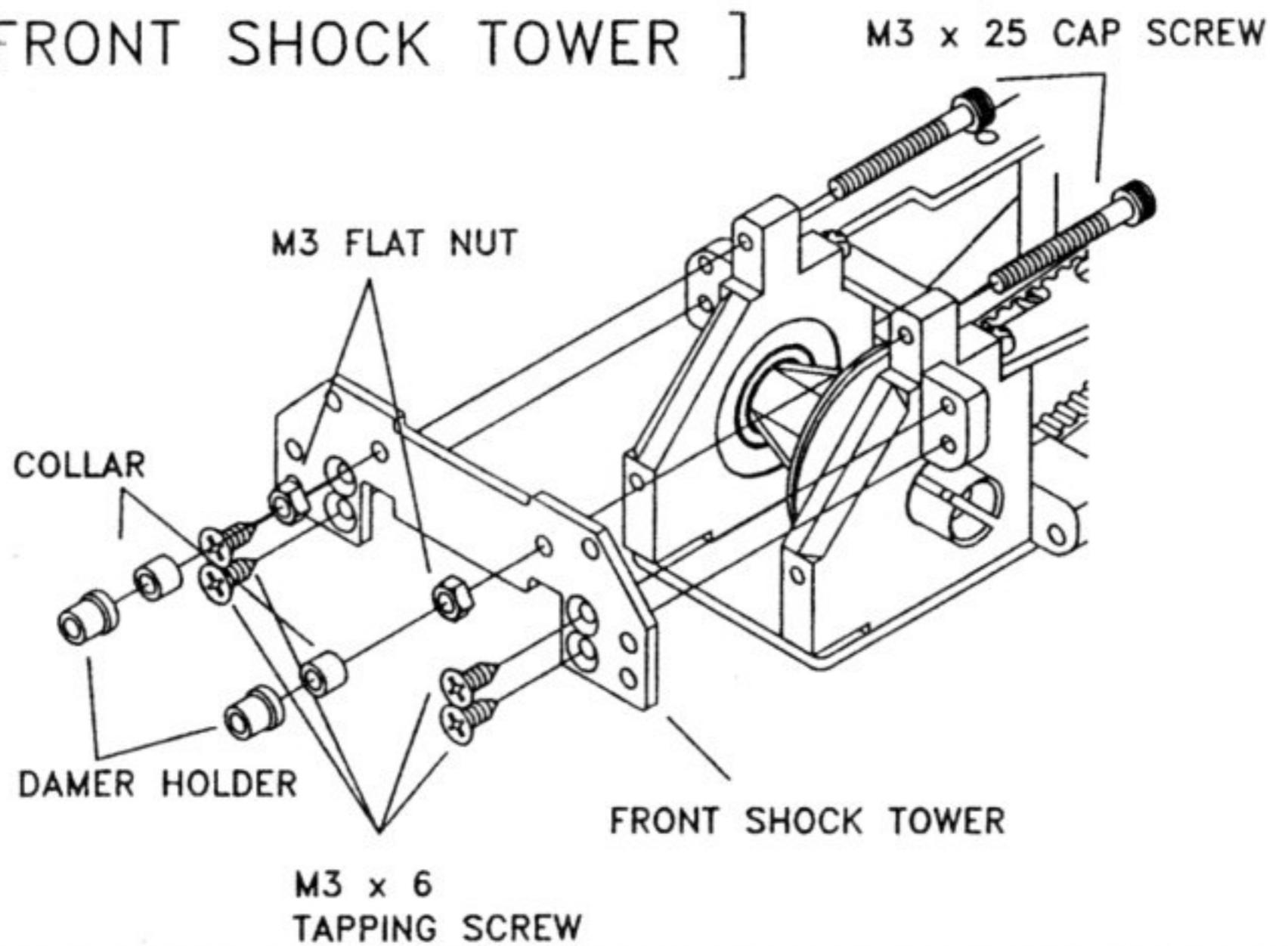

## 7. [ MOUNTING REAR SHOCK TOWER ]

BAG A-2	
	M3 x 6 HEAD SCREW x4
	M3 x 20 CAP SCREW x2
REAR SHOCK TOWER	
DAMPER HOLDER x2	
M3 FLAT NUT x2	
BAG A-8	
COLLAR x2	

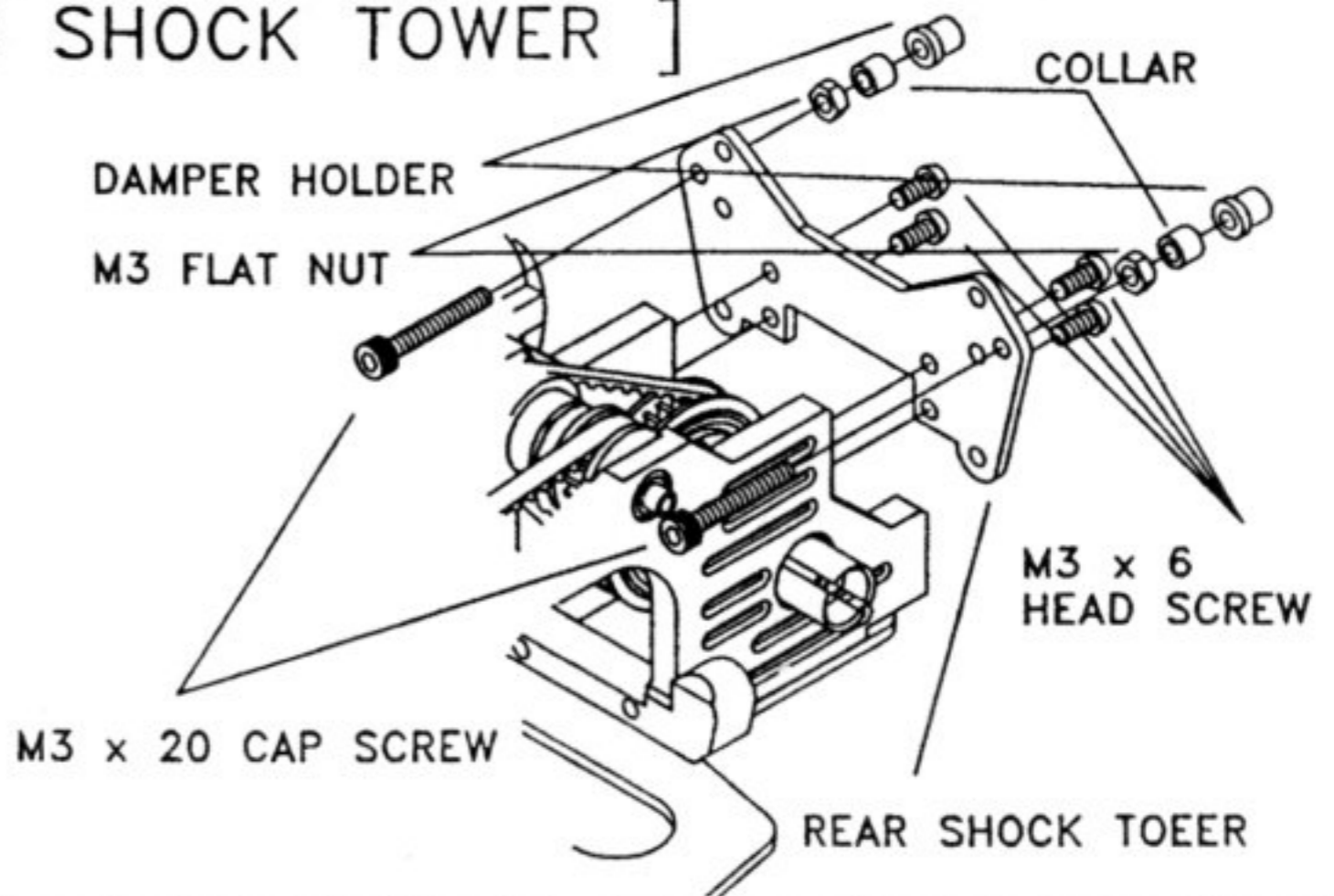

## 8. [ ASSEMBLING FRONT SUSPENSION ]

BAG A-3	
	4.8 PILLOW BALL x2
FRONT SUS-ARM x2	
BAG A-4	
	10 x 5 BEARING x4
	M3 x 16 KING-PIN SCREW x2
DRIVE SHAFT x2	
KNUCKLE x2	
5.8 BALL x2	
M2 E-RING x2	

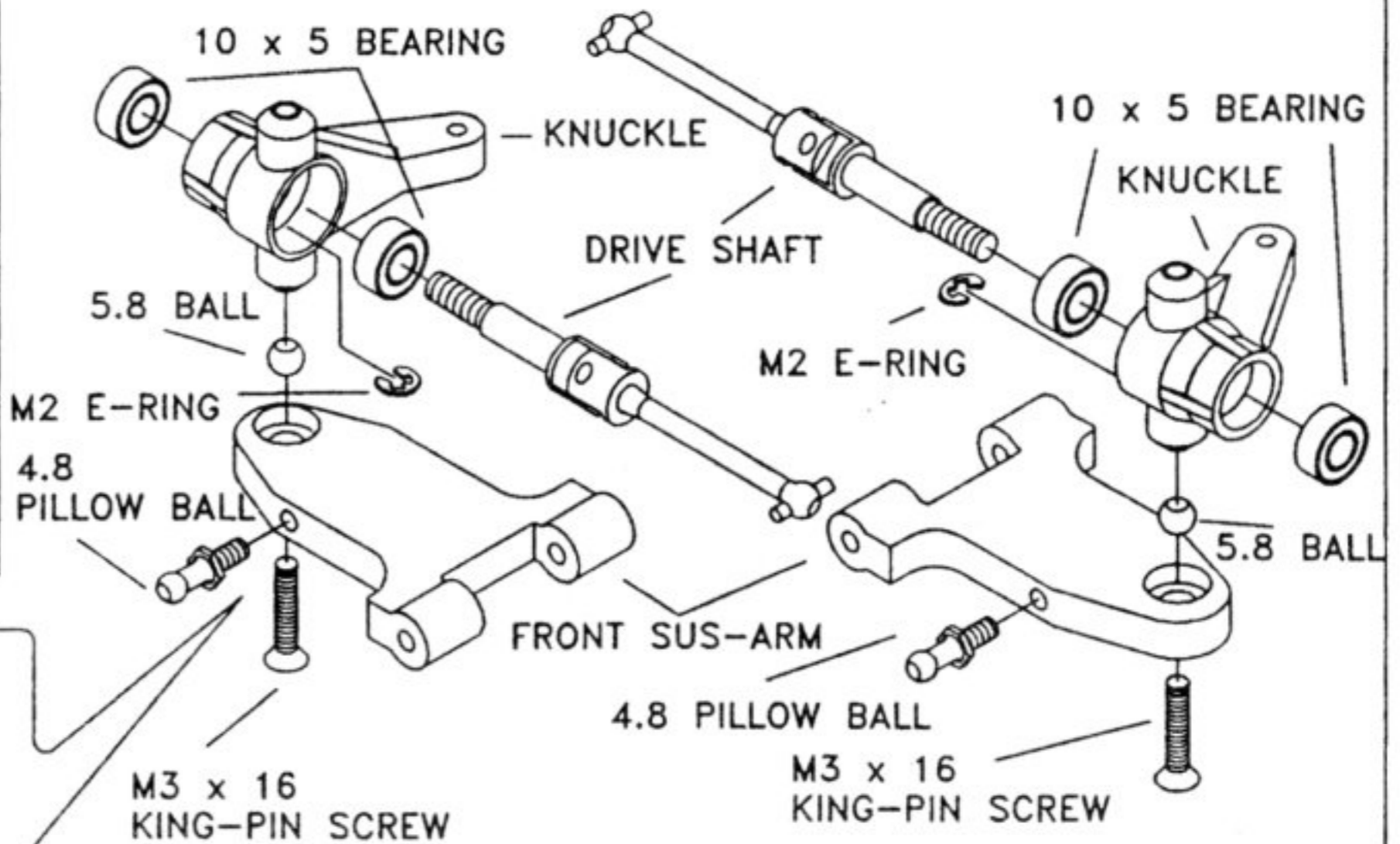
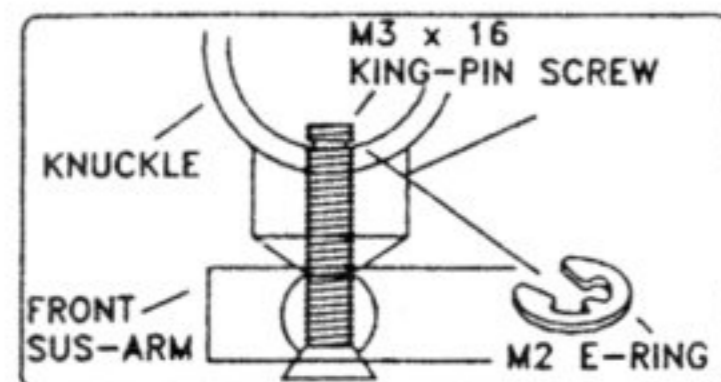

### 8.1 [ ASSEMBLING FRONT SUSPENSION ]

BAG A-4	
	M5 FLAT WASHER x2
	M3 x 12 HEAD SCREW x2
POST x2	
5.8 BALL x2	
PIVOT BALL x2	
18mm TURN BUCKLE x2	
35mm TURN BUCKLE x2	
UPPER ARM JOINT x2	
SET SCREW x2	

BAG A-7	
	PLASTIC BALL END CUP (A) x4
	PLASTIC BALL END CUP (B) x2
	PLASTIC BALL END CUP (C) x2

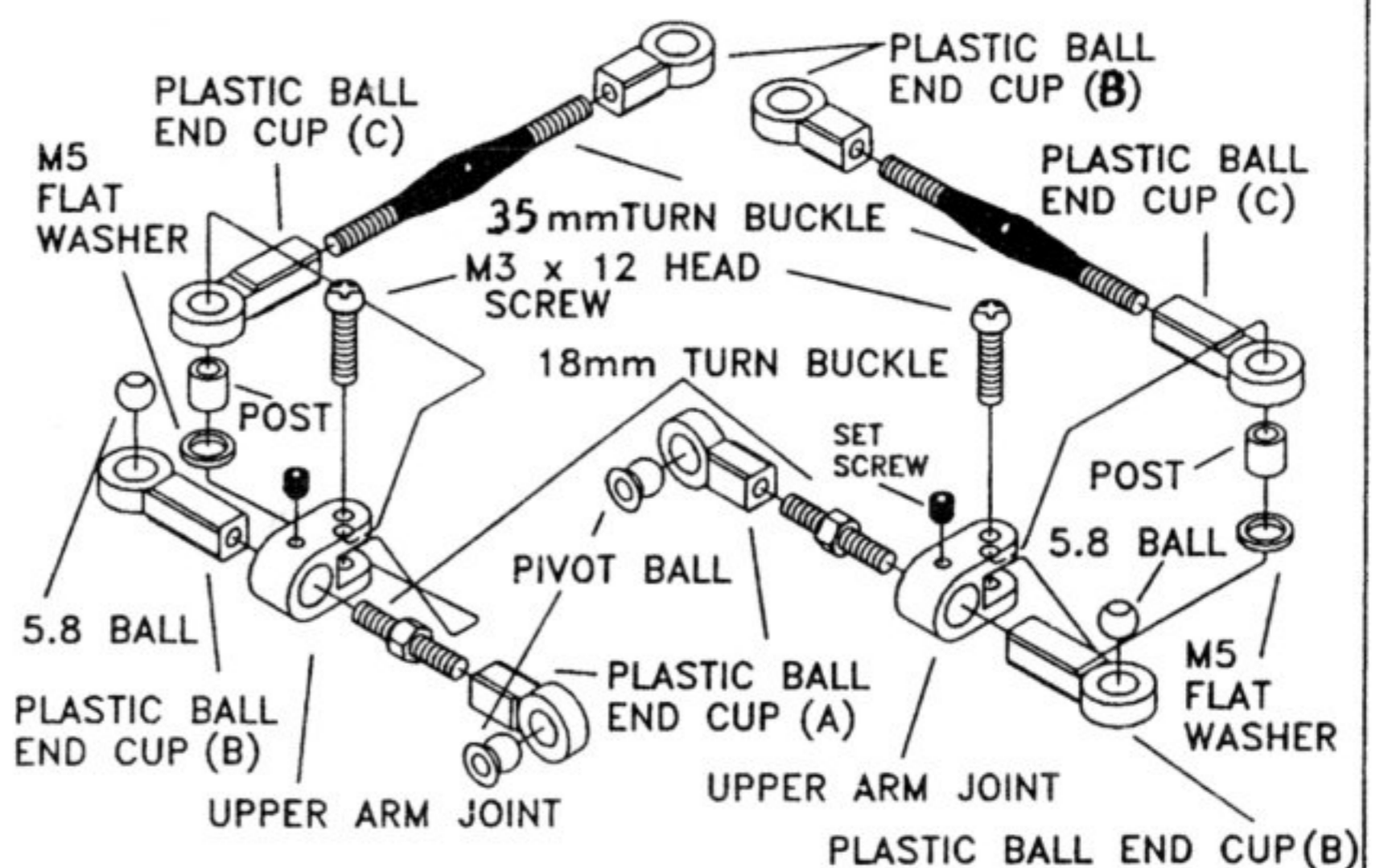

# 9. [ MOUNTING SUSPENSION FRONT ARMS ]

- BAG A-3**  
 M3 x 8 HEAD TAPPING SCREW x2  
 M3 x 12 TAPPING SCREW x2  
 FRONT BUMPER ARM SHAFT x2
- BAG A-4**  
 M3 x 16 KING-PIN SCREW x2  
 M3 x 12 SCREW x2  
 M3 FLAT NUT x2  
 M2 E-RING x2

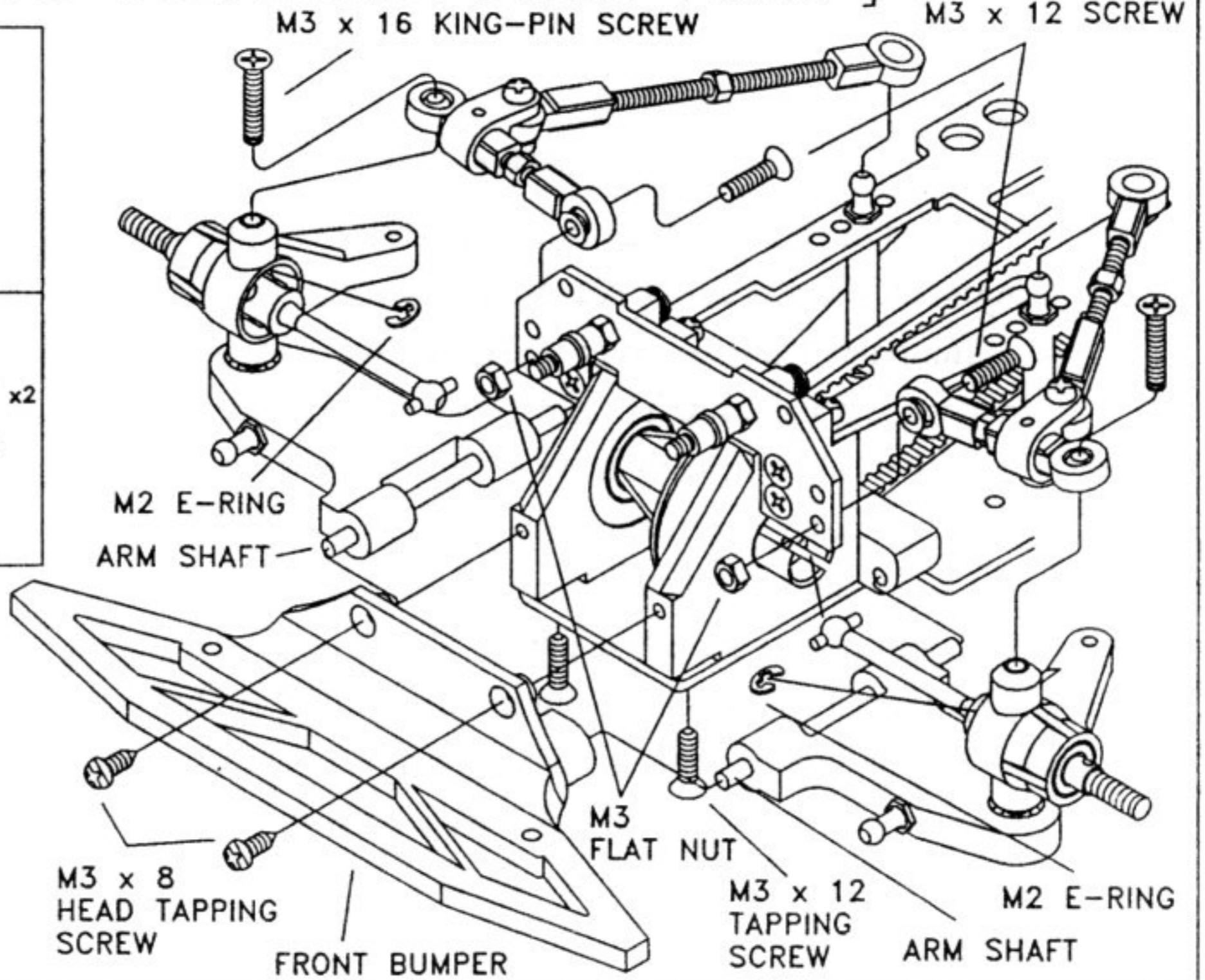

# 10. [ ASSEMBLING REAR SUSPENSION ]

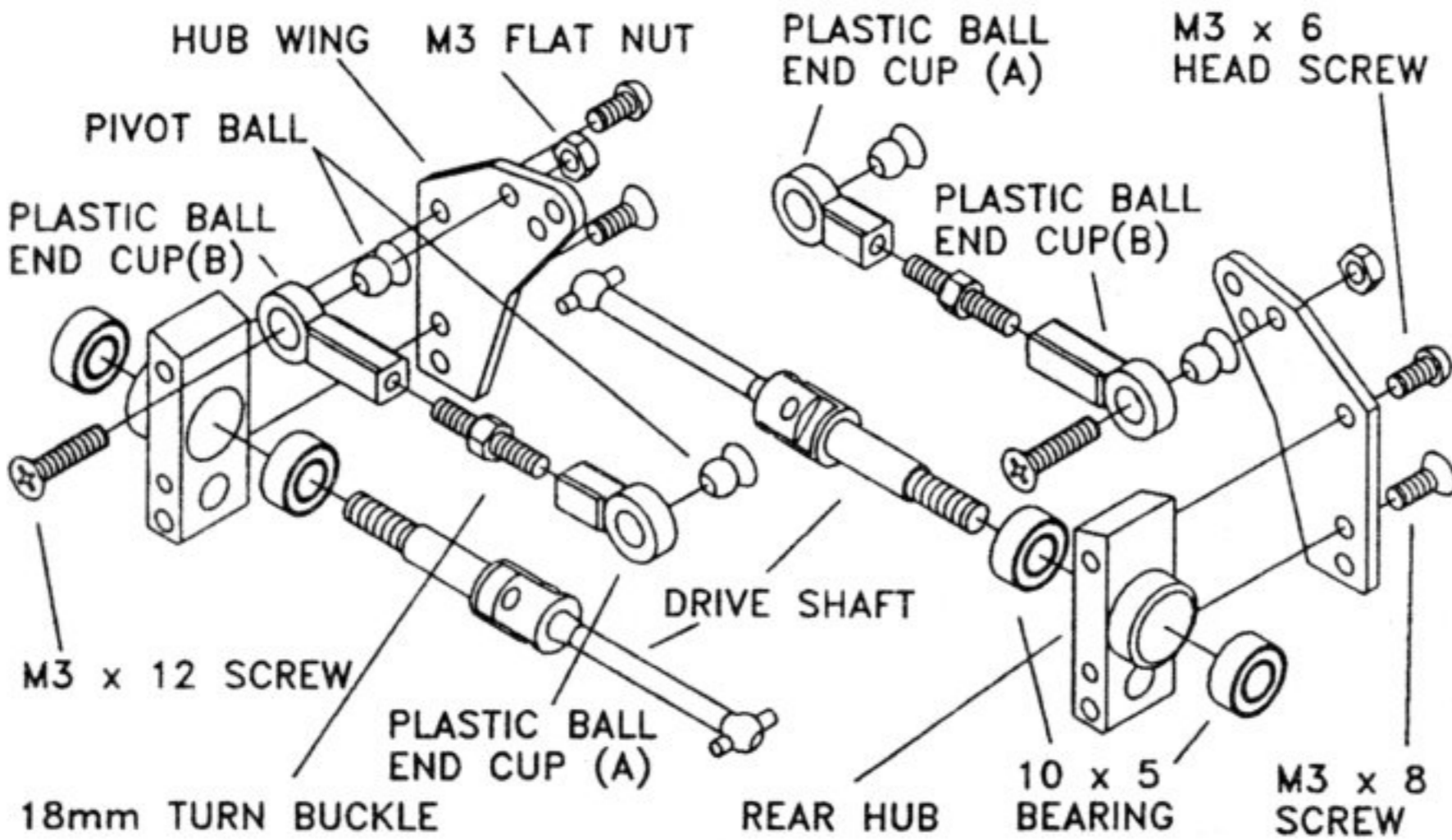

- BAG A-5**  
 M3 x 8 SCREW x2  
 M3 x 12 SCREW x2  
 M3 x 8 HEAD SCREW x2  
 10 x 5 BEARING x4  
 PIVOT BALL x4  
 DRIVE SHAFT x2  
 REAR HUB x2  
 M3 FLAT NUT x2  
 18mm TURN BUCKLE x2  
 HUB WING x2

- BAG A-7**  
 PLASTIC BALL END CUP (A) x2  
 PLASTIC BALL END CUP (B) x2

# 10.1 [ ASSEMBLING REAR SUSPENSION ]

- BAG A-3**  
 4.8 PILLOW BALL x2  
 REAR SUS-ARM x2
- BAG A-5**  
 HUB SHAFT x2  
 M2.5 E-RING x2

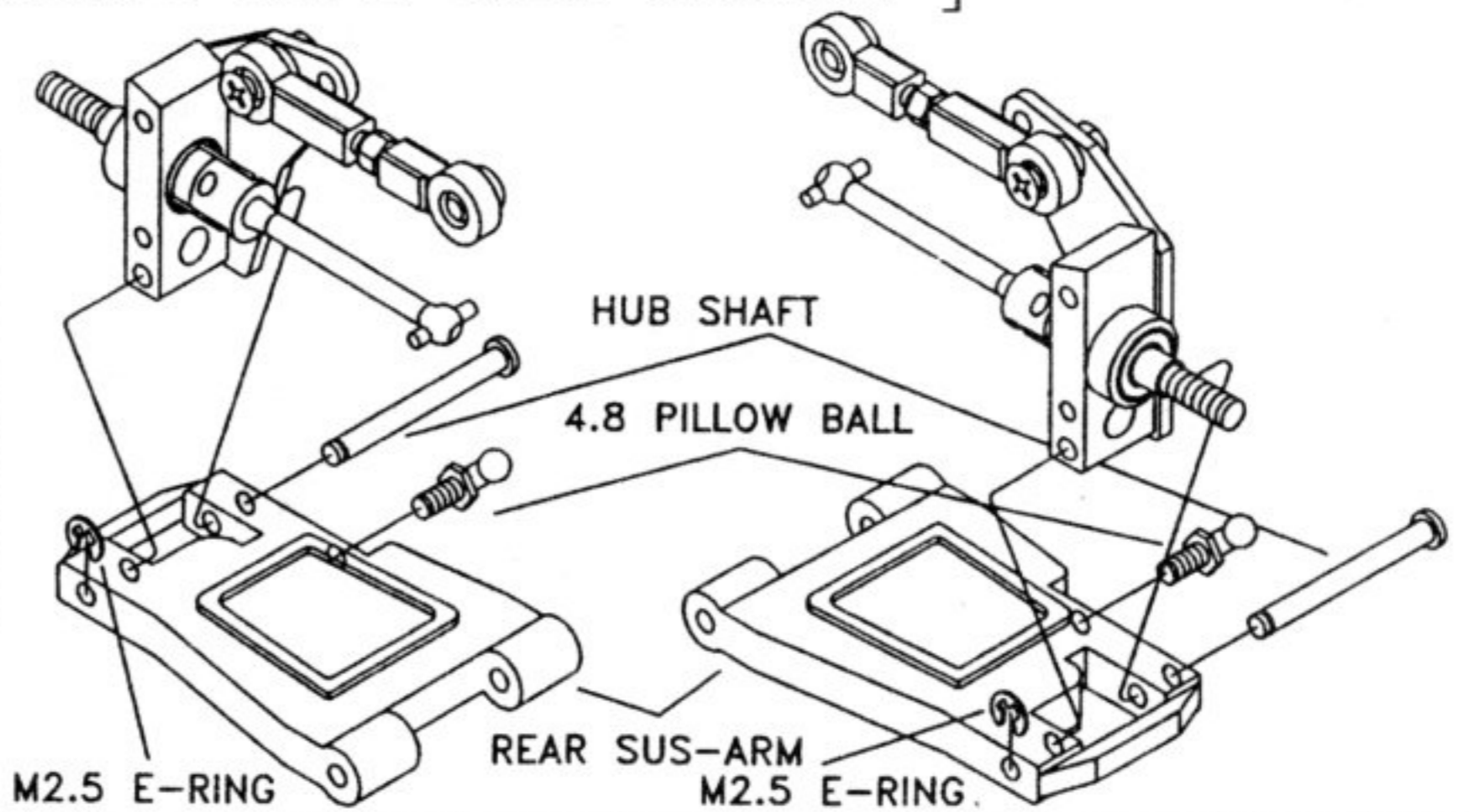

# 11. [ MOUNTING SUSPENSION REAR ARMS ]

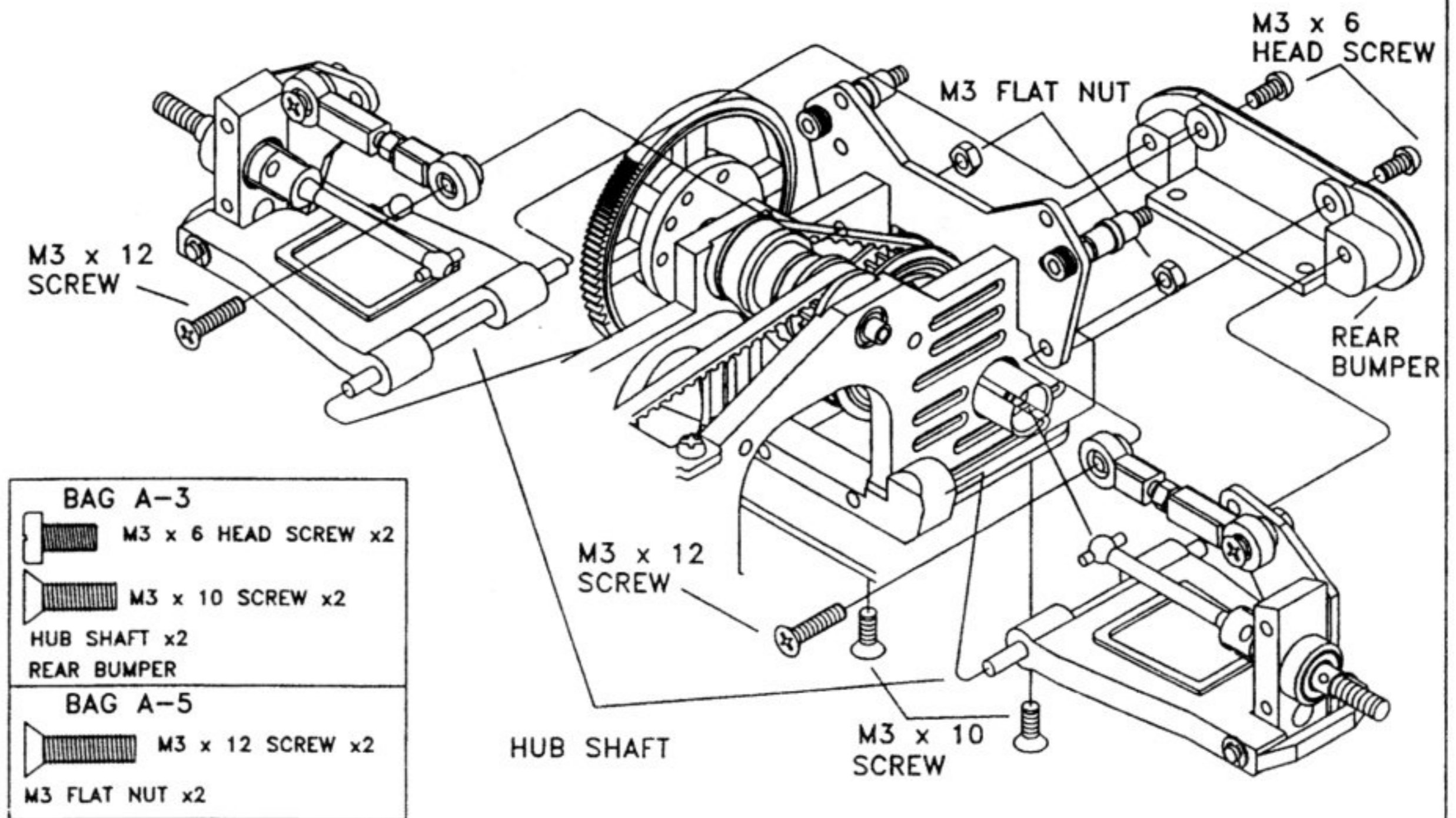

# 12. [ ASSEMBLING SHOCK ABSORBERS ]

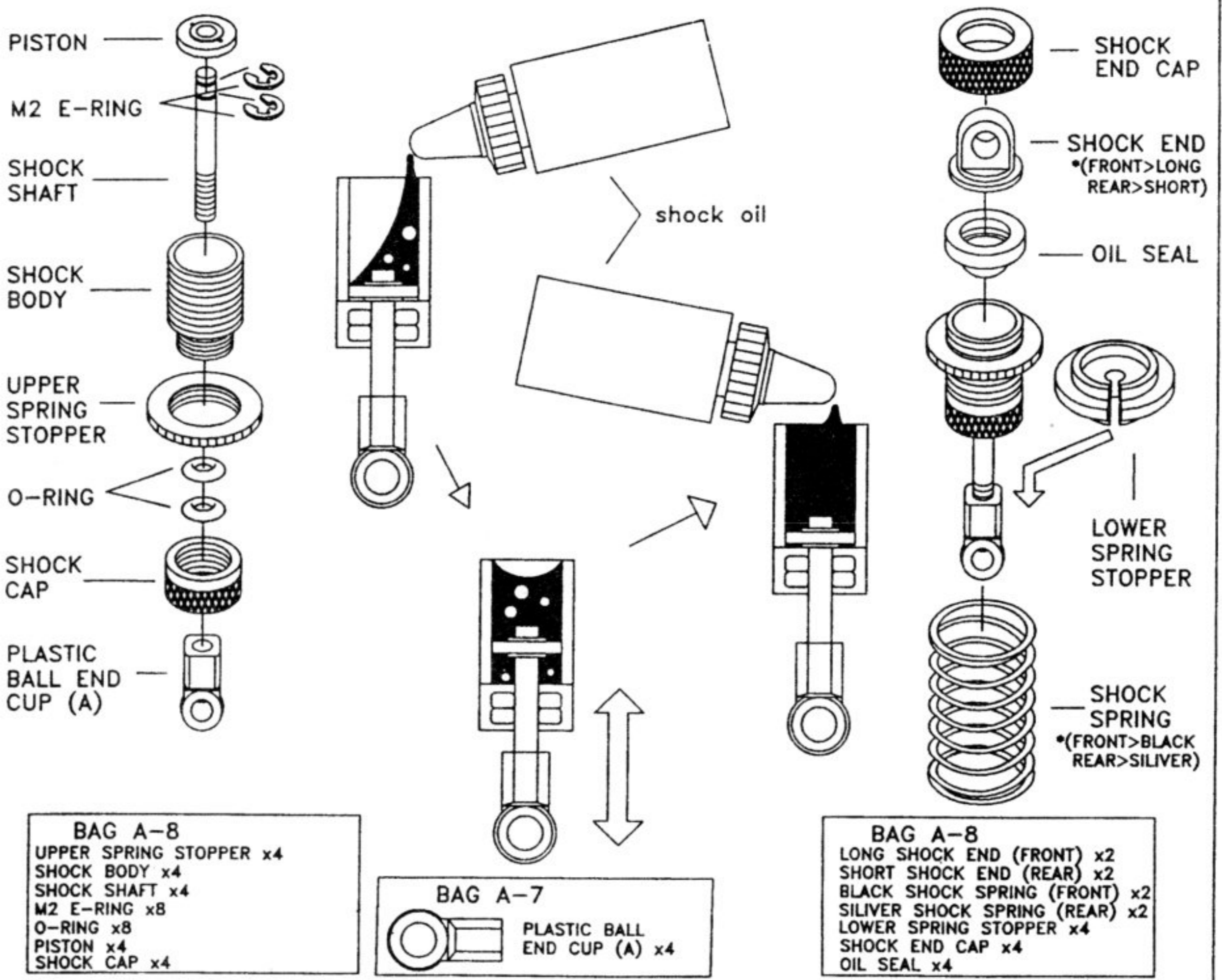

- BAG A-8**  
 UPPER SPRING STOPPER x4  
 SHOCK BODY x4  
 SHOCK SHAFT x4  
 M2 E-RING x8  
 O-RING x8  
 PISTON x4  
 SHOCK CAP x4

- BAG A-7**  
 PLASTIC BALL END CUP (A) x4

- BAG A-8**  
 LONG SHOCK END (FRONT) x2  
 SHORT SHOCK END (REAR) x2  
 BLACK SHOCK SPRING (FRONT) x2  
 SILVER SHOCK SPRING (REAR) x2  
 LOWER SPRING STOPPER x4  
 SHOCK END CAP x4  
 OIL SEAL x4

# 13. [ MOUNTING SHOCK ABSORBERS & OTHER ]

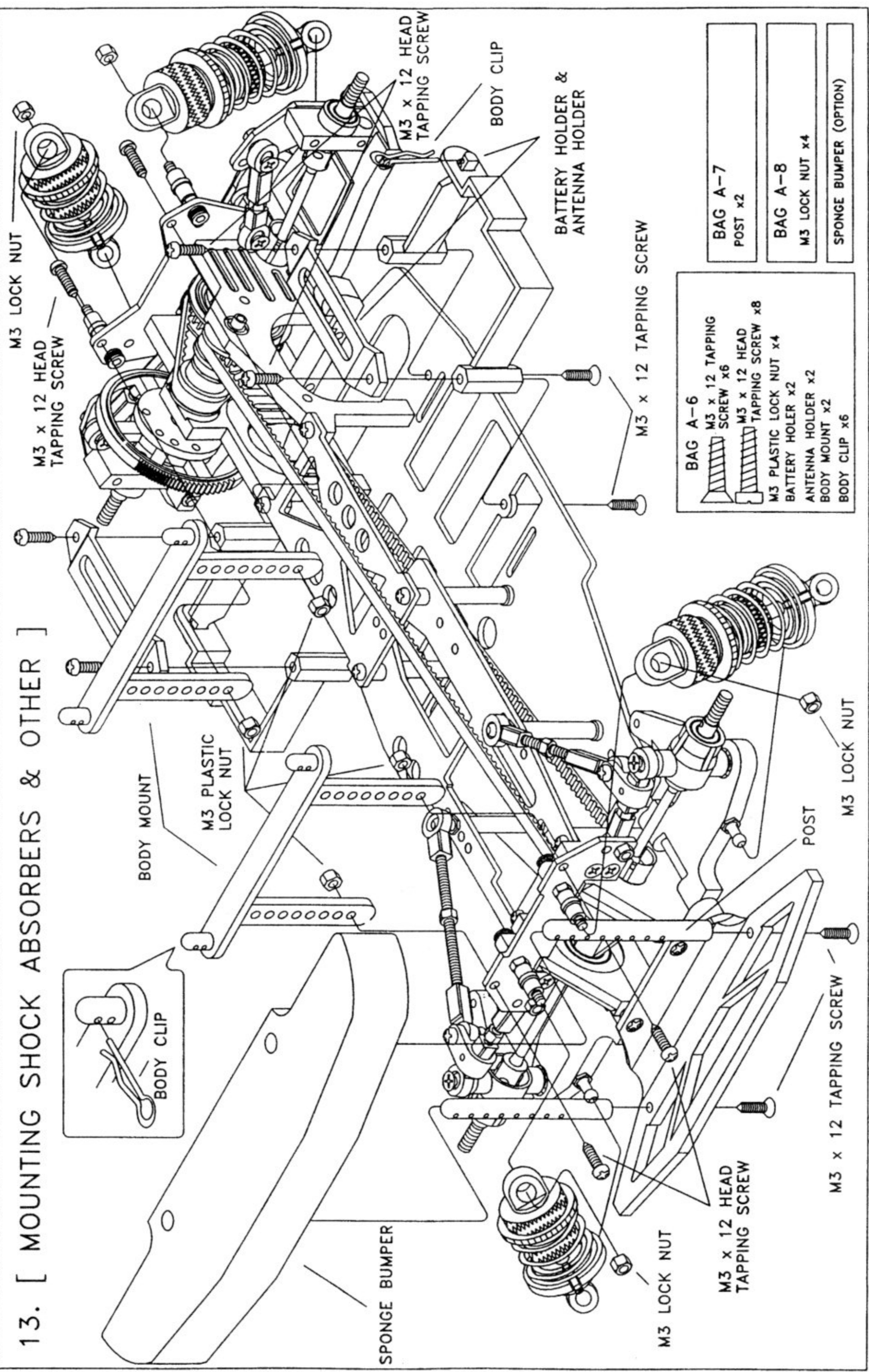

- |                               |                        |
|-------------------------------|------------------------|
| <b>BAG A-6</b>                | <b>BAG A-7</b>         |
| M3 x 12 TAPPING SCREW x6      | POST x2                |
| M3 x 12 HEAD TAPPING SCREW x8 | <b>BAG A-8</b>         |
| M3 PLASTIC LOCK NUT x4        | M3 LOCK NUT x4         |
| BATTERY HOLDER x2             | SPONGE BUMPER (OPTION) |
| ANTENNA HOLDER x2             |                        |
| BODY MOUNT x2                 |                        |
| BODY CLIP x6                  |                        |

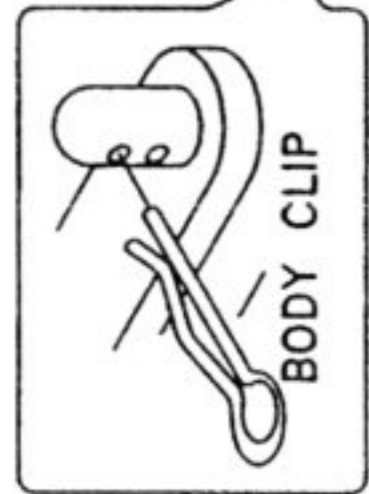

# 14. [ RADIO SYSTEM ]

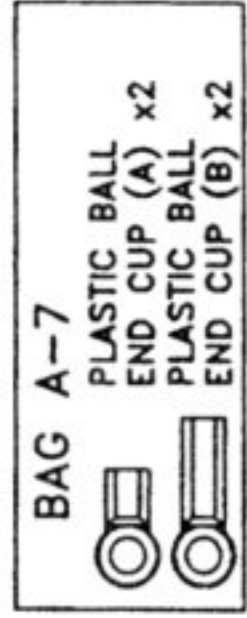
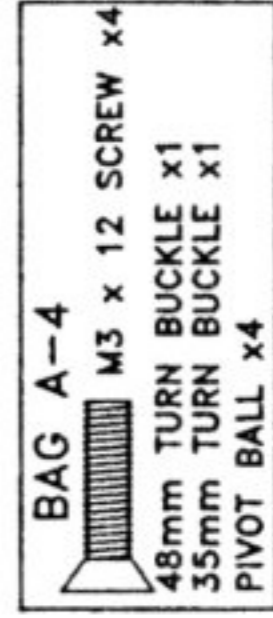
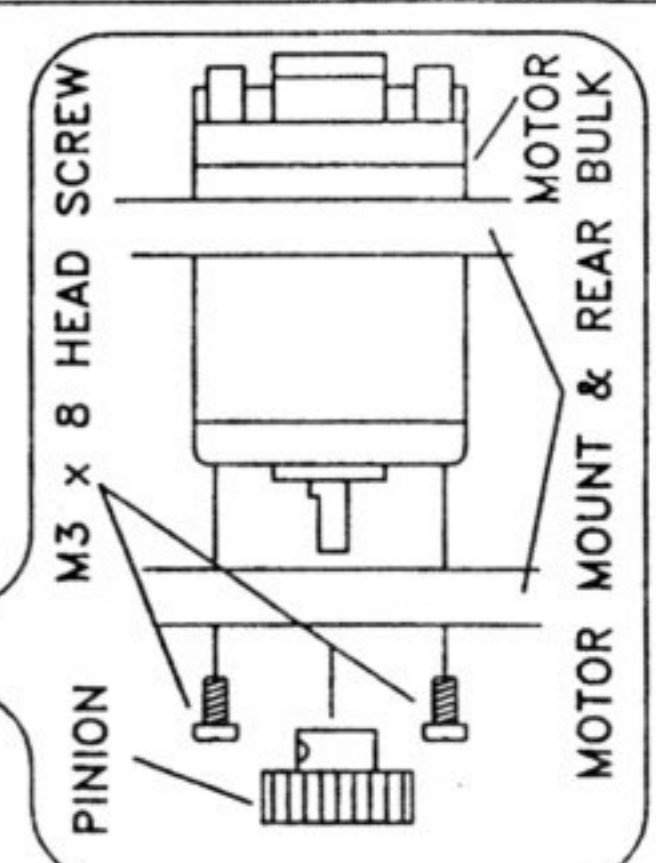
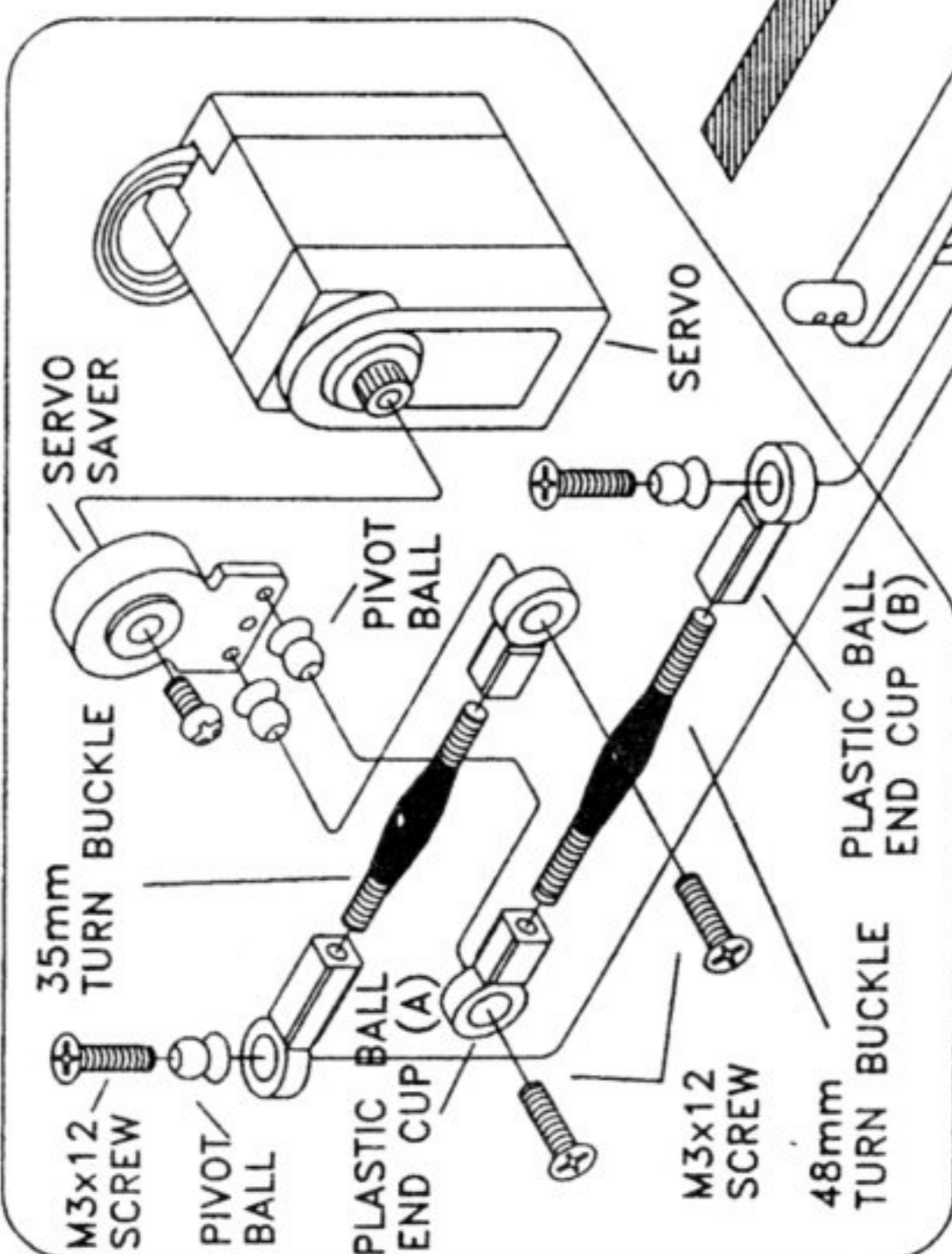
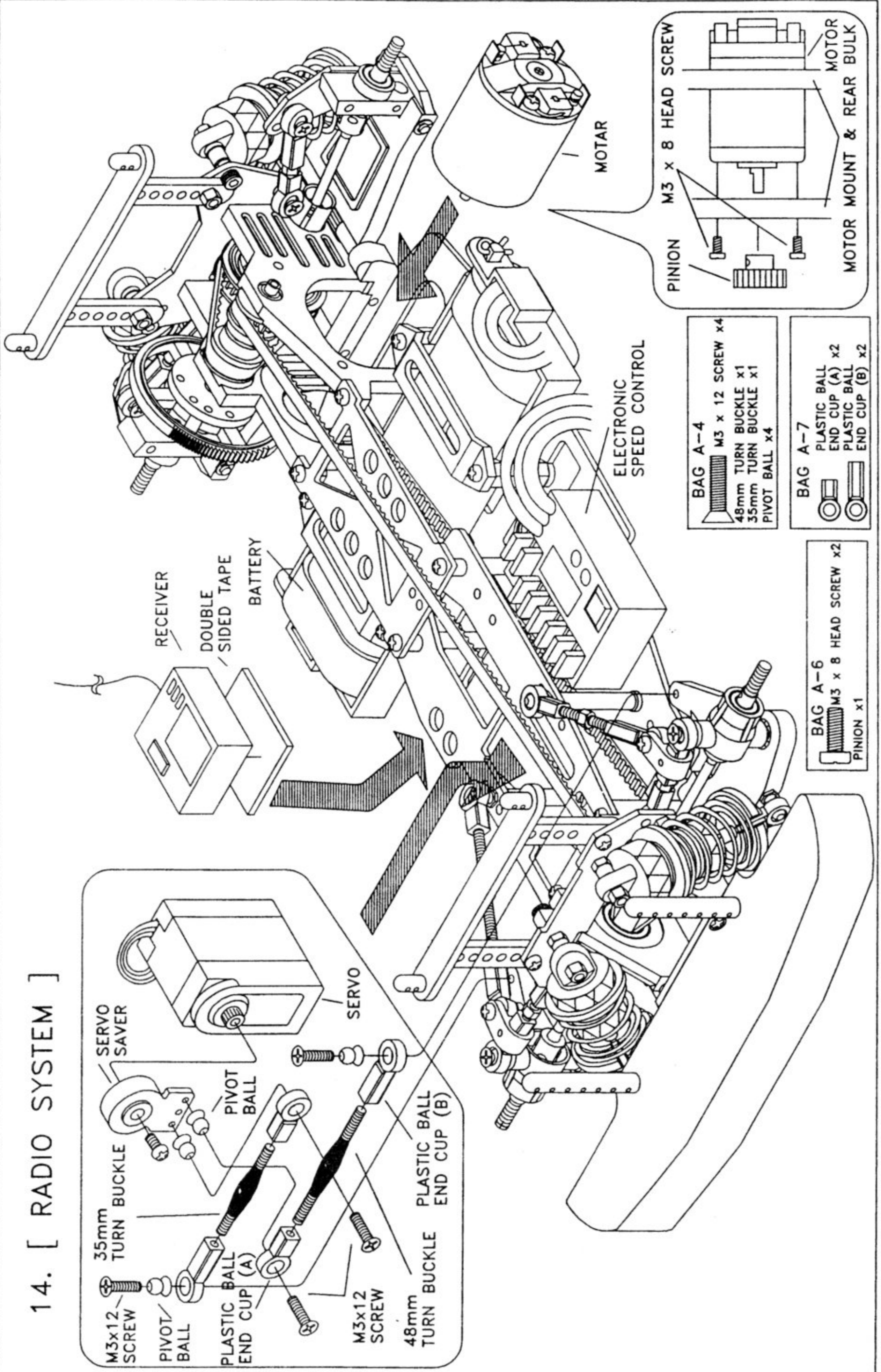

# 15. [ ASSEMBLING AND MOUNTING TIRE ]

