

RADIO CONTROLLED .21ENGINE POWERED OFF-ROAD RECREATION VEHICLE
CAR CRUSHER

USA-1 NITRO CRUSHER



- REALISTIC SCALE MODEL OF EVERETT W. JASMER'S "USA-1" MONSTER TRUCK, THE MOST POWERFUL IN THE WORLD.
- SCALE CAR-CRUSHER PERFORMANCE WITH REAL ENGINE POWER AND SOUND.
- HUGE 6.5 INCH (165mm) TIRES CLIMB OVER HIGH OBSTACLES AND COPE WITH ROUGH TRACKS.
HIGH-GRIP TREAD PATTERN FOR TOP TRACTION.
- LING-TRAVEL ALL-INDEPENDENT SUSPENSION WITH DOUBLE WISHBONES AND DUAL SHOCKS TO SOAK UP THE BUMPS AND KEEP CONTROL.
- MANY REALISTIC CHROME, NO "A" - FINISH PARTS AND DECORATIVE SELF-ADHESIVE LOGO DECALS FOR SCALE APPEARANCE.
- TWO-CHANNEL W/TWO SERVOS, 21 SIZE ENGINE, RADIO CONTROL SET (NOT INCLUDED)



KYOSHO
THE FINEST RADIO CONTROL MODELS

◀ KIT NO.3241 ▶

BEFORE ASSEMBLY

- Read the instruction carefully.

You can assemble the kit more easily, if you have grasped the general idea of steps and structure beforehand by reading it through to the end.



- Check the parts in the kit.

Check to see if all the parts are correctly bagged as they are listed in the "Bagged Parts List" (page 3, 4). Your thorough understanding of the assembly will enable you to build the kit without any difficulty.

Check the components in the kit prior to your startings of the assembly.



Any claims for replacements or refunds for the model in the process of assembly will not be accepted.

- Learn the marks described in the instruction.

LOCKTITE --- Place to put some locktite,
(It will prevent the screws and nuts to get loosen by vibration while running.)

GREASE -----Point where grease should applied,
(It will reduce friction and assure smooth movements.)



- Be well aware of the different types of screws.

1) The difference between the TP Screw (short form of self-tapping screw) and the ordinary screw is...

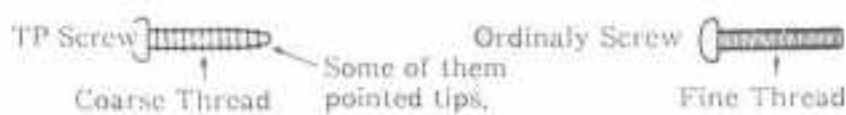

2) The kinds of screws which will be used in this instruction.



- Pick up the correct parts and screw. Compare the shape and size of small parts, such as screws, nuts, and washers.

- Be sure about the location and direction of parts to install.

Double-check the location and direction of parts with the illustration before installation. When necessary, assemble the parts themselves tentatively before proceeding to the next step.

- Do not tighten the self-tapping screw too tight.

Do not use excessive force when tightening the self-tapping screws, or you may strip the thread in the plastic. It is recommended to stop tightening it when the thread part on the screw goes into the plastic part and you feel some resistance from the tightening.



Over tighten may strip the thread in the plastic.

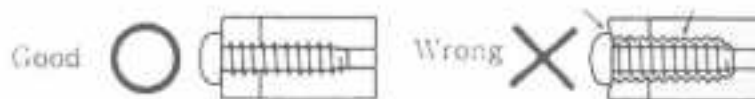

THINGS NEED BESIDES THE KIT

< 2 Channel Radio System >

* Attention .. This servo for steering should be used the high-torque type.

Two types of radio control set are on the market, the stick and the steering wheel type. Choose which ever you like.

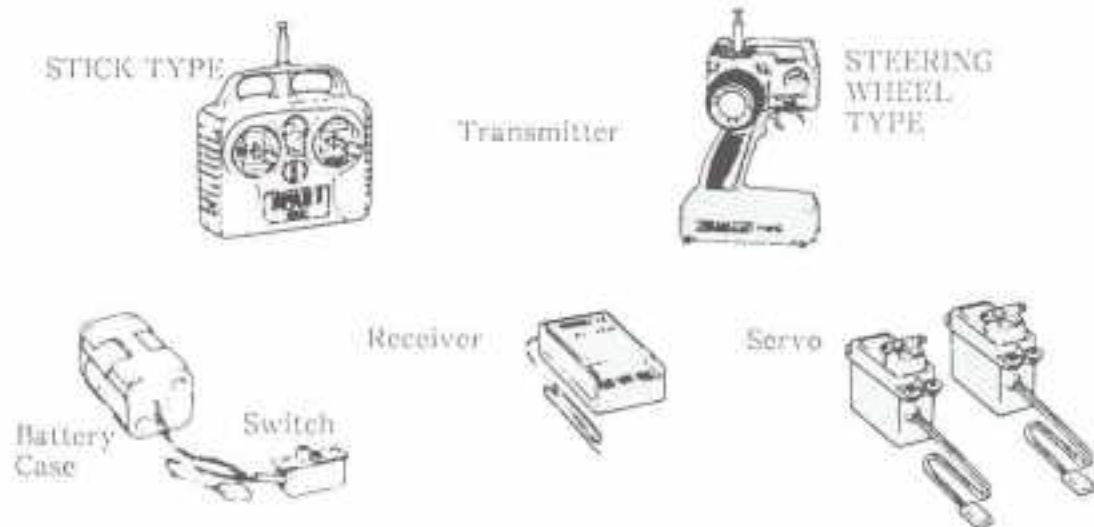

< Battery for Radio System >

For Transmitter ... 8 pcs.
For Receiver ... 4 pcs.



< Engine >

The following 21 size engines can be used for this model car.

OS-21 RFB
ENYA 21 CXL



< Things need to start the engine >

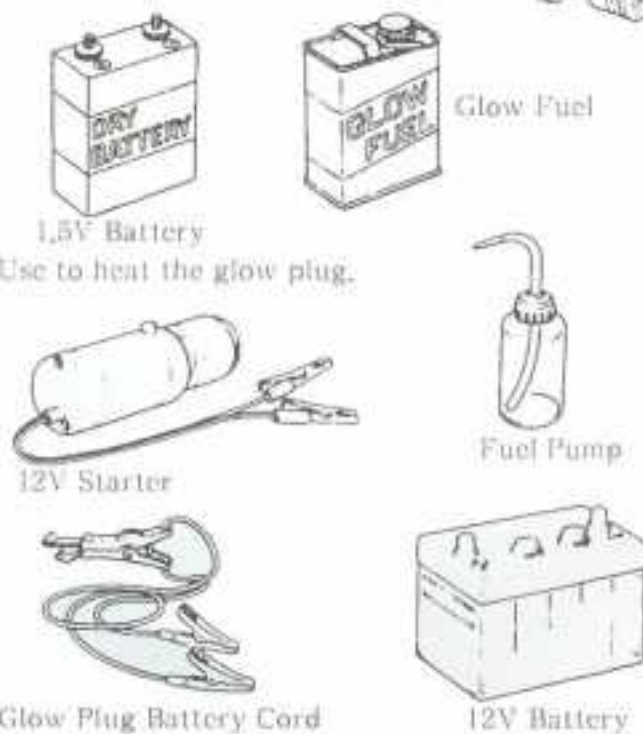

< Tools Required > Hex Wrench, Grease and Screw Locking Compound are in the kit.

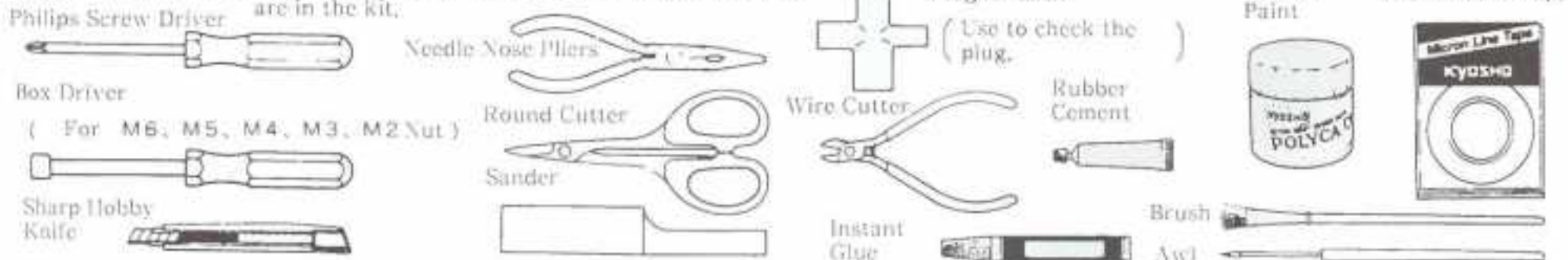

LIST OF BAGGED PARTS (1)



DO NOT THROW AWAY A BAG HEADER!!

The header is the only thing to rely upon when looking for a part. Do not discard until you finish the assembly.



Bag No.	Key #	Parts Name	Q'ty	Step
US-1	1	Shock Piston	8	1
	2	E Ring (E-2.5)	16	1
	3	Spring Holder	8	2
	4	Spring Adjuster	8	2
	5	Shock Ring	8	2
	6	Shock Spring	8	2
	7	Shock Case	8	1
	8	Shock End	8	1
	9	Pressure Top	8	2
	10	Shock Cap	8	2
	11	Shock Shaft	8	1
181	Shock Oil	2	2	
US-3		Center Diff. Assembly	1	Assembly
		Front Gear Box Assembly	1	*
		Rear Gear Box Assembly	1	*
US-4 Plastic Parts	★ 12	Shock Pivot (1)	1	3
	★ 13*	" (2)	1	3
	★ 14	" (3)	1	5
	★ 15	" (4)	1	5
	★ 16	Front Body Mount	2	7
	★ 17	Rear "	2	4
	18	Rear Sus. Holder	1	3
	26	Rear Sus. Arm	2	3
	27	Rear Hub (R)	1	2
	★ 29	Upper Sus. (A)	2	3
	★ 30	" (B)	4	3 7
	★ 41	Shock Bush	8	5 3
	43	φ 6.8 Ball End	8	5 11
	52	Hub Carrier (R)	1	7
	53	" (L)	1	7
	57	Center Diff. Housing (A)	1	9
	58	" (B)	1	9
	★ 77	Radio Plate	1	12
	★ 79	Servo Fixing Post	4	12
	85	Fuel Tank Pivot	1	13
	86	Bumper	1	14 (Cutting)
	100	Servo Fixing Stay (A)	1	16
	101	" (B)	1	16
133	Front Sus. Upper Holder	1	6	
135	Servo Spacer	2	10	
138	Front Sus. Arm	2	7	
141	Rear Hub (L)	1	3	
★ 144	Upper Sus. (C)	2	7	
US-5	23	Joint	1	3
	32	Rear Wheel Shaft	2	2
	33	Swing Shaft	2	2
	34	Rear Shock Stay	1	3
	35	φ 3 X27 Shaft	2	4
	36	φ 3 X44 Shaft	4	3 4
	37	φ 4 X77 Shaft	2	2

Bag No.	Key #	Parts Name	Q'ty	Step
US-5	39	φ 3 Stopper	2	3
	40	Rear Gear Cover	1	3
	42	φ 6.8 Ball	1	3
	55	M3 Pivot Ball	4	3
	73	Tie Rod (A)	1	3
	81	φ 8 X16 Bushing	4	3
	US-6	23	Joint	1
35		φ 3 X27 Shaft	2	7
36		φ 3 X44 Shaft	4	7
39		φ 3 Stopper	2	7
49		Front Shock Stay	1	3
50		Knuckle Arm (R)	1	7
51		" (L)	1	7
54		King Pin	4	7
55		M3 Pivot Ball	4	3
67		Front Gear Cover	1	7
116	Universal Joint	2	7	
147	φ 4 X64 Shaft	2	7	
US-7	42	φ 6.8 Ball	6	11
	44	φ 8 Aluminum Collar	2	17
	59	Disk Brake	1	9
	60	Brake Pads	2	9
	61	Brake Cam	1	9
	62	Brake Stopper	1	9
	63	Brake Lever	1	9
	64	Linkage Guide	1	11
	65	Servo Saver Shaft (A)	2	11
	66	" (B)	1	Assembly 11
	68	Servo Saver Spring	1	11
	70	Servo Saver Horn (B)	1	11
	71	" (C)	1	11
	69	" (A)	1	11
	73	Tie Rod (A)	2	11
	74	" (B)	1	11
	75	φ 6 Aluminum Collar	2	11
	82	Center Shaft	2	10 11
	84	Torque Rod Pivot	1	10
115	Brake Lining	2	9	
155	φ 5 X10 Bearing	2	9	
156	φ 5 X10 Collar	1	9	
157	Counter Gear	1	9	
158	Counter Gear Mount	1	9	
159	Counter Gear Shaft	1	9	
US-8	38	E Ring (E-3)	1	10
	78	Switch Boot	1	10
	83	Mount Plate	2	13
	87	Manifold	1	13
	88	Engine Mount	1set	13

LIST OF BAGGED PARTS (2)

Bag No.	Key #	Parts Name	Q'ty	Step
US-8	89	Fly Wheel	1	15
	90	Clutch Pin	2	Assembly
	91	Pilot Shaft	1	16
	92	Clutch Shoe	2	17
	93	Clutch Spring	1	Assembly
	94	Clutch Bearing Case	1	18
	95	Clutch Rollar	8	Assembly
	96	Clutch Bell (13T)	1	19
	102	Tank Cap	1	20
	103	Tank Seal	1	20
	104	Fuel Tank	1	20
	105	Aluminum Pipe	1	20
	106	Rubber Bush	1	20
	107	Fuel Tube	1	20
	109	Steering Rod	1	27
	110	φ 2 Stopper	5	13
	111	Engine Control Spring	1	28
	112	Linkage Guide (B)	1	13
	139	Silicone Grease	1	
	140	Screw Locking Compound	1	
	142	Engine Control Rod	1	13
	146	Air Cleaner	1 set	13
	153	Brake Rod	1	13
		φ 5 X 10 Washer	1	13
		φ 6 X 18 Washer	1	13
US-9	76	Antenna Pipe	1	20
	80	Strap (L)	1	20
	98	Muffler (A)	1	10
	99	• (B)	1	10
	108	Plate Joint	1	20
	117	φ 2.6 X 16 Shaft	4	20
	118	Wheel Stopper	4	20
	119	O Ring (L)	4	20
	134	Strap (M)	3	13 14
	135	Rear Shock	1	20
	148	φ 38 Muffler Baffle	1	10
	151	Radio Cover	1	20
	★160	Rear Shock (Plate)	1	20
	★161	Front Shock (Plate)	1	20
	★162	Front Grill	1	20
	★163	Front Grill Stopper	2	20
	★164	Headlight Lens (R)	1	20
	★165	• (L)	1	20
	★166	Position Light Lens	2	20
	★167	Door Mirror (R)	1	20
	★168	• (L)	1	20
	★169	Door Mirror Stopper	2	20
	★170	Roll Bar (F)	1	20
	★171	• (R)	1	20
	★172	Roll Bar Back Stay (R)	1	20
	★173	• (L)	1	20
	★174	Fog Light Cover	5	20
	★175	Fog Light	1	20
	★176	Dummy Air Cleaner Cover	3	20
	★177	Dummy Air Cleaner	3	20
	★178	Carburetor	1	20
	179	Double Sided Tape	1	20
	183	φ 8 X 16 Washer	4	20

Bag No.	Key #	Parts Name	Q'ty	Step
BOX	113	Wheel	4	10
	114	Tire	4	10
SMALL BOX	121	Body	1	20
	143	Main Chassis	1	10
INSTRUCTION	145	Decal	1	20
	152	Side Guard	2	20
	180	Mirror Seal	1	20
		Instruction	1	
US-2	2	E Ring (E-2.5)	16	13 14 15
	38	• (E-3)	10	13 14
	97	• (E-4)	1	10
	120	Wheel Stopper Bolt	4	20
	122	Body Pin	8	20
	184	φ 5 Lock Ring	6	20
	31	M5 X 35 Shaft	4	13 14
		M3 X 8 T P Bind Screw	11	
		M3 X 10 •	19	
		M3 X 15 •	10	
		M4 X 15 •	16	
		M4 X 20 TP Flat Head Screw	6	
		M4 X 25 •	4	
		M2.6 X 8 TP Round Head Screw	10	
		M2.6 X 16 •	2	
		M2.6 X 18 •	6	
		M3 X 12 Flat Head Screw	2	
		M3 X 18 Round Head Screw	2	
		M3 X 10 Bind Screw	1	
		M3 X 15 •	2	
		M3 X 25 •	2	
		M4 X 8 •	9	
		M4 X 10 •	2	
		M4 X 15 •	2	
		M3 X 10 Cap Screw	5	
		M3 X 18 •	10	
		M3 X 25 •	1	
		M4 X 10 Flange Cap Screw	4	
		M3 X 3 Set Screw	11	
		M4 X 12 •	4	
		M5 X 4 •	2	
		M2 Nut	1	
		M3 Nylon Nut	12	
	M3 Flange Nut	10		
	M4 •	2		
	M5 •	1		
	M3 Washer	14		
	M5 X 10 Washer	1		
	M5 X 12 •	2		
	Hexagonal Wrench (1.5)	1		
	• (2)	1		
	• (2.5)	1		
	• (3)	1		
<p>(1) The key numbers with ★ indicated the plastic parts on a runner.</p> <p>(2) There are spare screws to assemble.</p>				

1 ASSEMBLY OF OIL SHOCK These parts are in the bag (US-1) .

STAGE 1 Assemble 8 pieces.

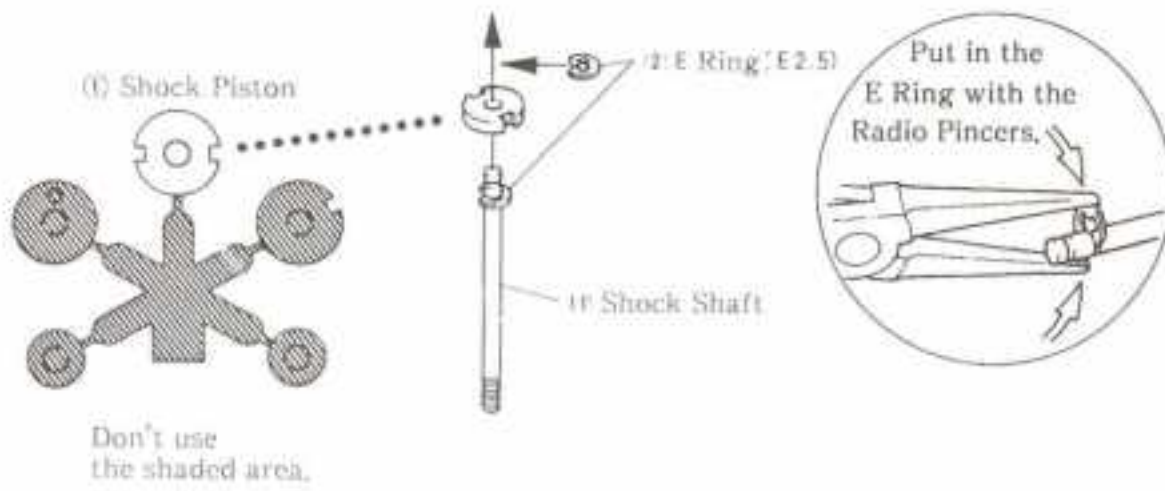

STAGE 2

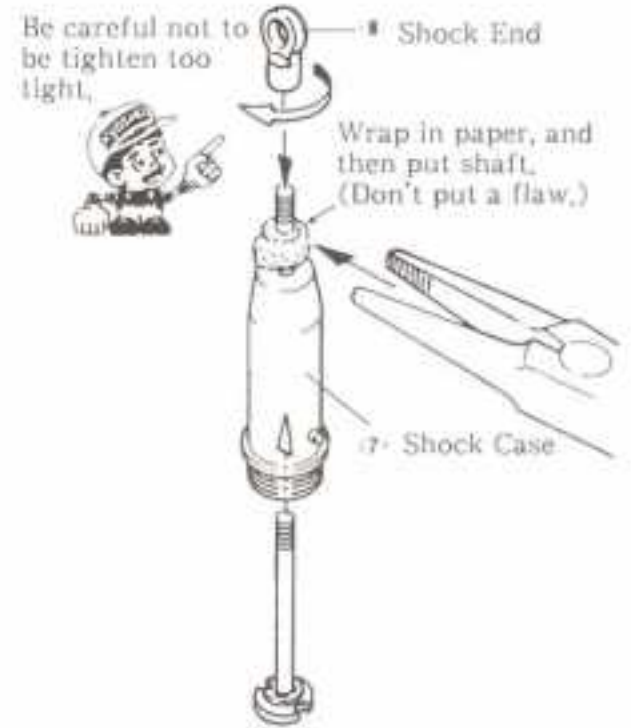

2 FILLING SHOCK OIL These parts are in the bag (US-1) .

STAGE 1

Pull down the piston to the bottom and pour oil slowly. Then move the piston up and down gently to get rid of air bubbles.

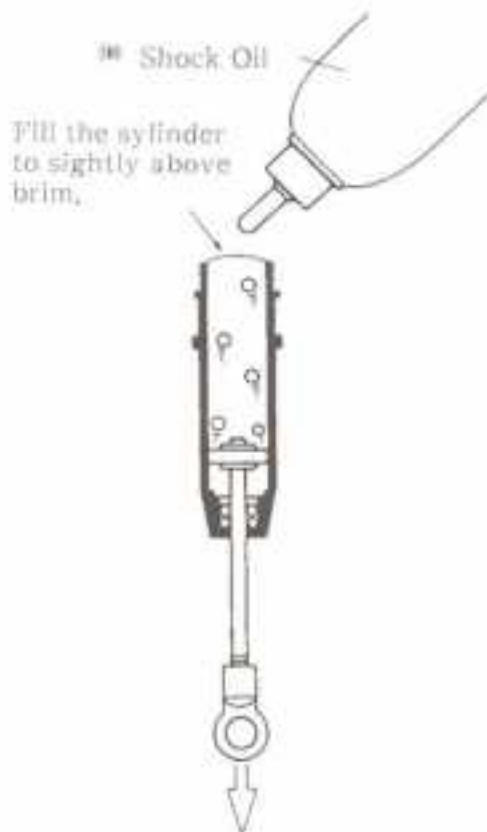

STAGE 2

Keep the position in the lowest position and tighten the shock cap gradually, then excessive oil will spill over.

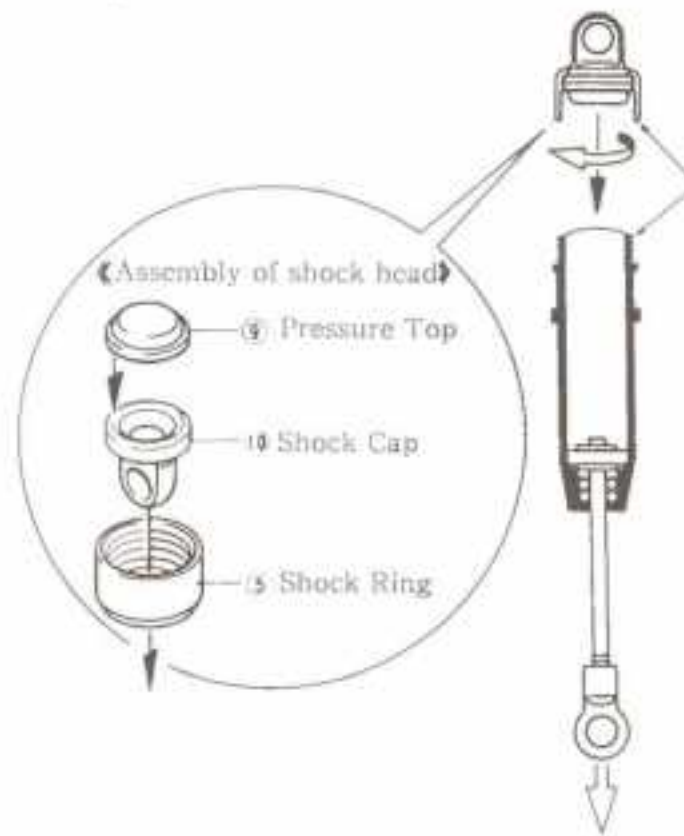

STAGE 3

Confirm that it will work smoothly by moving the piston up and down.

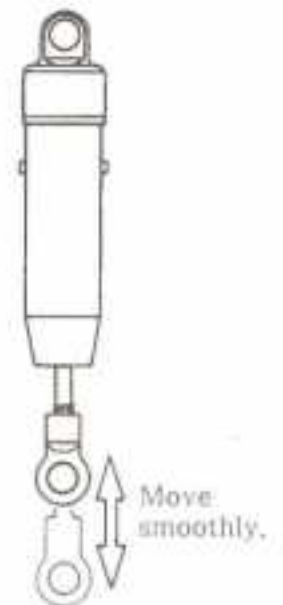

- Spring tension can be adjusted by high simply changing the hole position of the spring adjuster.

STAGE 4 Assemble 8 pieces.

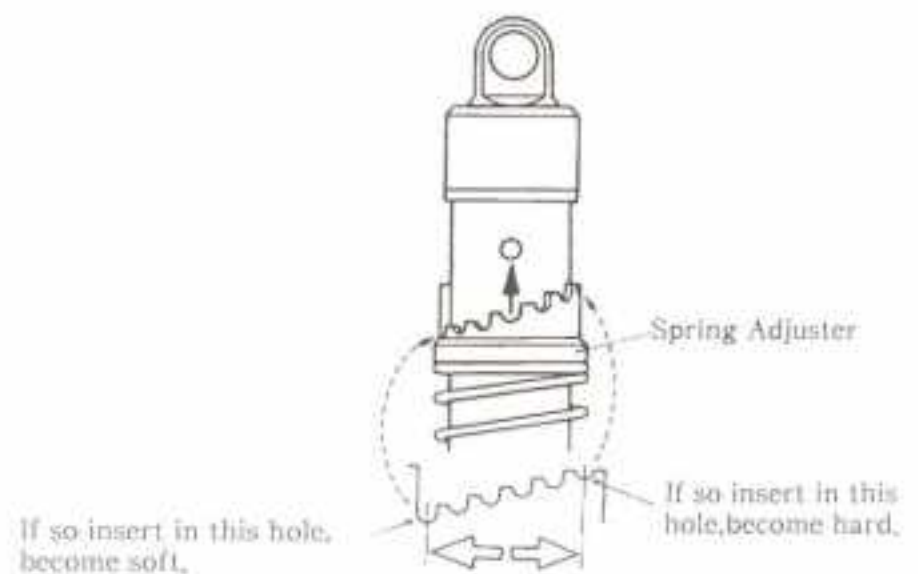
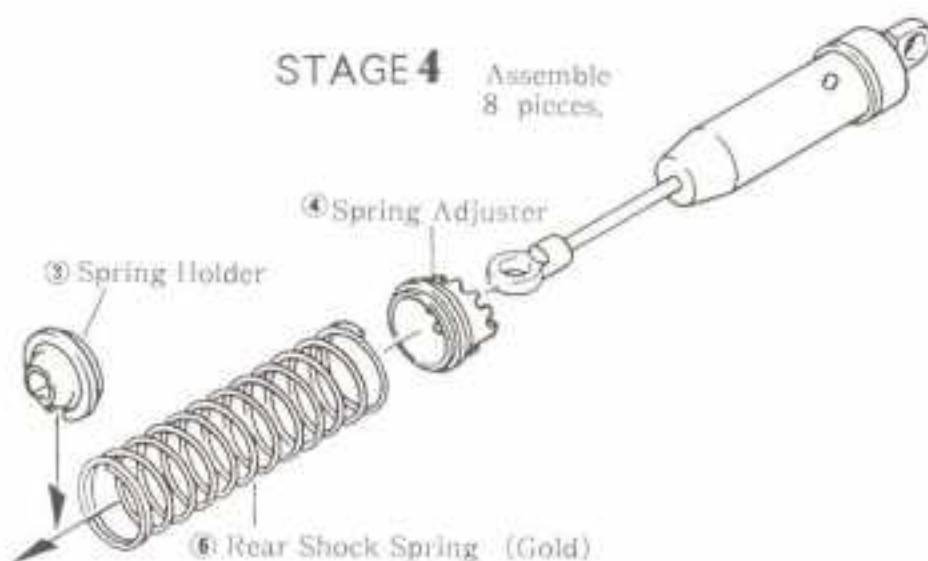

3 INSTALLATION OF REAR GEAR BOX PARTS

These parts are in the bag (2, 3, 4, 5).

STAGE 1

< Assembly of Upper Roc >

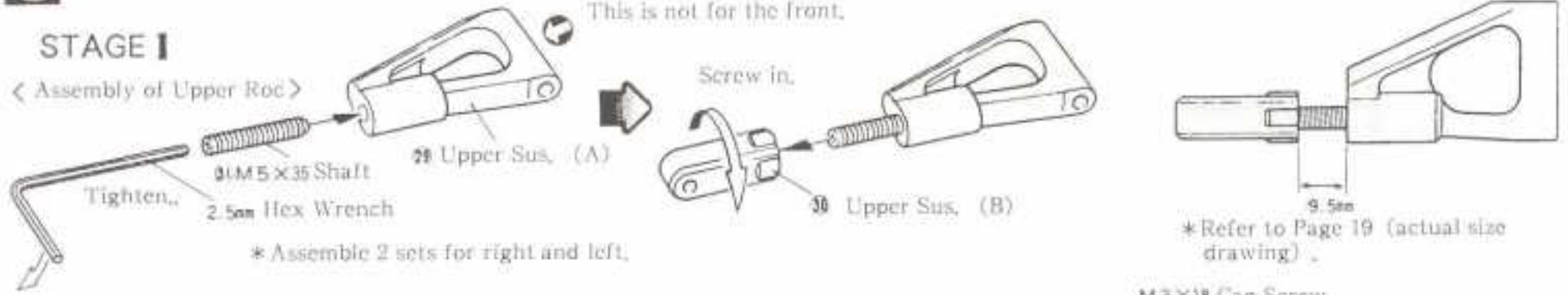

STAGE 2

M4x25 T P FH Screw

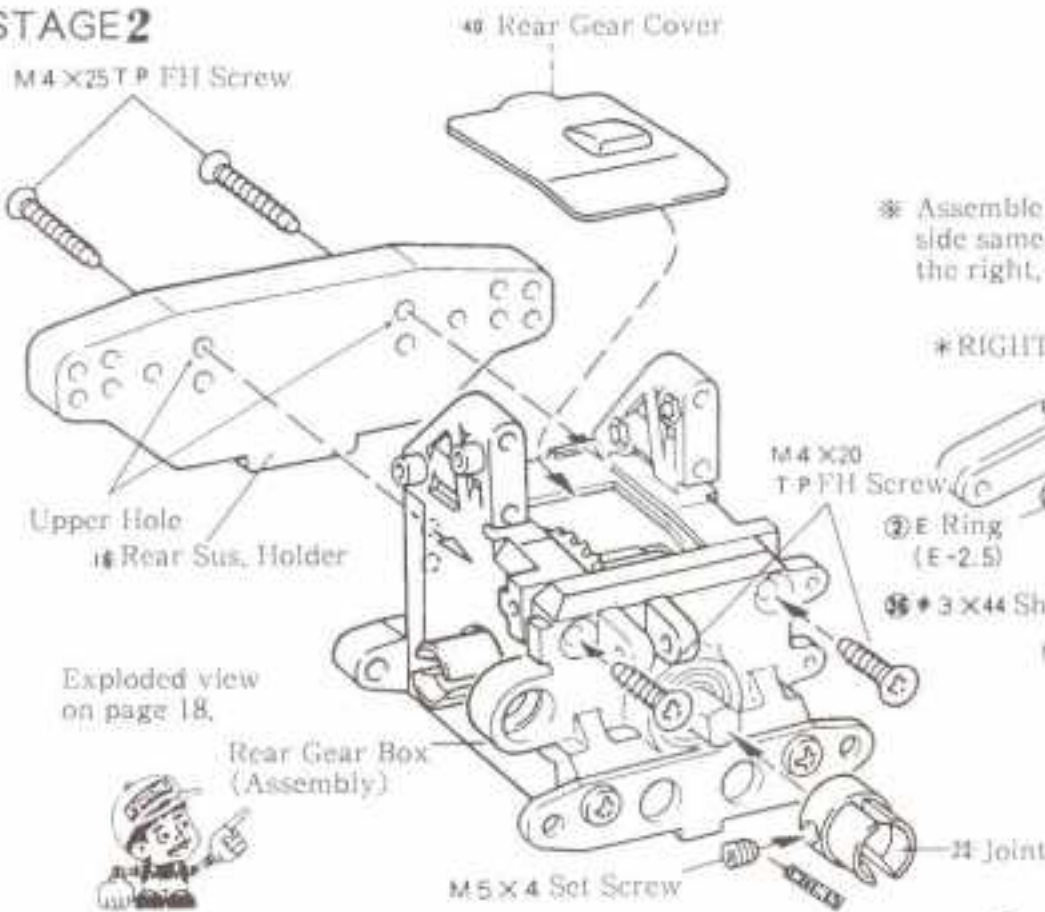

STAGE 3

⑨ Rear Shock Stay

* Assemble the left side same as the right.

* RIGHT *

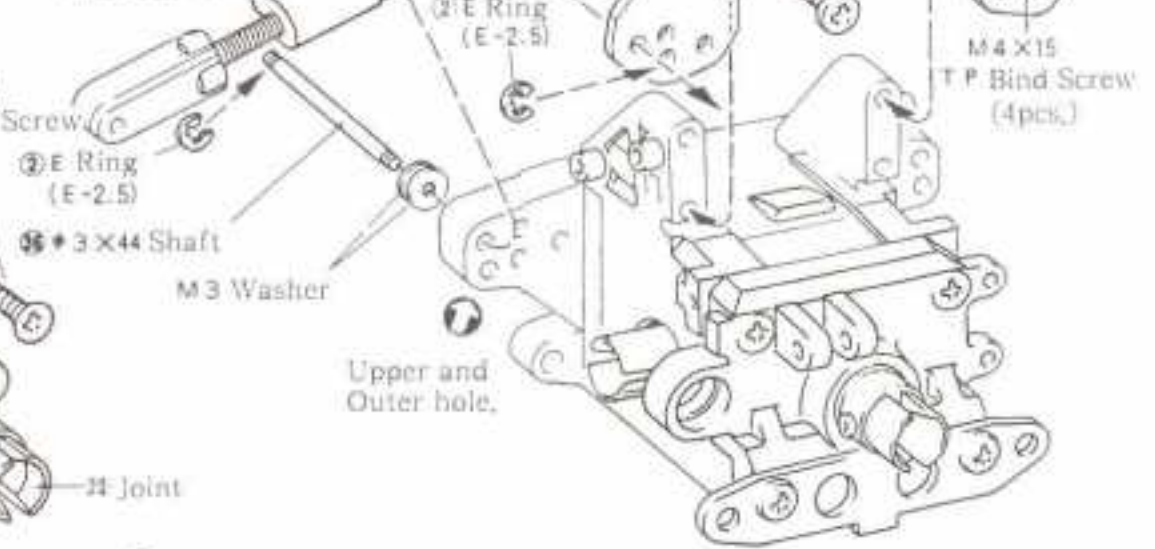

4 INSTALLATION OF REAR SUSPENSION ARMS

* These parts are in the bag (US-2, 4, 5).

STAGE 1

Cut the shaded of the rear hub (R) and (L).

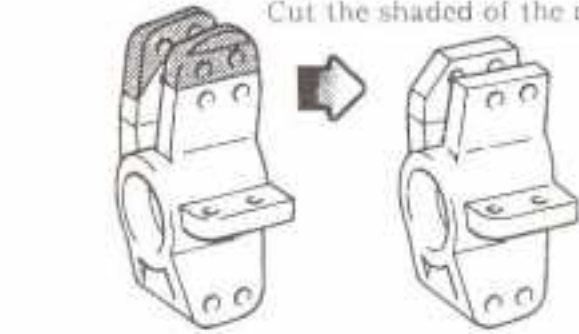

STAGE 2

* Assemble the left side same as the right.

* RIGHT *

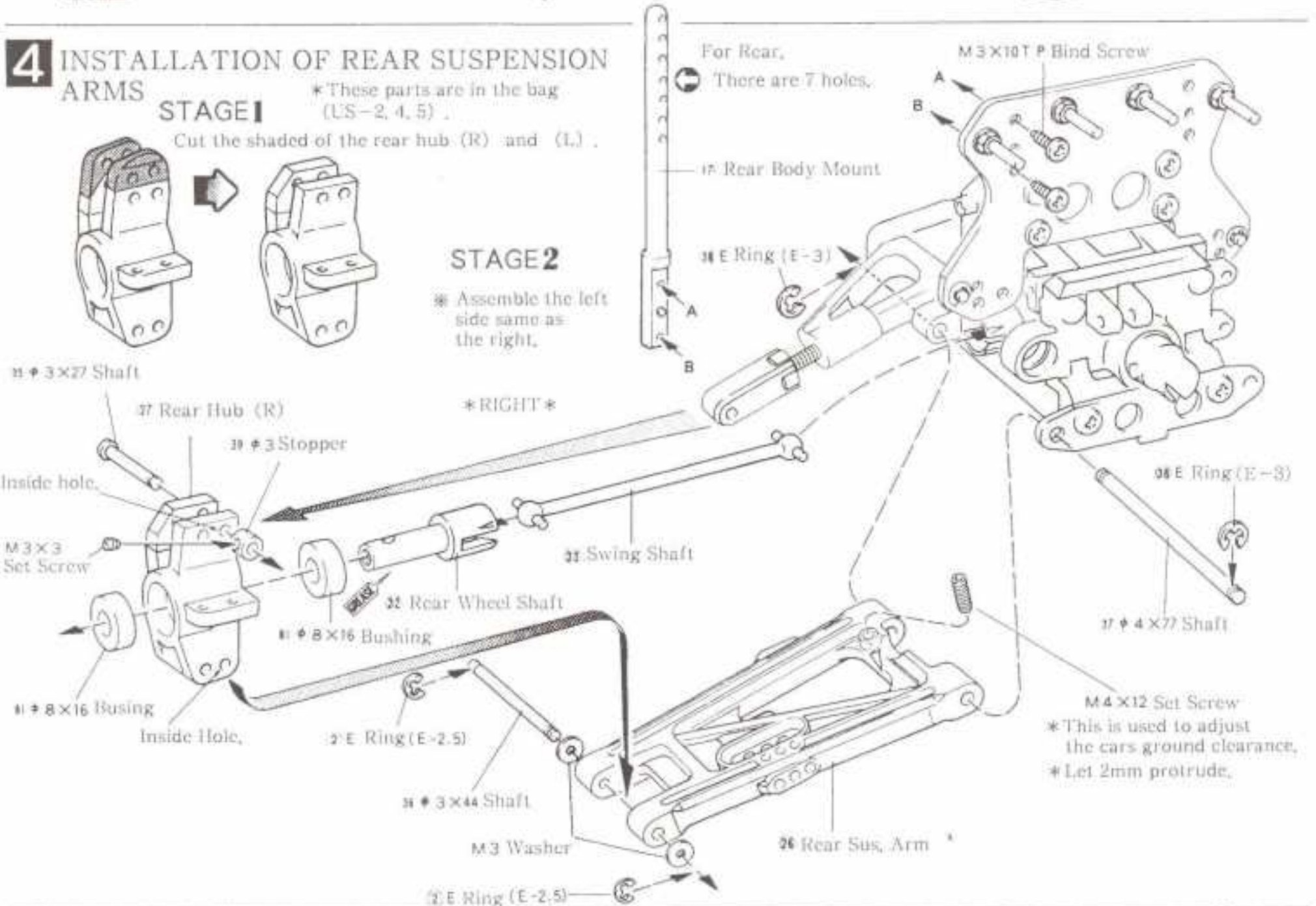

5 INSTALLATION OF REAR SHOCK

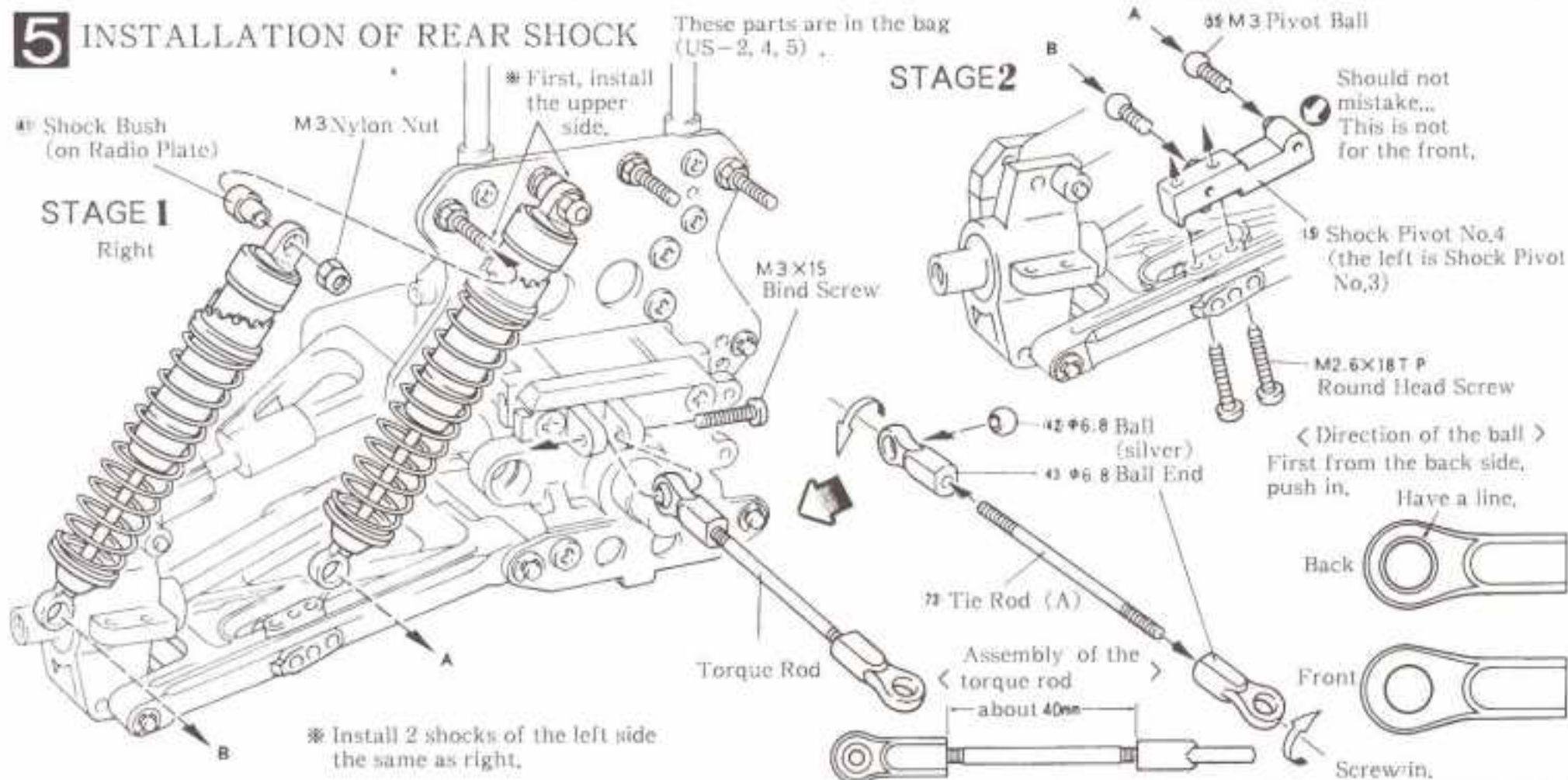

6 INSTALLATION OF FRONT GEAR BOX PARTS

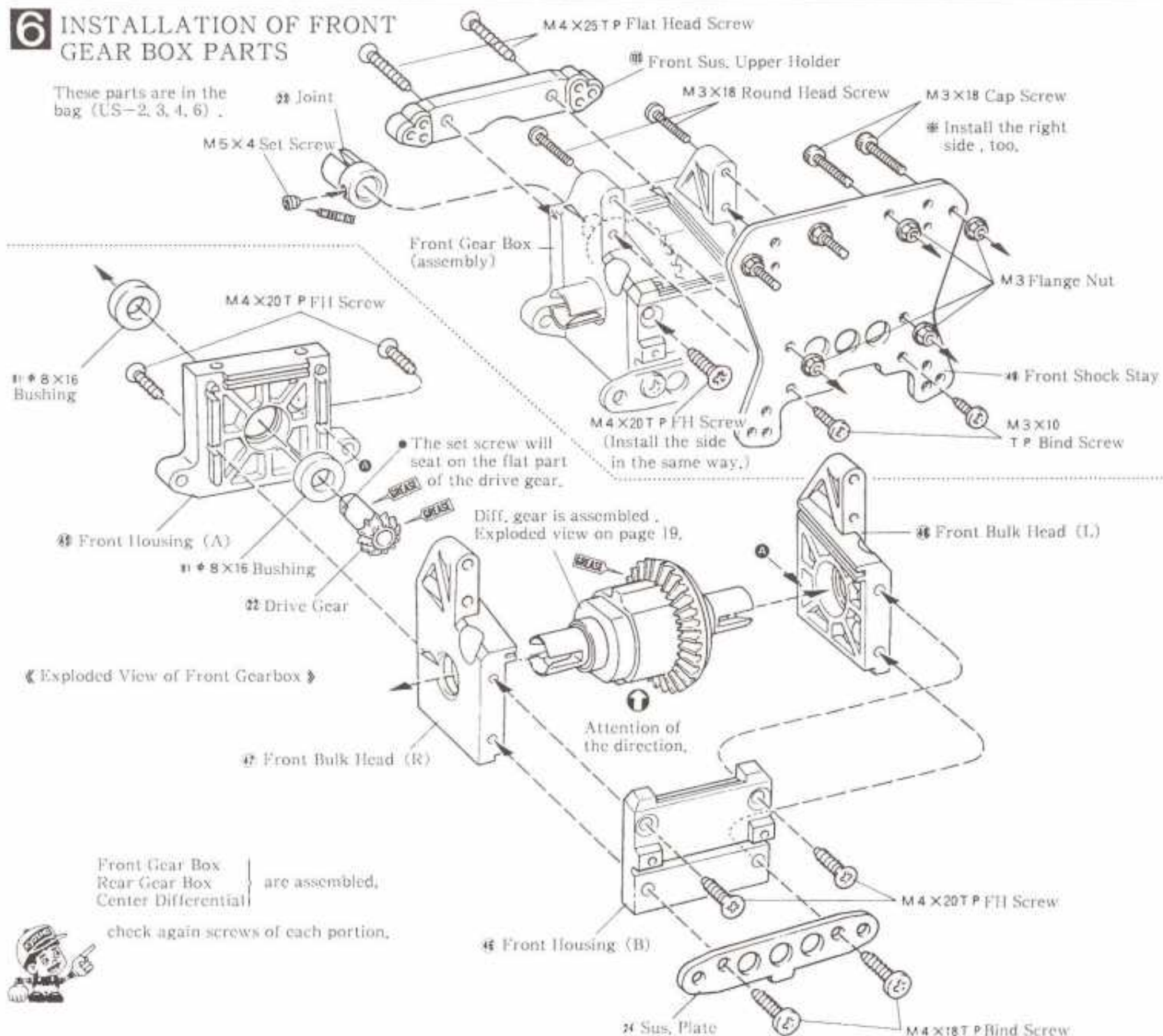

9 INSTALLATION OF BRAKE & COUNTER GEAR

STAGE 1 < Applying of Brake Lining >

Affix the brake lining to the disk brake on both sides with a instant glue.

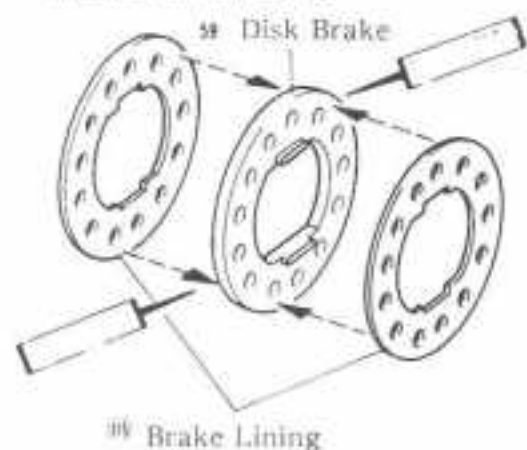

STAGE 2 < Assembly of Counter Gear >

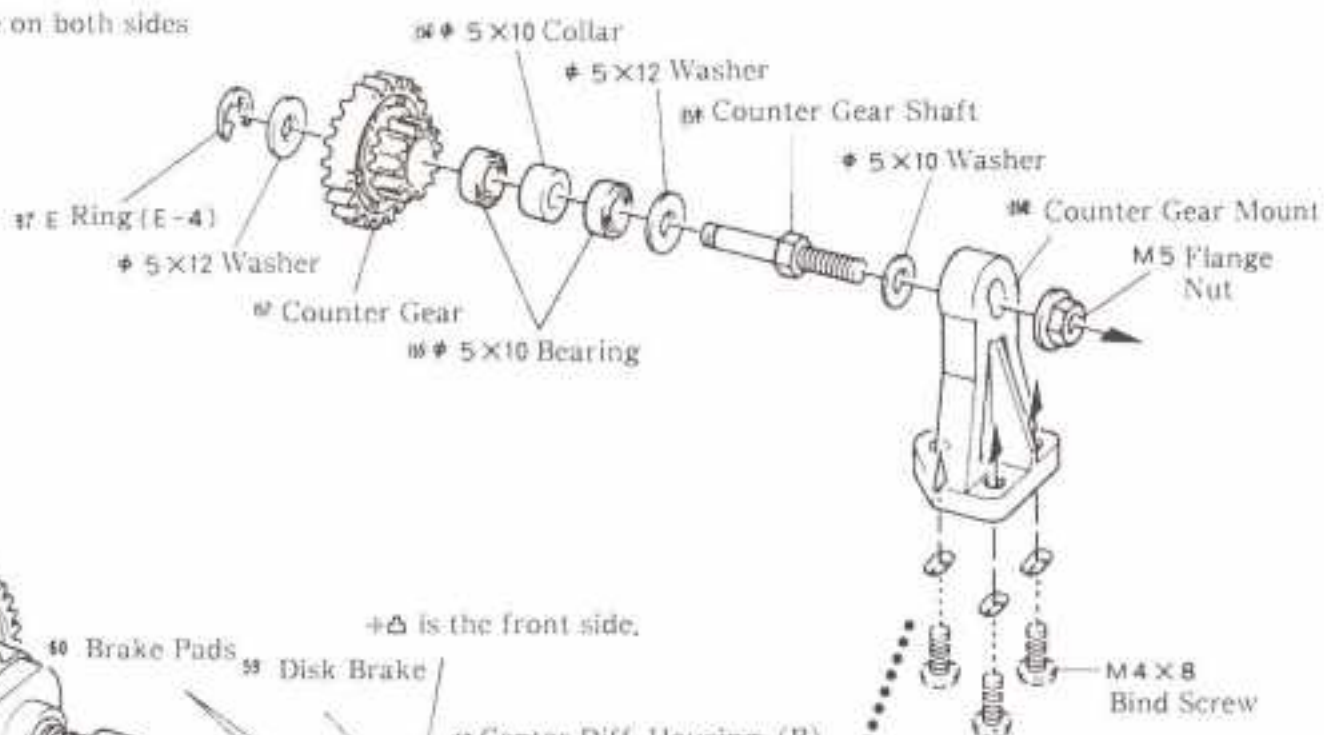

STAGE 3

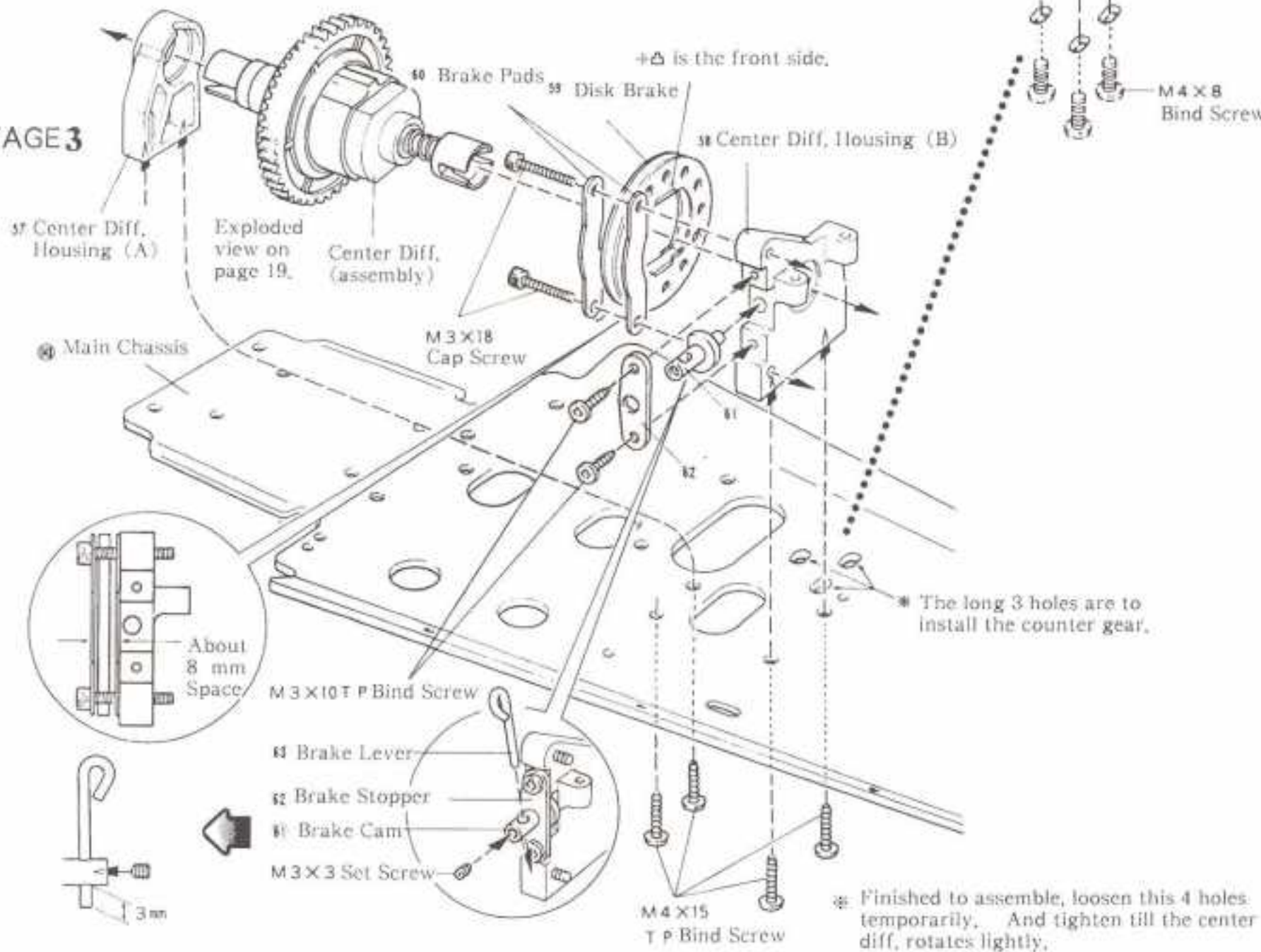

10 ADJUSTMENT OF COUNTER GEAR

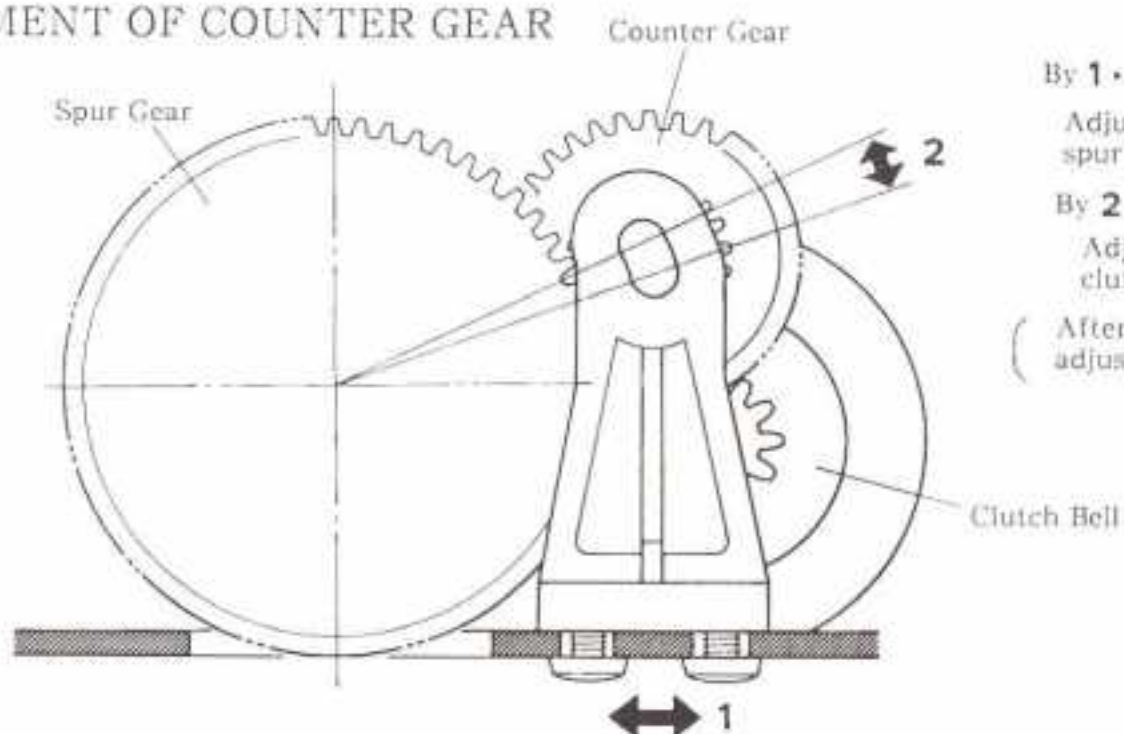

By 1 ...

Adjust the backlash between the spur gear and the counter gear.

By 2 ...

Adjust the backlash between the clutch bell and the counter gear.

(After 1 (installation of engine) . adjust at 2 .)

11 ASSEMBLY OF STEERING PORTION

These parts are in the bag (US-2, 4, 7).

STAGE 1

Assembly of Tie Rod

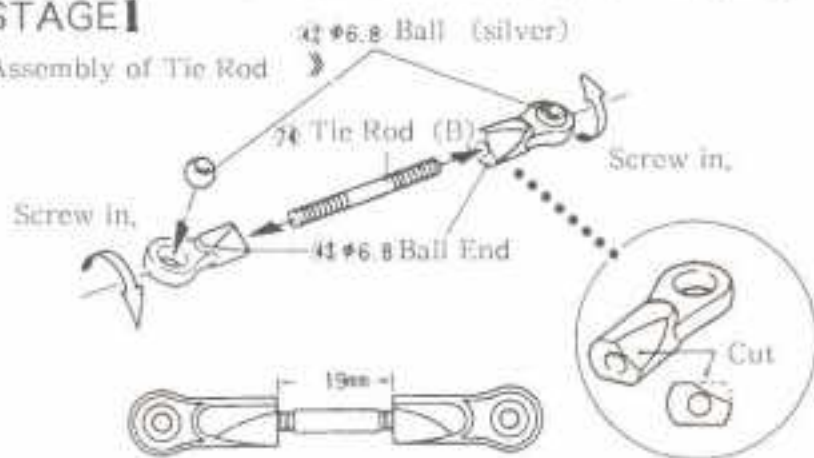

First, tighten this nut till the end. And loosen till half spin. If so can screw the linkage guide (A) lightly.

STAGE 2

Assembly of Side Rod

Assemble 2 sets for left and right.

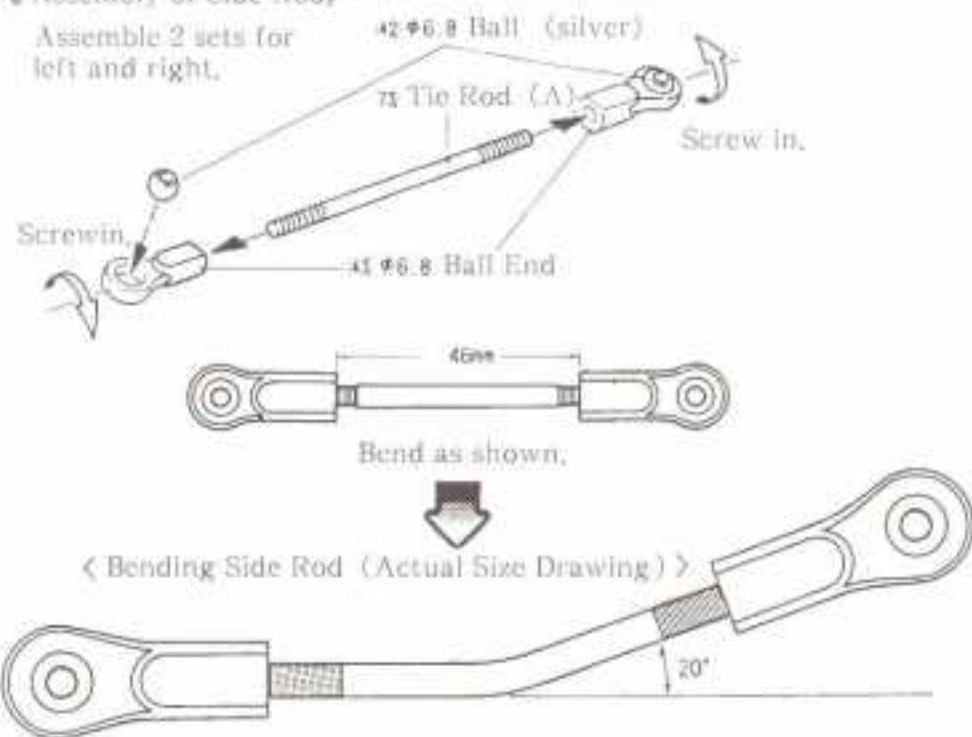

STAGE 3

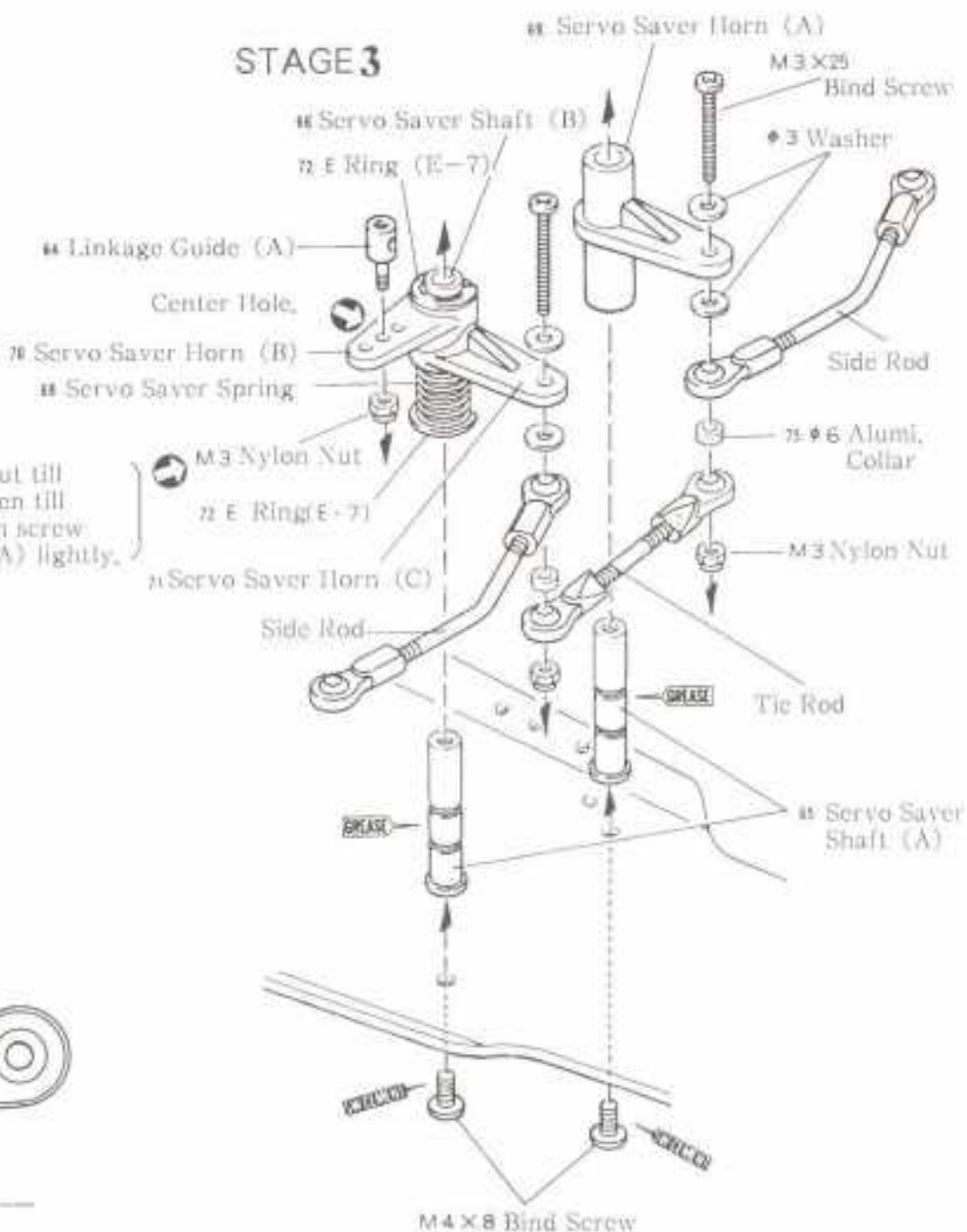

12 INSTALLATION OF RADIO SYSTEM

These parts are in the bag (US-2, 4, 8, 9).

Use the high-torque type to the steering servo.

When the car runs on the soiled road, it is better to put the radio cover to the receiver.

STAGE 1

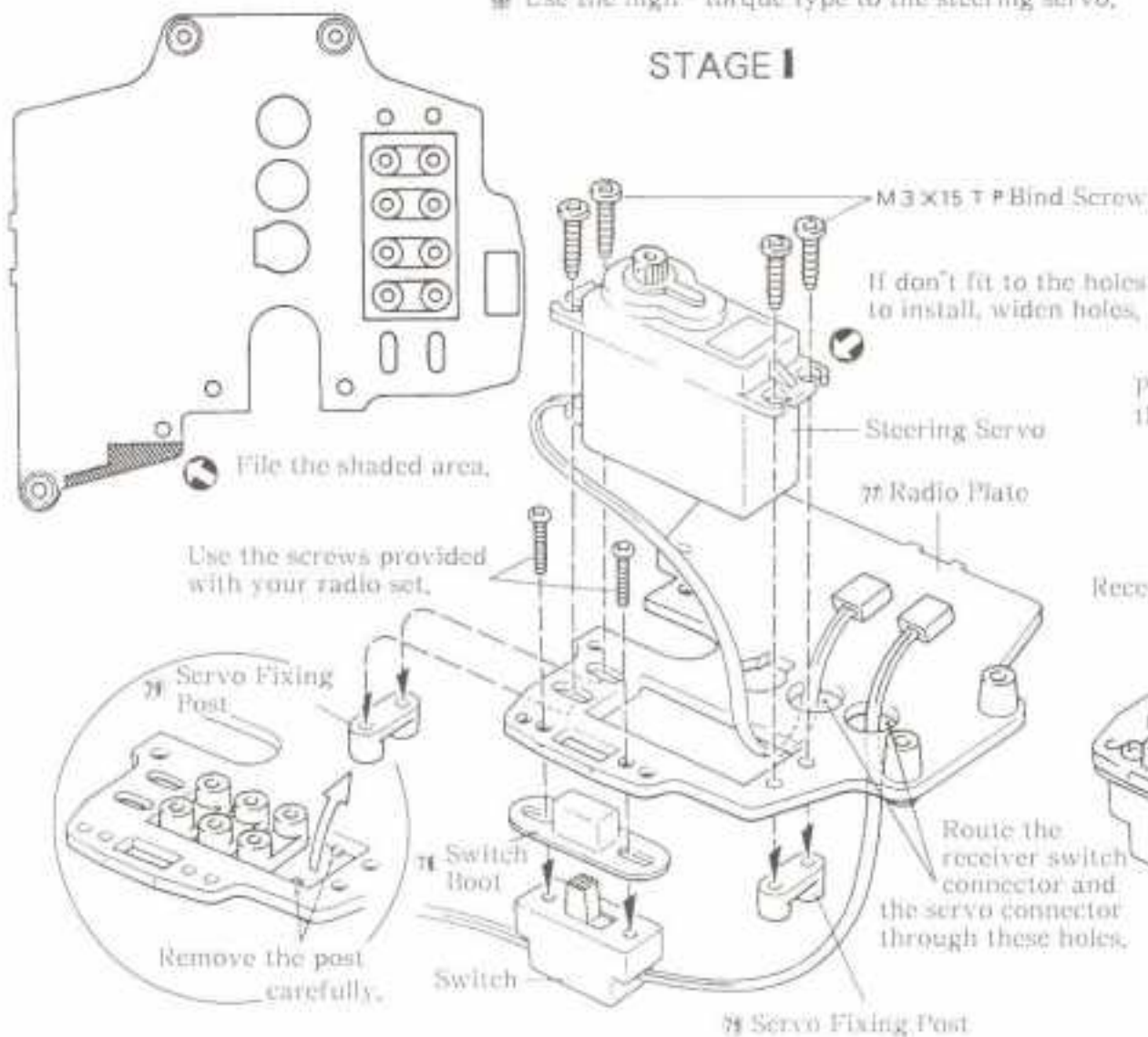

STAGE 2

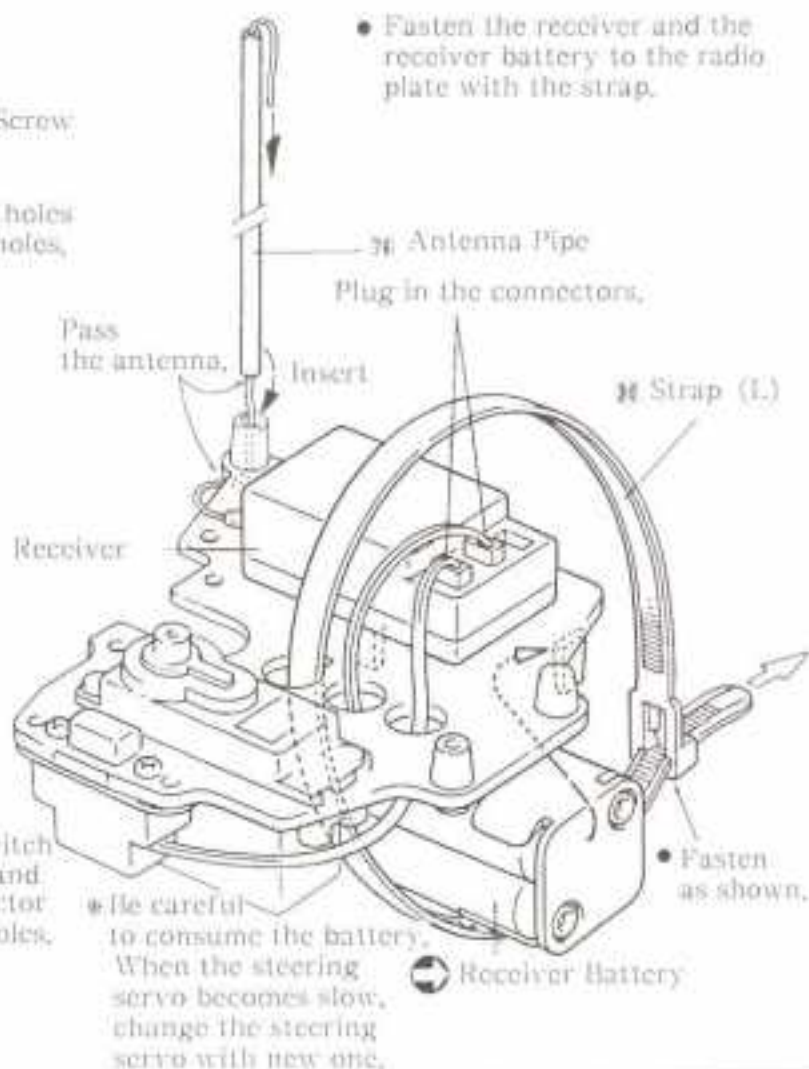

13 INSTALLATION OF REAR ASSEMBLY

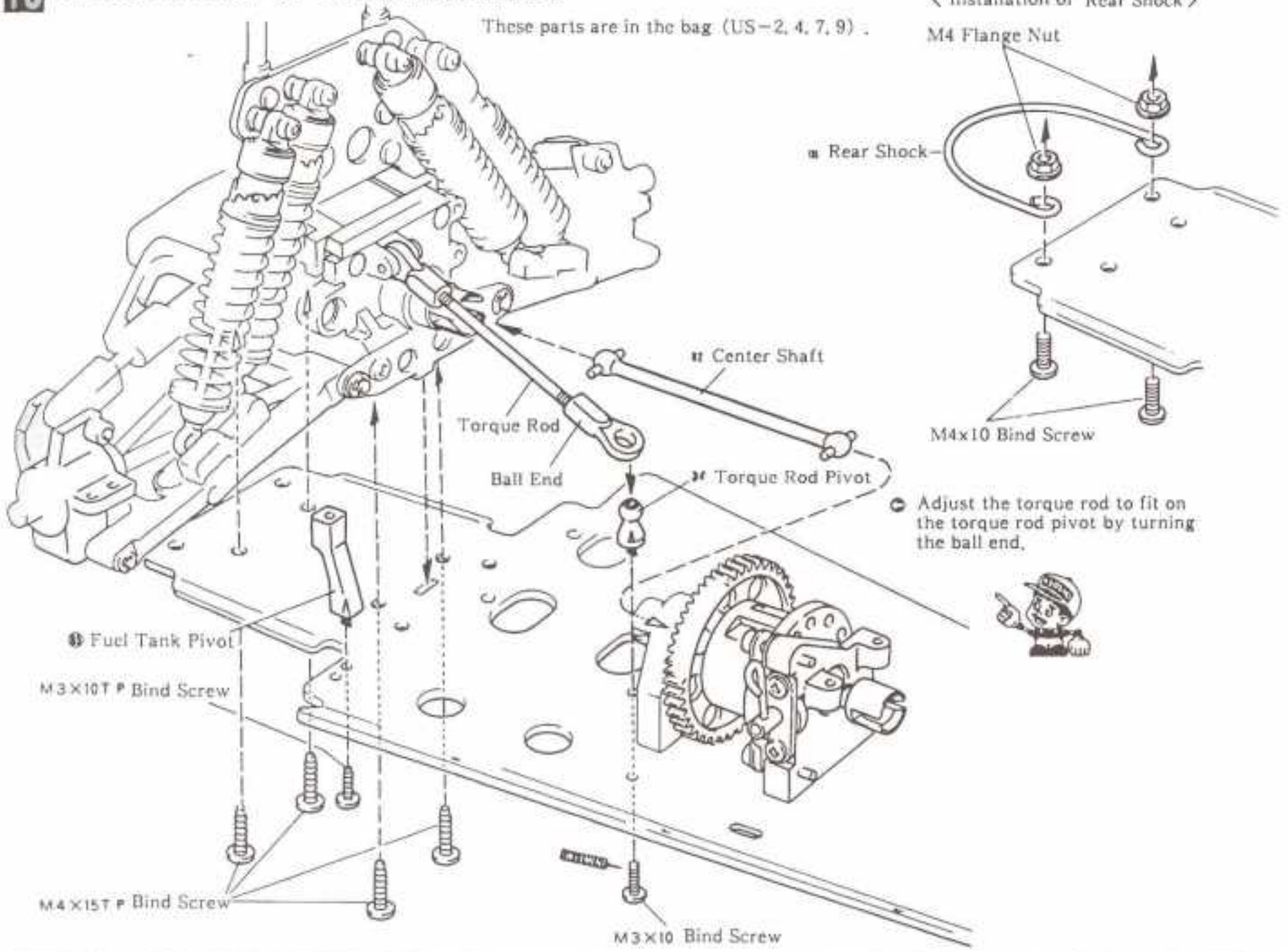

14 INSTALLATION OF FRONT ASSEMBLY

These parts are in the bag (US-2, 4, 7).

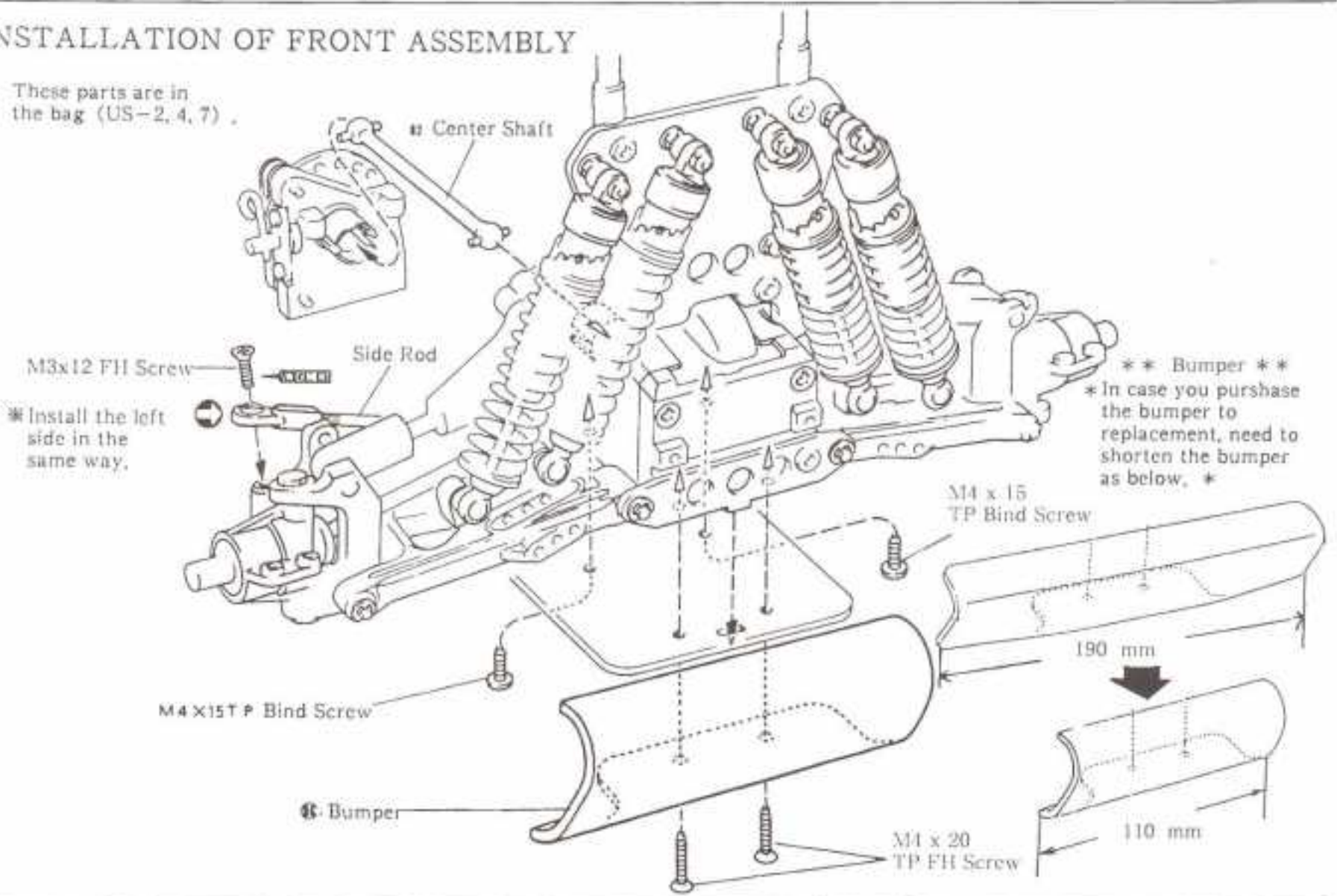

17 INSTALLATION OF RADIO PLATE

These parts are in the bag (US-2, 7, 8, 9)

Use the screw provided with your radio set.

Servo Horn

M3 X10T P Bind Screw

Install servo horn with servo in neutral position.

Steering Rod (Large and Long)

M3 X3 Set Screw

M4 X15 Bind Screw

M3 X10T P Bind Screw

M4 X15T P Bind Screw

Plate Joint

φ8 Aluminum Collar

Bend the steering rod referring the height of the servo. Be careful... This is not the brake rod.

18 ENGINE CONTROL LINKAGE

These parts are in the bag (US-2)

Illustration of carb and brake linkage for radio with servo reverse.

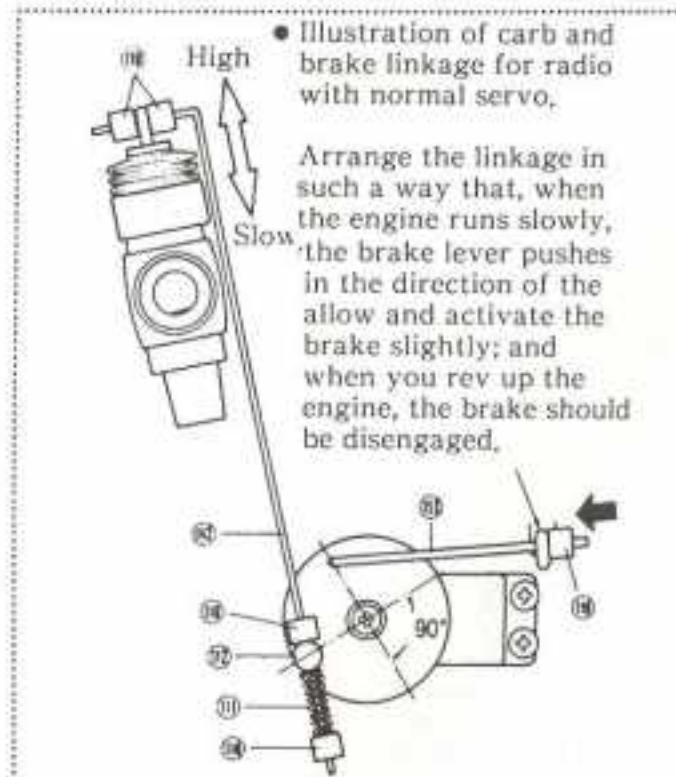
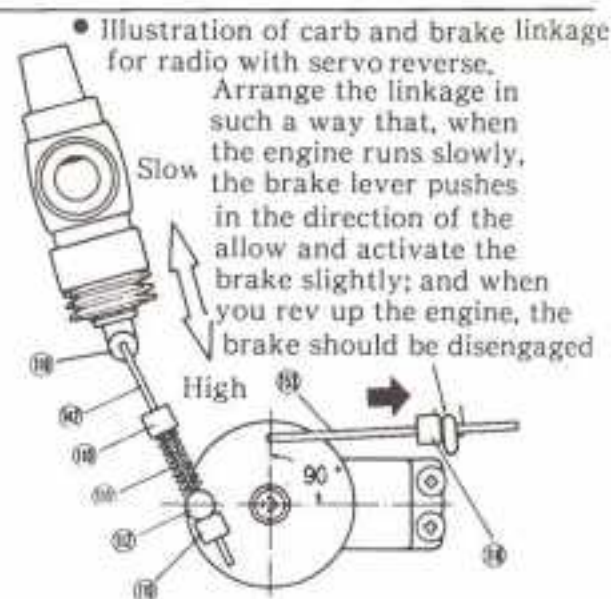
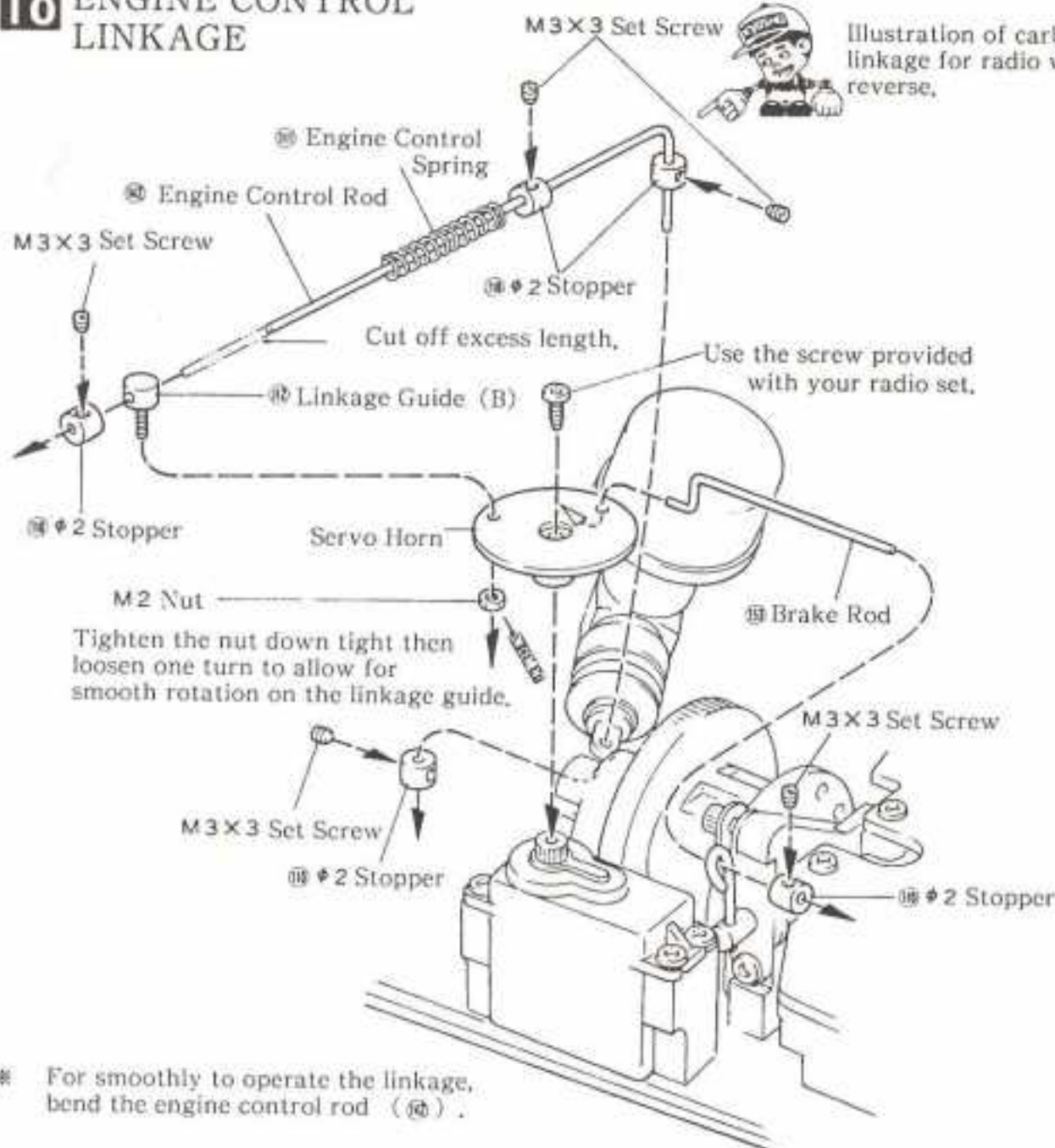

* For smoothly to operate the linkage, bend the engine control rod (ⓐ).

19 CEMENTING TIRE & WHEEL



* Be careful about the direction of wheel and tire.

STAGE 1

* RIGHT *

Make 2 pieces.

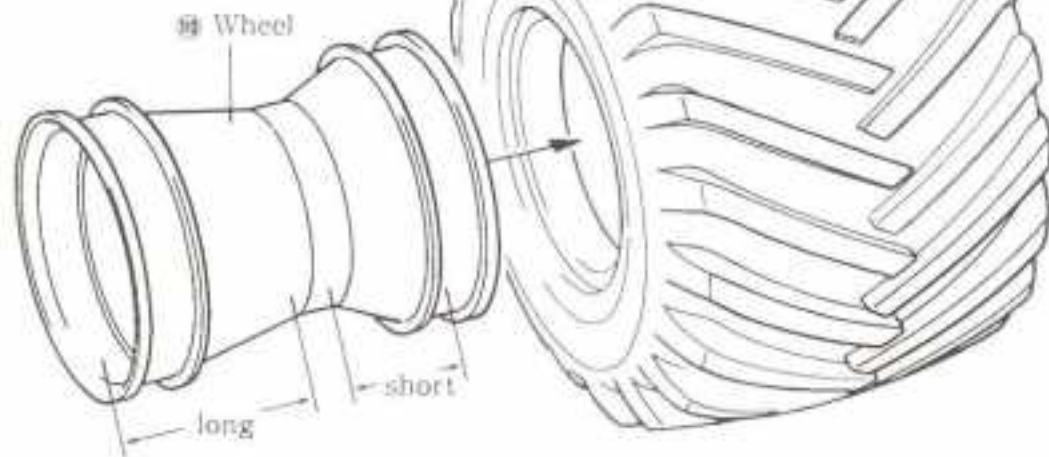

* LEFT *

Make 2 pieces.

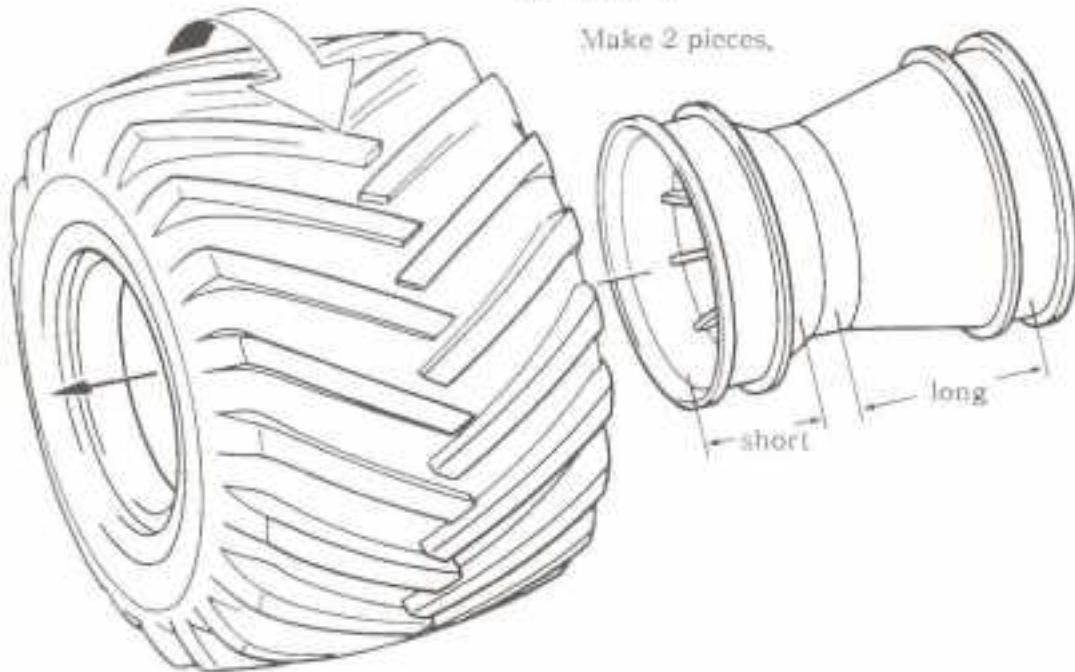

{ PLATE OF WHEEL }

- Paint surface can be damaged by fuel, coating with fuel-resistant material is recommended.
- As the plate portion to apply hard to put a instant glue, file it by a sandpaper. (Wash the applying portion of tire to remove any oil and rinse thoroughly with clean water.)

Fit the tire into the groove.

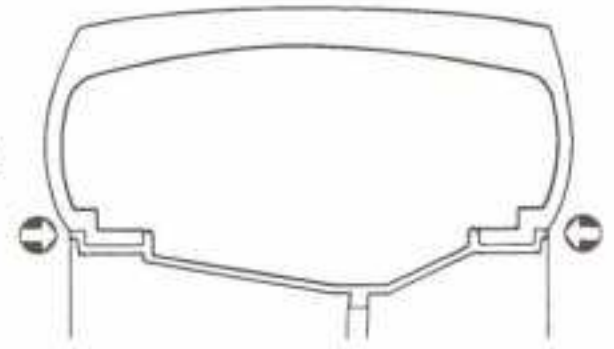

STAGE 2

While pushing the tire out away from the rim put a drop of instant glue in the groove of the rim in the location and order shown below.

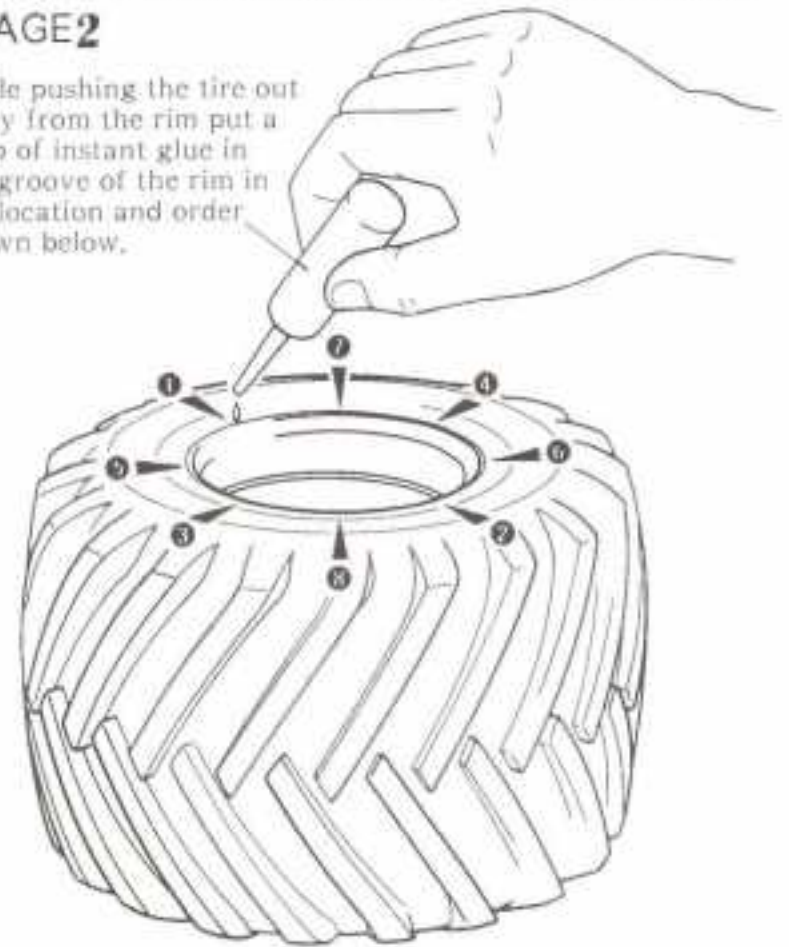

20 INSTALLATION OF TIRE

These parts are in the bag (US-2,9)

* RIGHT *

{ Front }

8x16 Aluminum Washer

Wheel Stopper Bolt

• Use a rubber-based glue to the wheel bolts. After the glue has dried, tighten them.

Wheel Stopper

O Ring (L)

2.6x16 Shaft

* Fit a dent of wheel stopper with the shaft. And then push in.

* RIGHT *

{ Rear }

Wheel Stopper

O Ring (L)

* Fit a dent of wheel stopper with the shaft. # 2.6x16 Shaft And then push in.

Wheel Stopper Bolt

8x16 Aluminum Washer

Be careful about the direction of tire.

21 CUTTING BODY

- Cut the shaded area with a round cutter.
- Make holes with a awl.
- Finish the rough edges with a sander.

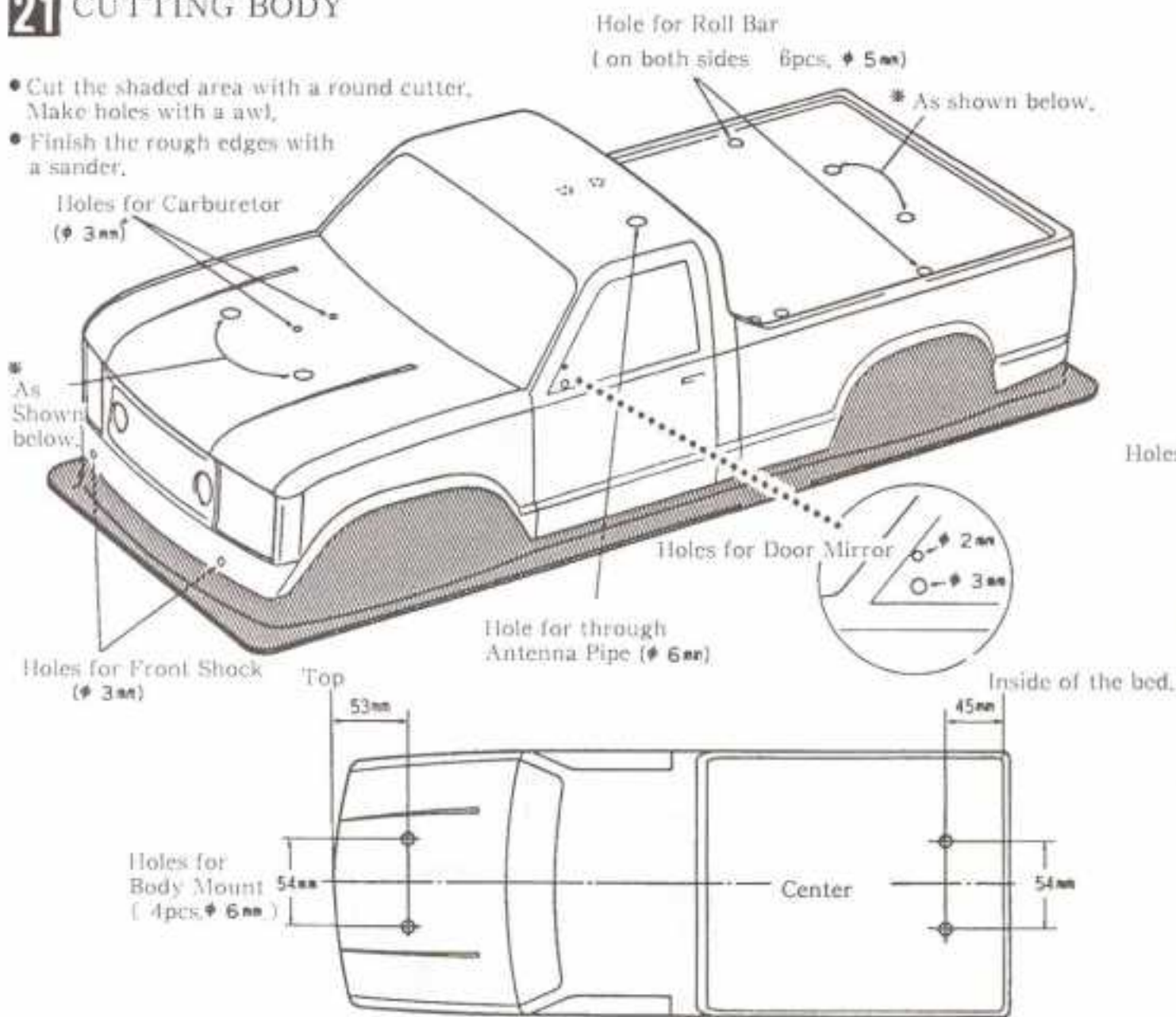

< Back >

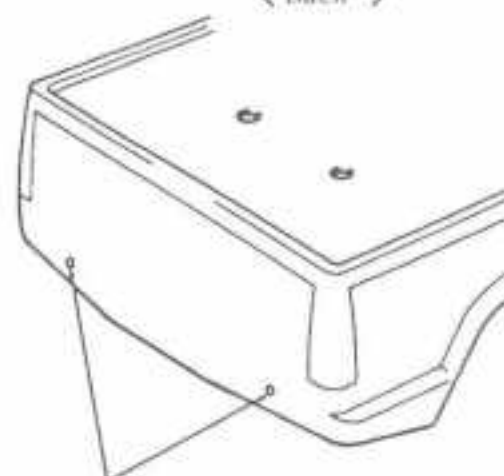

Holes for Rear Shock (φ 3mm)

KYOSHO No 1829

• These special Laxan Scissors make trimming bodies a breeze and the sander comes in handy for finishing the rough edges.

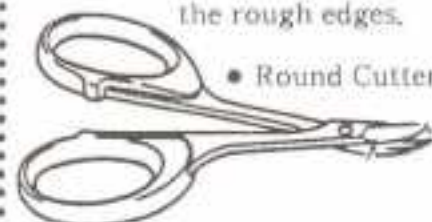

• Round Cutter



• Sander

22 PAINTING

First wash the body to remove any oil or dirt and rinse thoroughly with clean water.

Paint the inside of body.

You can obtain a color scheme by masking a portion with tape then removing the tape and painting.

Apply the lightest color last.

Paint the body to a white color. And paint the bed a black. Reference the picture of this case.

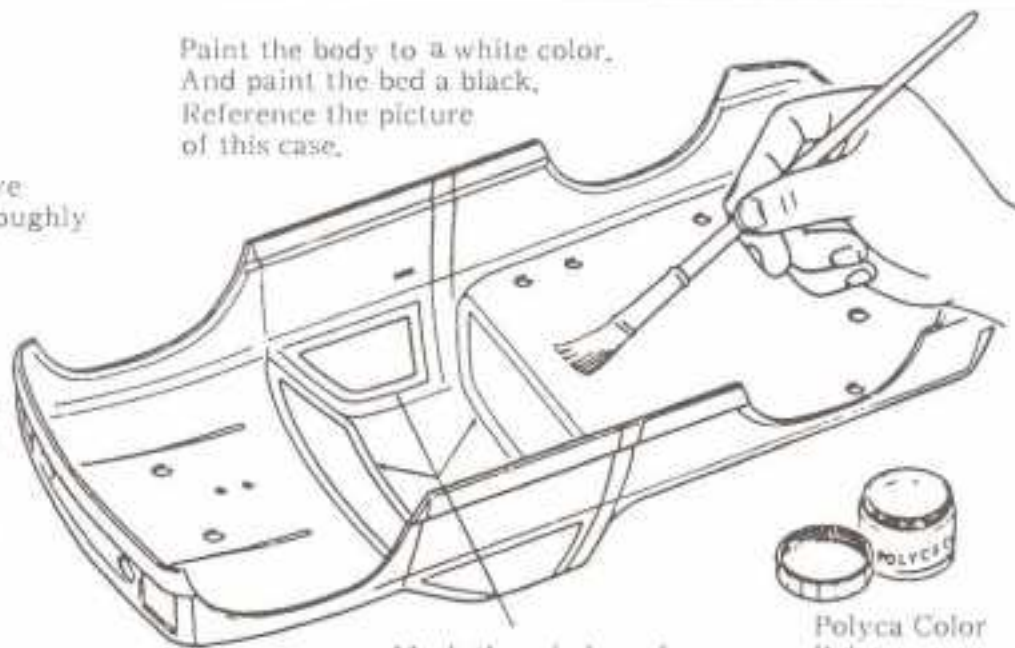

Mask the windows from the inside with the Micron Line Tape.



Polyca Color Paint (Kyosho)

KYOSHO No 1841-3

- No. 1841 ... 1mm
- No. 1842 ... 1.5mm
- No. 1843 ... 2.5mm
- Color: White, Red, Yellow, Green, Blue and Black
- For border ... Black
- 0.4mm ... No. 1859
- 0.7mm ... No. 1860



KYOSHO No 2230

- White, Red, Yellow, Blue, Skyblue, Green, Orange, Black, Violet, F. Orange, F. Pink, Yellow Green and Calsonic Blue



23 INSTALLATION OF CARBURETOR

These Parts are in the bag (US-2, 9).

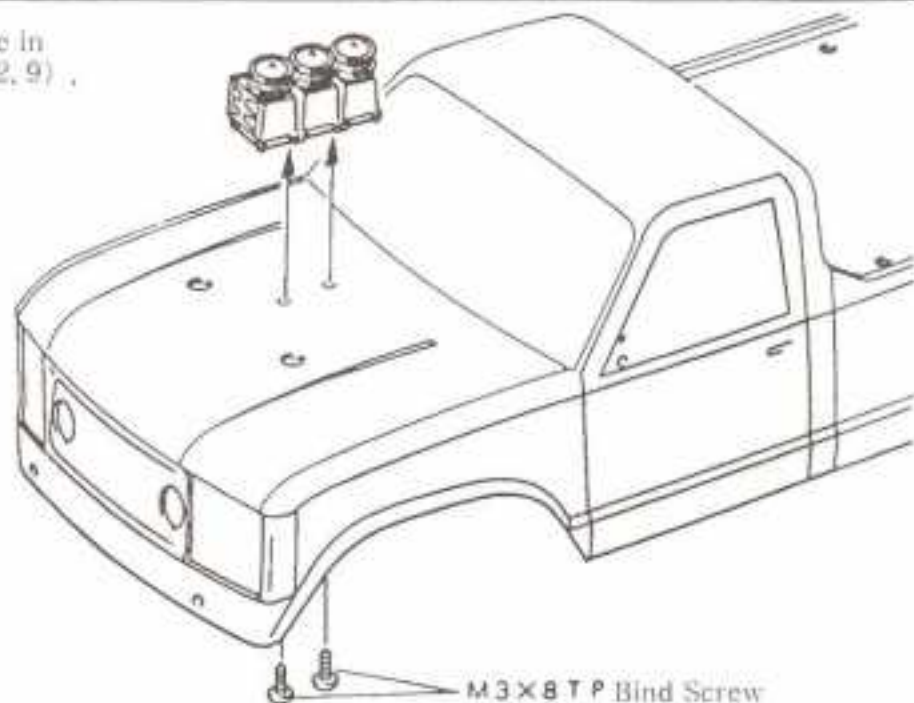
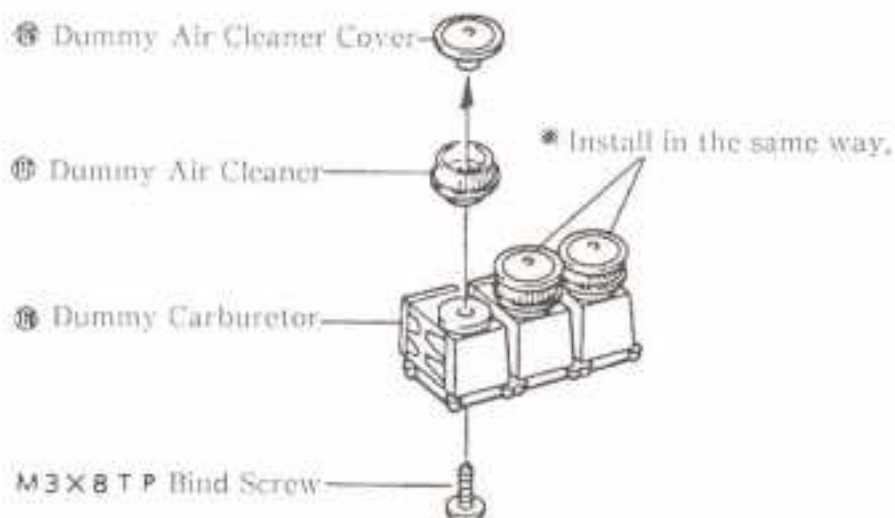

M3X8TP Bind Screw

24 ASSEMBLY OF ROLL BAR

These parts are in the bag (US-2, 9).

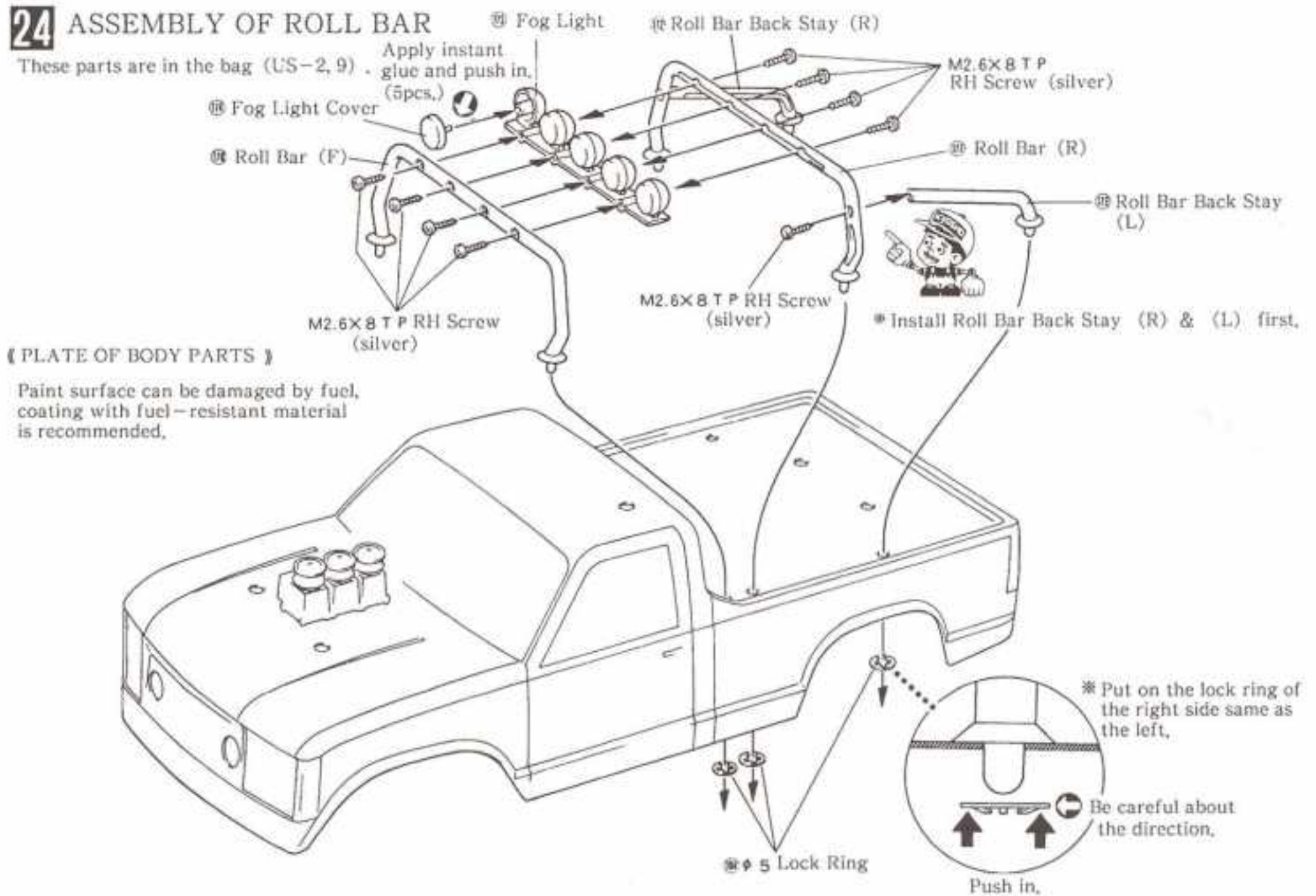

25 INSTALLATION OF ACCESSORIES PARTS

These parts are in the bag (US-2, 9).

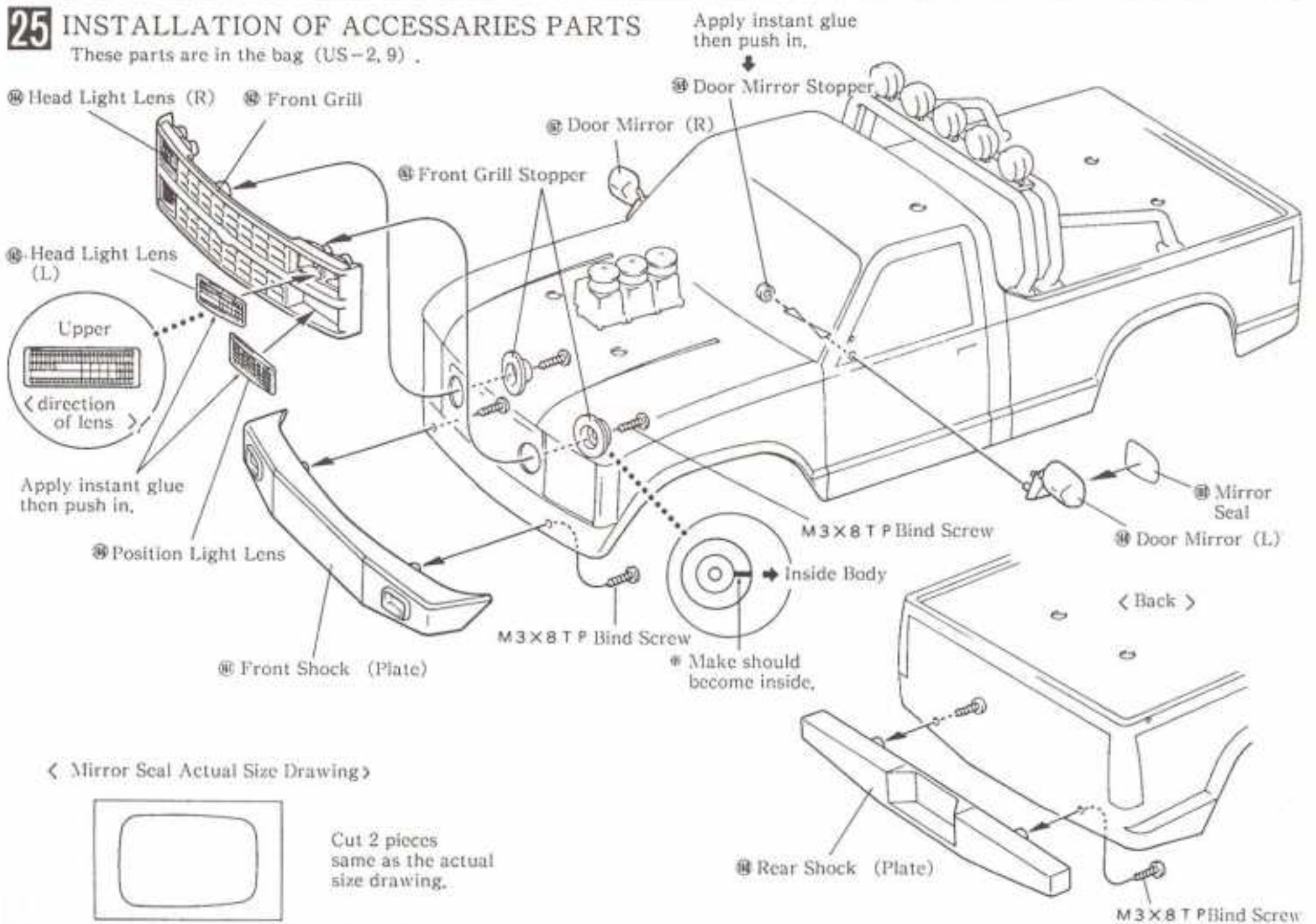

26 APPLING DECAL AND INSTALLATION OF SIDE GUARD

« Attention of applying the decal. »

- Cut off the decals along the cutout line with a scissors.
- Do not apply suddenly, convince yourself of the position by trying the decals with the backing paper on.
- Be careful not to have air bubbles left. Apply it by a way of pushing up from the center to the outside. (Especially, the largest decal...)

Be careful not to have air bubbles left. Apply it by a way of pushing up from the center to the outside. (Especially, the largest decal...)

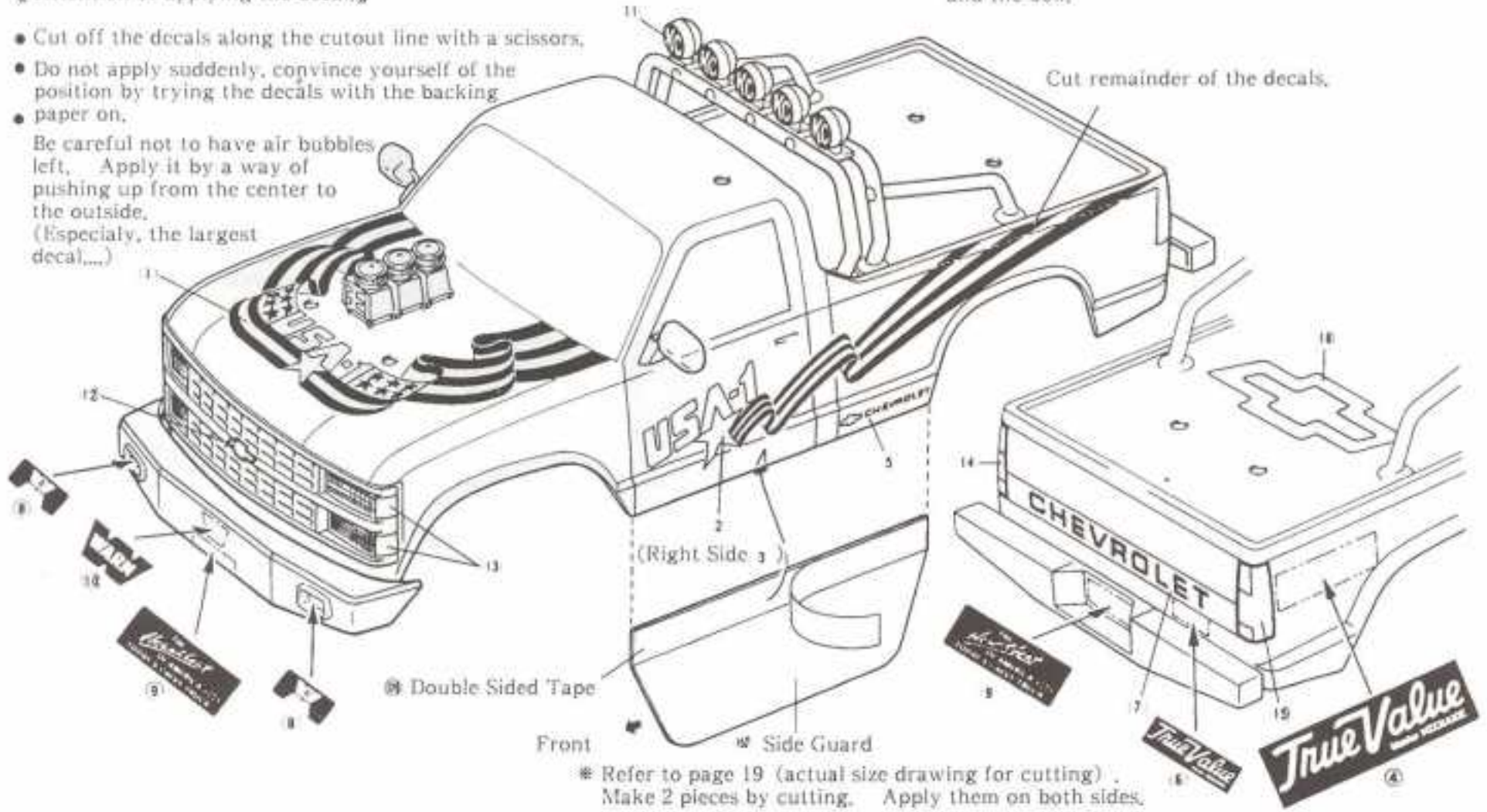

27 INSTALLATION OF BODY

These parts are in the bag (US-2).

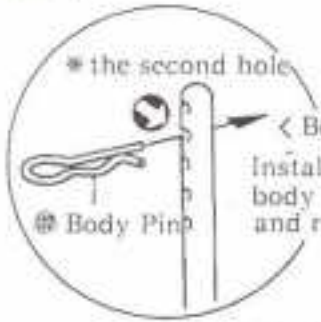

« Before installing the body... »
Install the body pin in the body mounts of front and rear.

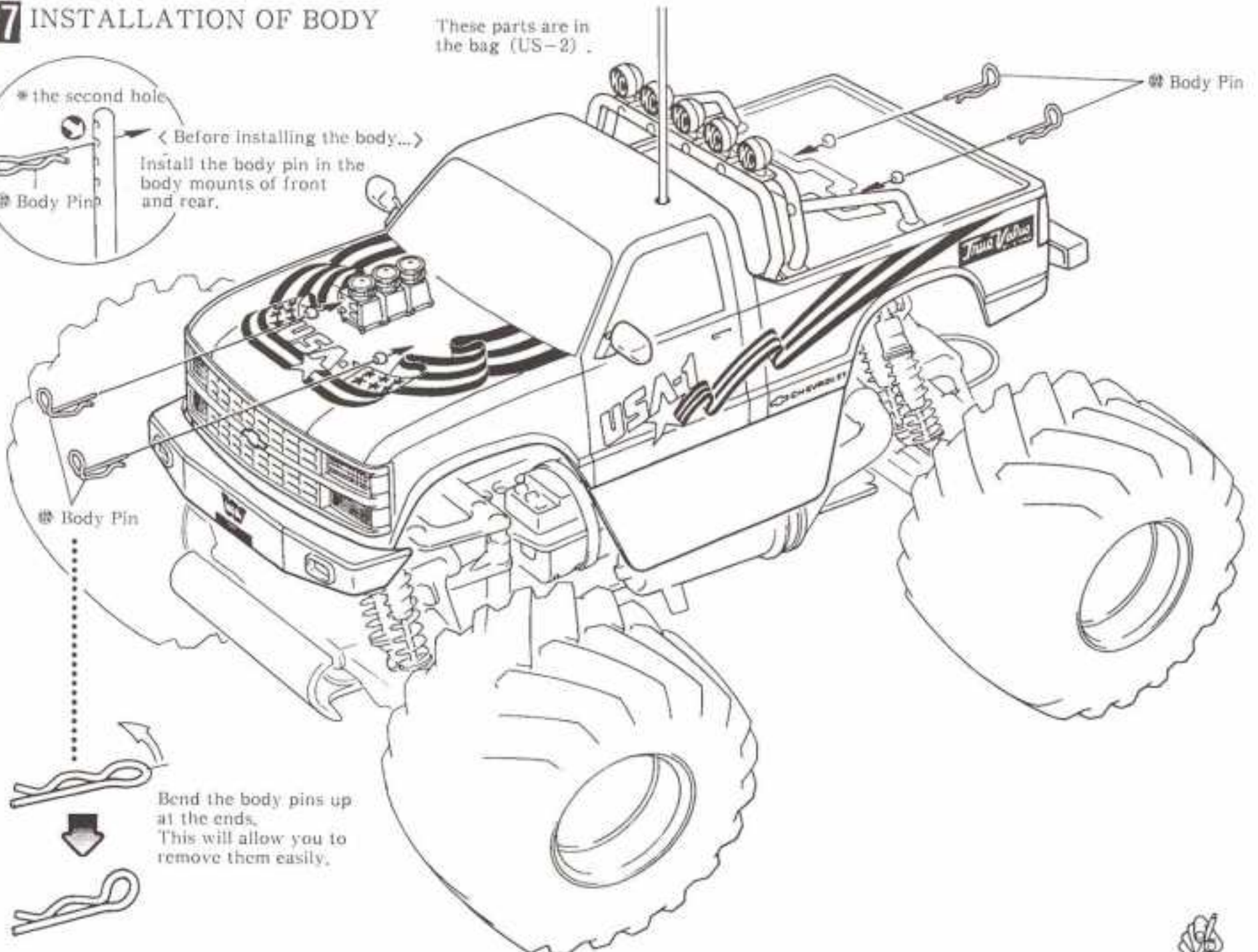

● STARTING ENGINE

STAGE I

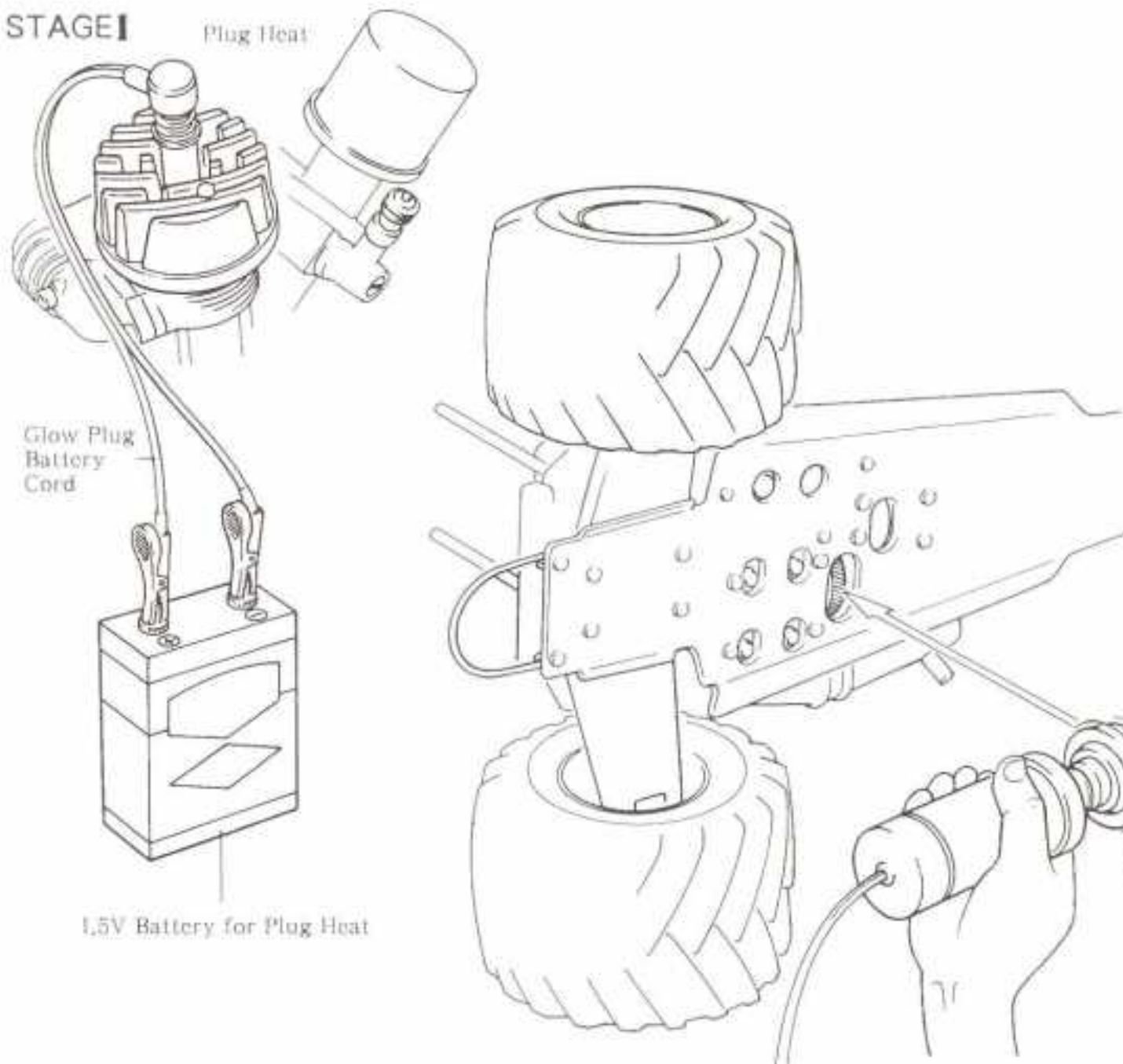

It is equipped with a high power 12 volt DC motor. It powers your model with fast rotation and high torque. It will start all models such as racing and buggy cars, air planes, helicopters and boats mounted with small to large sized engines.

No. BZ-1

No. 1791

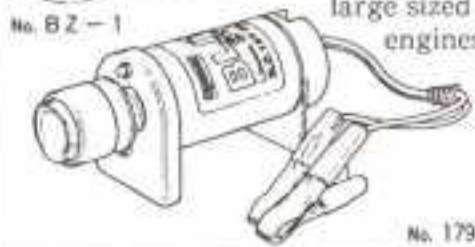

STAGE 2

Spin the flywheel with the starter.

● EXPLODED VIEW OF REAR GEAR BOX

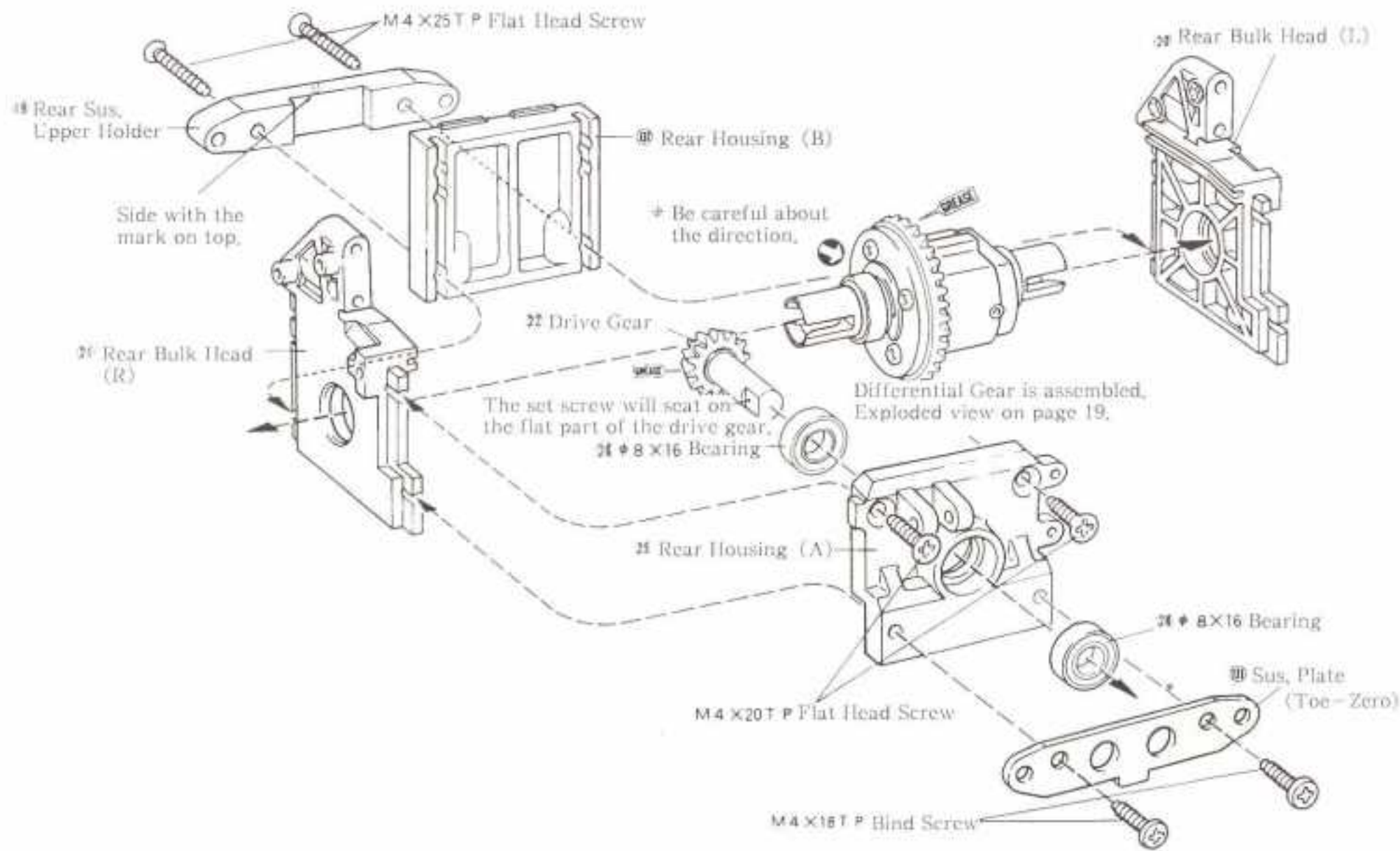

● EXPLODED VIEW OF DIFFERENTIAL GEARS.

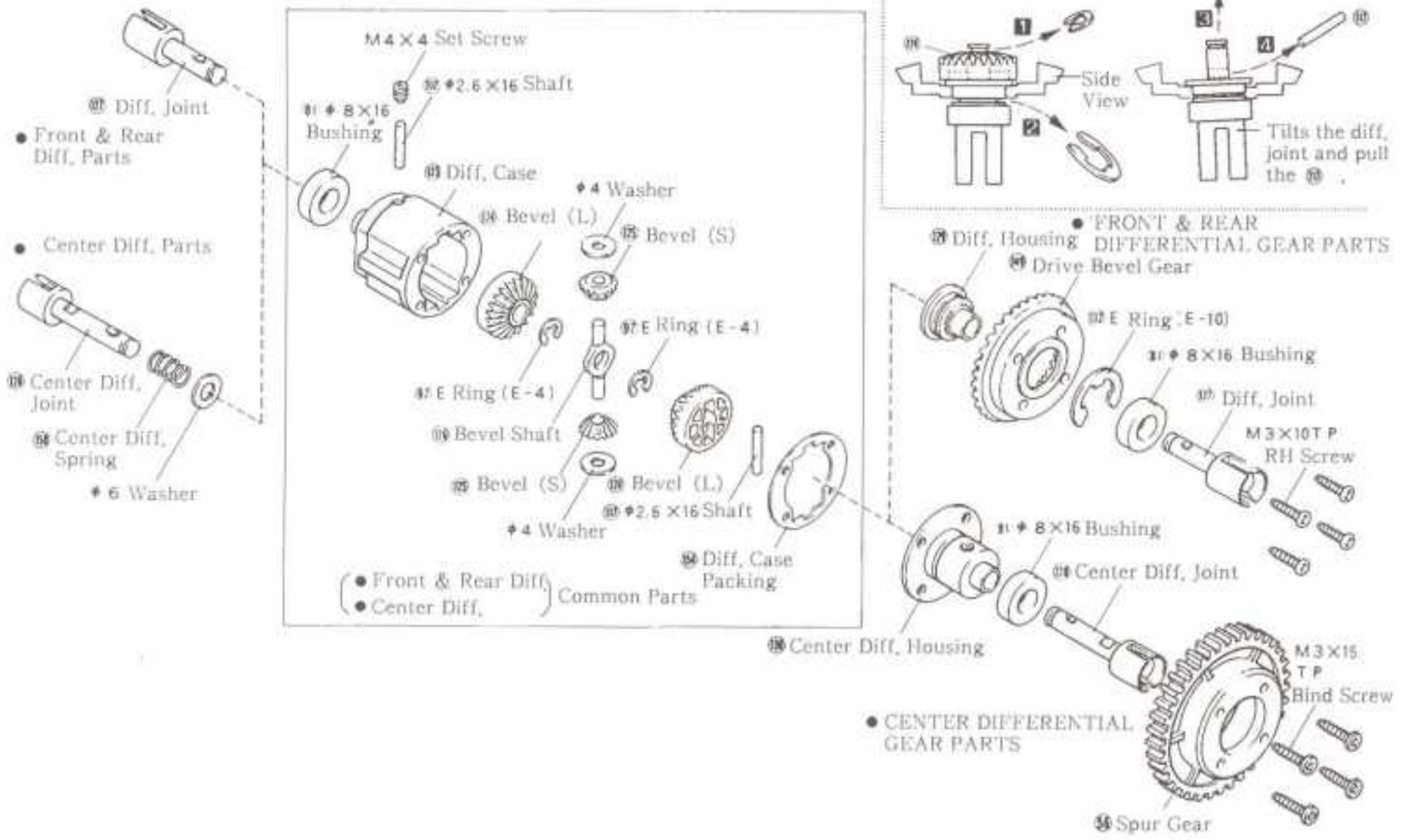

● SIDE GUARD ACTUAL SIZE DRAWING FOR CUTTING

Cut off the shaded area.

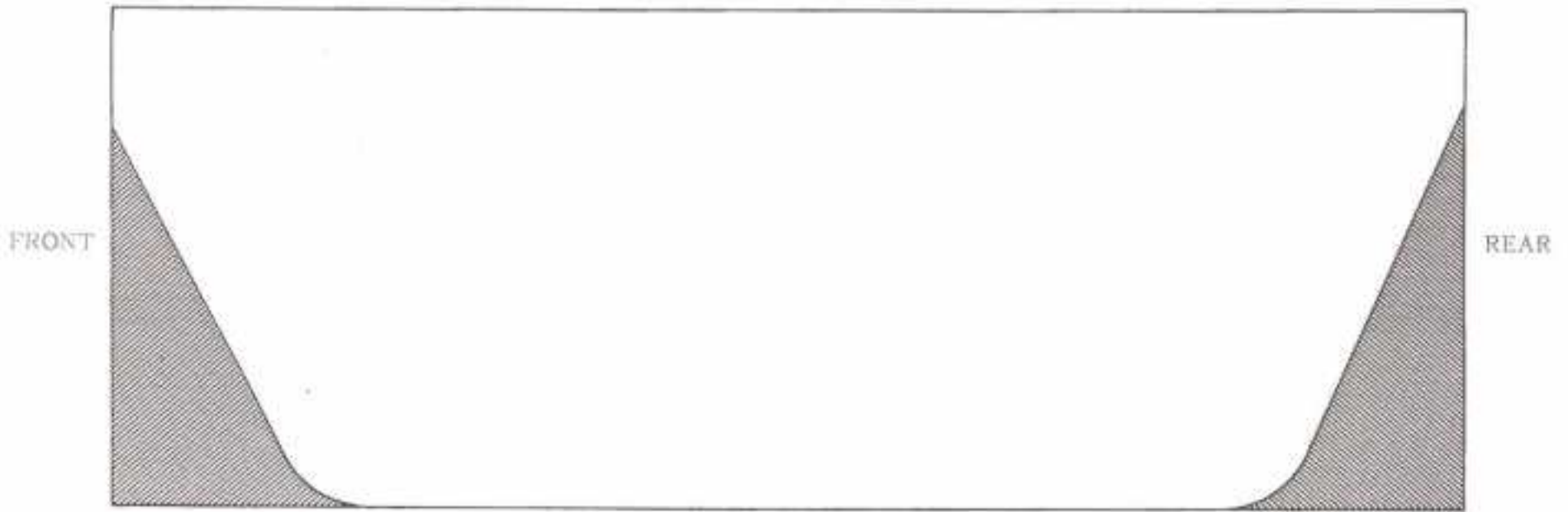

KEY NUMBER PARTS LIST

Key #	Parts Name	Q'ty	Key #	Parts Name	Q'ty	Key #	Parts Name	Q'ty
①	Shock Piston	8	⑤④	Linkage Guide (A)	1	⑦⑦	Differential Joint	4
②	E Ring (E-2.5)	32	⑤⑤	Servo Saver Shaft (A)	2	⑦⑧	Center Diff. Joint	2
③	Spring Holder	8	⑤⑥	• (B)	1	⑦⑨	Differential Housing	2
④	Spring Adjuster	8	⑤⑦	Front Gear Cover	1	⑦⑩	Center Diff. Housing	1
⑤	Shock Ring	8	⑤⑧	Servo Saver Spring	1	⑦⑪	Sus. Plate (Toe-zero)	1
⑥	Shock Spring (gold)	8	⑤⑨	Servo Saver Horn (A)	1	⑦⑫	E Ring (E-10)	2
⑦	Shock Case	8	⑥⑩	• (B)	1	⑦⑬	Front Sus. Upper Holder	1
⑧	Shock End	8	⑥⑪	• (C)	1	⑦⑭	Strap (M)	3
⑨	Pressure Top	8	⑥⑫	E Ring (E-7)	2	⑦⑮	Rear Shock	1
⑩	Shock Cap	8	⑥⑬	Tie Rod (A)	3	⑦⑯	Servo Spacer	2
⑪	Shock Shaft	8	⑥⑭	• (B)	1	⑦⑰	Rear Housing (B)	1
⑫	Shock Pivot No 1	1	⑥⑮	φ 6 Aluminum Collar	2	⑦⑱	Front Suspension Arm	2
⑬	• No 2	1	⑥⑯	Antenna Pipe	1	⑦⑲	Silicone Grease	1
⑭	• No 3	1	⑥⑰	Radio Plate	1	⑦⑳	Screw-Locking Compound	1
⑮	• No 4	1	⑥⑱	Switch Boot	1	⑦㉑	Rear Hub (L)	1
⑯	Front Body Mount	2	⑥㉑	Servo Fixing Post	4	⑦㉒	Engine Control Rod	1
⑰	Rear •	2	⑥㉒	Strap (L)	1	⑦㉓	Main Chassis	1
⑱	Rear Suspension Holder	1	⑥㉓	φ 8 X16 Bushing	16	⑦㉔	Upper Suspension (C)	2
⑲	Rear Sus. Upper Holer	1	⑥㉔	Center Shaft	2	⑦㉕	Decal	1
⑳	Rear Bulk Head (L)	1	⑥㉕	Mount Plate	2	⑦㉖	Air Cleaner	1 set
㉑	• (R)	1	⑥㉖	Torque Rod Pivot	1	⑦㉗	φ 4 X64 Shaft	2
㉒	Drive Gear	2	⑥㉗	Fuel Tank Pivot	1	⑦㉘	φ 38 Muffler Baffle	1
㉓	Joint	2	⑥㉘	Bumper	1	⑦㉙	Drive Bevel Gear	2
㉔	Suspension Plate	1	⑥㉙	Manifold	1	⑦㉚	Center Diff. Spring	1
㉕	Rear Housing (A)	1	⑥㉚	Engine Mount	2	⑦㉛	Radio Cover	1
㉖	Rear Suspension Arm	2	⑥㉛	Flywheel	1	⑦㉜	Side Guard	2
㉗	Rear Hub (R)	1	⑥㉜	Clutch Pin	2	⑦㉝	Brake Rod	1
㉘	φ 8 X16 Bearing	2	⑥㉝	Pilot Shaft	1	⑦㉞	Diff. Case Packing	3
㉙	Upper Suspension (A)	2	⑥㉞	Clutch Shoe	2	⑦㉟	φ 5 X10 Bearing	2
㉚	• (B)	4	⑥㉟	Clutch Spring	1	⑦㊱	φ 5 X10 Collar	1
㉛	M 5 X35 Shaft	4	⑥㊱	Clutch Bearing Case	1	⑦㊲	Counter Gear	1
㉜	Rear Wheel Shaft	2	⑥㊲	Clutch Roller	8	⑦㊳	Counter Gear Mount	1
㉝	Swing Shaft	2	⑥㊳	Clutch Bell (13T)	1	⑦㊴	Counter Gear Shaft	1
㉞	Rear Shock Stay	1	⑥㊴	E Ring (E-4)	1	⑦㊵	Rear Bumper (Plate)	1
㉟	φ 3 X27 Shaft	4	⑥㊵	Muffler (A)	1	⑦㊶	Front Bumper (Plate)	1
㊱	φ 3 X44 •	8	⑥㊶	• (B)	1	⑦㊷	Front Grill	1
㊲	φ 4 X77 •	2	⑥㊷	Servo Fixing Stay (A)	1	⑦㊸	Front Grill Stopper	2
㊳	E Ring (E-3)	9	⑥㊸	• (B)	1	⑦㊹	Headlight Lens (R)	1
㊴	φ 3 Stopper	4	⑥㊹	Tank Cap	1	⑦㊺	• (L)	1
㊵	Rear Gear Cover	1	⑥㊺	Tank Seal	1	⑦㊻	Position Light Lens	2
㊶	Shock Bush	8	⑥㊻	Fuel Tank	1	⑦㊼	Door Mirror (R)	1
㊷	φ 6.8 Ball	7	⑥㊼	Aluminum Pipe	1	⑦㊽	• (L)	1
㊸	φ 6.8 Ball End	8	⑥㊽	Rubber Bush	1	⑦㊾	Door Mirror Stopper	2
㊹	φ 8 Aluminum Collar	2	⑥㊾	Tube	1	⑦㊿	Roll Bar (F)	1
㊺	Front Housing (A)	1	⑥㊿	Plate Joint	1	⑧①	• (R)	1
㊻	• (B)	1	⑥①	Steering Rod	1	⑧②	Roll Bar Back Stay (R)	1
㊼	Front Bulk Head (R)	1	⑥②	φ 2 Stopper	5	⑧③	• (L)	1
㊽	• (L)	1	⑥③	Engine Control Spring	1	⑧④	Fog Light Cover	5
㊾	Front Shock Stay	1	⑥④	Linkage Guide (B)	1	⑧⑤	Fog Light	1
㊿	Knuckle Arm (R)	1	⑥⑤	Wheel	4	⑧⑥	Dummy Air Cleaner Cover	3
①	• (L)	1	⑥⑥	Tire	4	⑧⑦	Dummy Air Cleaner	3
②	Hub Carrier (R)	1	⑥⑦	Brake Lining	2	⑧⑧	Carburetor	1
③	• (L)	1	⑥⑧	Universal Joint	2	⑧⑨	Double Sided Tape	1
④	King Pin	4	⑥⑨	φ 2.6 X16 Shaft	4	⑧⑩	Mirror Seal	1
⑤	M 3 Pivot Ball	8	⑥⑩	Wheel Stopper	4	⑧⑪	Shock Oil	2
⑥	Spur Gear	1	⑥⑪	O-Ring (L)	4			
⑦	Center Diff. Housing (A)	1	⑥⑫	Wheel Stopper Bolt	4	⑧⑫	φ 8 X16 Washer (Alumi.)	4
⑧	• (B)	1	⑥⑬	Body	1	⑧⑬	φ 5 Lock Ring	6
⑨	Disk Brake	1	⑥⑭	Body Pin	8			
⑩	Brake Pads	2	⑥⑮	Differential Case	3			
⑪	Brake Cam	1	⑥⑯	Bevel (L)	6			
⑫	Brake Stopper	1	⑥⑰	• (S)	6			
⑬	Brake Lever	1	⑥⑱	Bevel Shaft	3			

1 ASSEMBLY OF SHOCK

- ① E Ring (E-2.5) 16
- ② Shock End 8

3 ASSEMBLY OF REAR GEAR BOX

- M4X15TP Bind Screw 4
- M3X18 Cap Screw 4
- M4X20TP Flat Head Screw 2
- M4X25TP Flat Head Screw 2
- M3 Flange Nut 4
- ② E Ring (E-2.5) 4
- M5X4 Set Screw 1
- ⑩ M5X35 Shaft 2
- ⑪ φ 3X44 Shaft 2

4 INSTALLATION OF REAR SUSPENSION ARM

- M3X10TP Bind Screw 4
- M3X3 Set Screw 2
- M4X12 Set Screw 2
- ② E Ring (E-2.5) 4
- ⑧ E Ring (E-3) 4
- ⑬ φ 3X27 Shaft 2
- ⑭ φ 3X44 Shaft 2
- ⑰ φ 4X77 Shaft 2

5 INSTALLATION OF REAR SHOCK

- M2.6X18TP Round Head Screw 4
- M3X15 Bind Screw 1
- M3 Nylon Nut 4
- ⑳ M3 Pivot Ball (silver) 4
- ⑲ Tie Rod (A) 1
- ④ Shock Bush 4
- ⑬ φ 6.8 Ball End 2

6 ASSEMBLY OF FRONT GEAR BOX

- M3X10TP Bind Screw 2
- M3X18 Cap Screw 4
- M3X18 Round Head Screw 2
- M4X20TP Flat Head Screw 2
- M4X25TP Flat Head Screw 2
- M5X4 Set Screw 1
- M3 Flange Nut 6

7 INSTALLATION OF FRONT SUSPENSION ARM

- M3X10TP Bind Screw 4
- M3X3 Set Screw 2
- M4X12 Set Screw 2
- ② E Ring (E-2.5) 8
- ⑧ E Ring (E-3) 4
- ⑩ M5X35 Shaft 2
- ⑬ φ 3X27 Shaft 2
- ⑭ φ 3X44 Shaft 4
- ⑰ φ 4X64 Shaft 2

8 INSTALLATION OF FRONT SHOCK

- M2.6X16TP Round Head Screw 2
- M2.6X18TP Round Head Screw 2
- M3 Nylon Nut 4
- ⑳ M3 Pivot Ball (silver) 4
- ④ Shock Bush 4

9 INSTALLATION OF BRAKE & COUNTER GEAR

- M3X10TP Bind Screw 2
- M4X15TP Bind Screw 4
- M4X8 Bind Screw 3
- M3X18 Cap Screw 2
- M3X3 Set Screw 1
- M5 Flange Nut 1

- ⑦ E Ring (E-4) 1
- φ 5X10 Washer 1
- φ 5X12 Washer 2
- ⑫ φ 5X10 Collar 1

11 ASSEMBLY OF STEERING PORTION

- M3X25 Bind Screw 2
- M4X8 Bind Screw 2
- M3 Nylon Nut 3
- ④ Linkage Guide (A) 1
- φ 3 Washer 4
- ⑮ φ 6 Aluminum Collar 2
- ⑫ φ 6.8 Ball End 6
- ⑲ Tie Rod (B) 1
- ⑲ Tie Rod (A) 2

12 INSTALLATION OF RADIO SYSTEM

- M3X15TP Bind Screw 4
- ⑲ Servo Fixing Post 2

13 INSTALLATION OF REAR ASSEMBLY

- M3X10 Bind Screw 1
- M4X10 Bind Screw 2
- M3X10TP Bind Screw 1
- M4X15TP Bind Screw 4
- M4 Flange Nut 2

14 INSTALLATION OF FRONT ASSEMBLY

- M3X12 Flat Head Screw 2
- M4X20TP Flat Head Screw 2
- M4X15TP Bind Screw 2

15 INSTALLATION OF CLUTCH

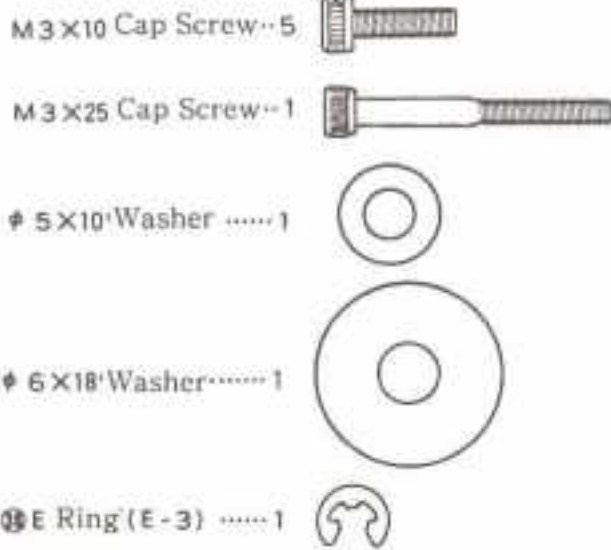

16 INSTALLATION OF ENGINE & ENGINE CONTROL SERVO.

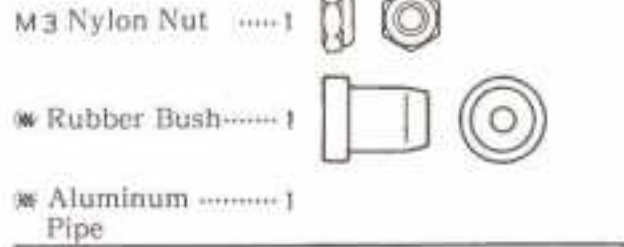
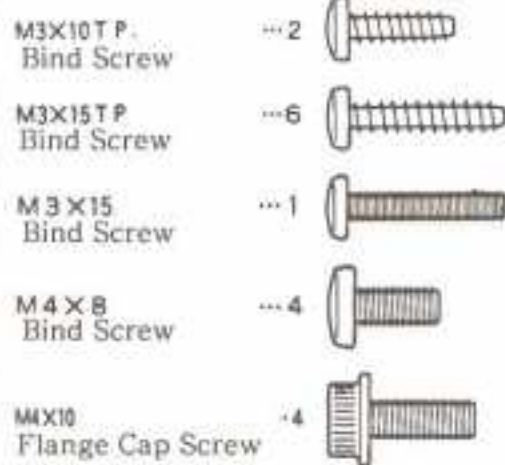

17 INSTALLATION OF RADIO PLATE



18 LINKAGE OF ENGINE CONTROL

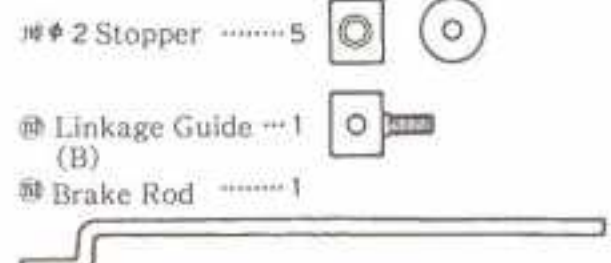
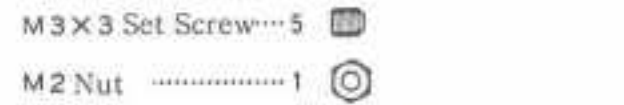

20 INSTALLATION OF TIRE



23 INSTALLATION OF CARBURETOR



24 ASSEMBLY OF ROLL BAR

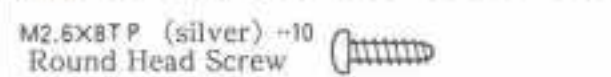

25 INSTALLATION OF ACCESSORIES PARTS

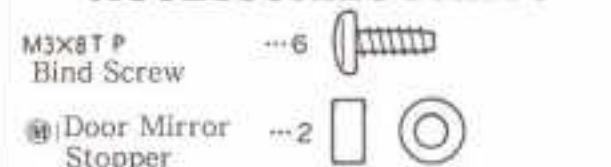

DRAWING OF PLASTIC PARTS WITH RUNNERS

* Do not use the shaded parts.

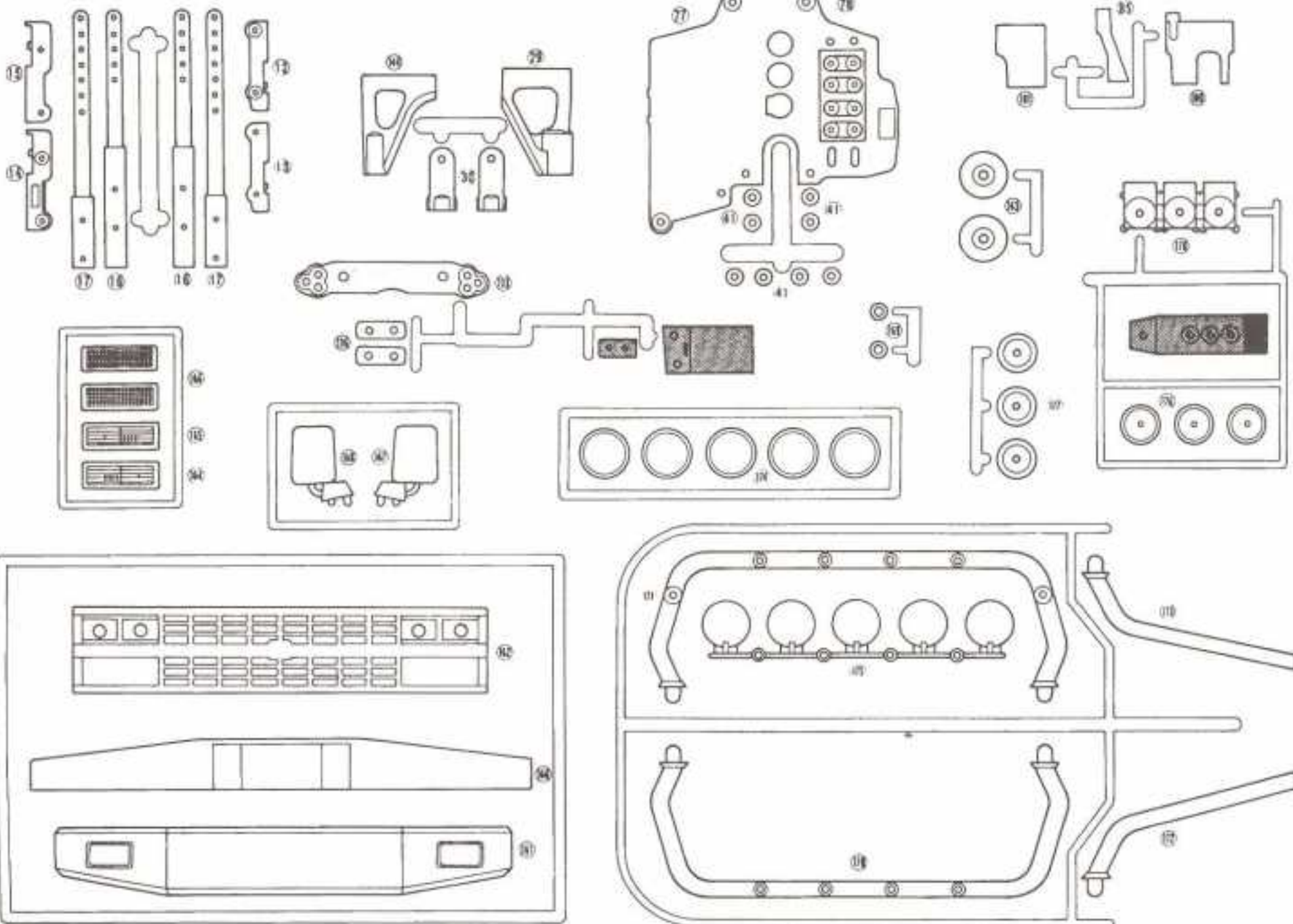

PURCHASABLE PARTS FOR YOUR KIT

You can purchase replacement optional parts for your kit. All of the part identified by key number are usually not available singularly, but we offer these parts in convenient parts "packs" which can be purchased separately. To figure out which parts pack you need, find the key number for that part within the manual.

Then consult our part guide below. When referring to the parts you need, always use the Parts Pack Number. For example, if you need a King Pin (Key # 34) ask your dealer for Kyosho Parts Pack KC-7 (King Pin).

No.	Parts Name	Key # & Q'ty
BS-3	Sus. Holder Set	18 19 20 21 22 23 24 25 26 27 28 29 30 31 32 33 34 35 36 37 38 39 40 41 42 43 44 45 46 47 48 49 50 51 52 53 54 55 56 57 58 59 60 61 62 63 64 65 66 67 68 69 70 71 72 73 74 75 76 77 78 79 80 81 82 83 84 85 86 87 88 89 90 91 92 93 94 95 96 97 98 99 100 101 102 103 104 105 106 107 108 109 110 111 112 113 114 115 116 117 118 119 120 121 122 123 124 125 126 127 128 129 130 131 132 133 134 135 136 137 138 139 140 141 142 143 144 145 146 147 148 149 150 151 152 153 154 155 156 157 158 159 160 161 162 163 164 165 166 167 168 169 170 171 172 173 174 175 176 177 178 179 180 181 182 183 184 185 186 187 188 189 190 191 192 193 194 195 196 197 198 199 200 201 202 203 204 205 206 207 208 209 210 211 212 213 214 215 216 217 218 219 220 221 222 223 224 225 226 227 228 229 230 231 232 233 234 235 236 237 238 239 240 241 242 243 244 245 246 247 248 249 250 251 252 253 254 255 256 257 258 259 260 261 262 263 264 265 266 267 268 269 270 271 272 273 274 275 276 277 278 279 280 281 282 283 284 285 286 287 288 289 290 291 292 293 294 295 296 297 298 299 300 301 302 303 304 305 306 307 308 309 310 311 312 313 314 315 316 317 318 319 320 321 322 323 324 325 326 327 328 329 330 331 332 333 334 335 336 337 338 339 340 341 342 343 344 345 346 347 348 349 350 351 352 353 354 355 356 357 358 359 360 361 362 363 364 365 366 367 368 369 370 371 372 373 374 375 376 377 378 379 380 381 382 383 384 385 386 387 388 389 390 391 392 393 394 395 396 397 398 399 400 401 402 403 404 405 406 407 408 409 410 411 412 413 414 415 416 417 418 419 420 421 422 423 424 425 426 427 428 429 430 431 432 433 434 435 436 437 438 439 440 441 442 443 444 445 446 447 448 449 450 451 452 453 454 455 456 457 458 459 460 461 462 463 464 465 466 467 468 469 470 471 472 473 474 475 476 477 478 479 480 481 482 483 484 485 486 487 488 489 490 491 492 493 494 495 496 497 498 499 500 501 502 503 504 505 506 507 508 509 510 511 512 513 514 515 516 517 518 519 520 521 522 523 524 525 526 527 528 529 530 531 532 533 534 535 536 537 538 539 540 541 542 543 544 545 546 547 548 549 550 551 552 553 554 555 556 557 558 559 560 561 562 563 564 565 566 567 568 569 570 571 572 573 574 575 576 577 578 579 580 581 582 583 584 585 586 587 588 589 590 591 592 593 594 595 596 597 598 599 600 601 602 603 604 605 606 607 608 609 610 611 612 613 614 615 616 617 618 619 620 621 622 623 624 625 626 627 628 629 630 631 632 633 634 635 636 637 638 639 640 641 642 643 644 645 646 647 648 649 650 651 652 653 654 655 656 657 658 659 660 661 662 663 664 665 666 667 668 669 670 671 672 673 674 675 676 677 678 679 680 681 682 683 684 685 686 687 688 689 690 691 692 693 694 695 696 697 698 699 700 701 702 703 704 705 706 707 708 709 710 711 712 713 714 715 716 717 718 719 720 721 722 723 724 725 726 727 728 729 730 731 732 733 734 735 736 737 738 739 740 741 742 743 744 745 746 747 748 749 750 751 752 753 754 755 756 757 758 759 760 761 762 763 764 765 766 767 768 769 770 771 772 773 774 775 776 777 778 779 780 781 782 783 784 785 786 787 788 789 790 791 792 793 794 795 796 797 798 799 800 801 802 803 804 805 806 807 808 809 810 811 812 813 814 815 816 817 818 819 820 821 822 823 824 825 826 827 828 829 830 831 832 833 834 835 836 837 838 839 840 841 842 843 844 845 846 847 848 849 850 851 852 853 854 855 856 857 858 859 860 861 862 863 864 865 866 867 868 869 870 871 872 873 874 875 876 877 878 879 880 881 882 883 884 885 886 887 888 889 890 891 892 893 894 895 896 897 898 899 900 901 902 903 904 905 906 907 908 909 910 911 912 913 914 915 916 917 918 919 920 921 922 923 924 925 926 927 928 929 930 931 932 933 934 935 936 937 938 939 940 941 942 943 944 945 946 947 948 949 950 951 952 953 954 955 956 957 958 959 960 961 962 963 964 965 966 967 968 969 970 971 972 973 974 975 976 977 978 979 980 981 982 983 984 985 986 987 988 989 990 991 992 993 994 995 996 997 998 999 1000
BS-4	Rear Bulk Head	20 21 22 23 X 1
BS-5	Front Bulk Head	45 46 47 48 X 1
BS-6	Lower Sus. Arm Set	26 X 2
BS-7	Upper Sus. Arm Set	28 29 X 2 30 X 4
BS-8	Front Hub Carrier	32 33 X 1
BS-9	Rear Hub Carrier	27 28 X 1
BS-10	Front Shock	36 X 1
BS-12	Radio Plate	75 X 1 41 76 X 4
BS-13	Shaft Set	35 36 X 8 37 38 X 2
BS-14	Drive Bevel Gear Set	22 23 X 1
BS-16	φ 8X16 Bearing	28 X 2
BS-17	Rear Wheel Shaft	32 X 2
BS-18	Gear Cover	40 41 X 1
BS-21	Brake Set	39 40 41 42 43 44 X 1 45 46 X 2
BS-22	Servo Saver Set	66 67 68 69 70 71 X 1 72 X 2 73 X 4
BS-23	Tie Rod Set	74 X 1 75 X 2 42 43 X 6
BS-25	Engine Mount	81 82 X 2
BS-26	Manifold	87 X 1
BS-27	Muffler	34 35 36 X 1 37 X 2
BS-28	Fuel Tank Set	88 89 90 91 92 93 X 1
BS-33	Wheel Stopper Set	101 102 103 X 4
BS-35	Diff. Case	104 X 1 105 X 1
BS-36	Diff. Bevel (L)	106 X 2
BS-37	• (S)	107 X 2
BS-38	Bevel Shaft	108 X 2
BS-39	Diff. Joint	109 X 2
BS-40	Center Diff. Joint	110 X 2
BS-41	Diff. Housing	111 X 1
BS-42	Center Diff. Housing	112 113 X 1
BS-43	Linkage Set	114 115 116 117 118 119 X 1 120 X 6
BS-44	Flywheel	121 X 1 122 X 2
BS-45	Swing Shaft	123 X 2
BS-46	φ 6.8 Ball	124 X 10
BS-47	E Ring(E-10)	125 X 10
BS-50	Aluminum Collar Set	144 X 1 145 146 X 2
BS-51	Main Chassis	147 X 1
BS-52	φ 2.6X16 Shaft	148 X 10
BS-55	Wheel Stopper Bolt	149 150 X 6
BS-20	Universal Joint	149 X 2
BS-76	Cut Knuckle Arm	151 152 X 1
BS-77	φ 8X16 Bushing	81 X 2
BS-78	Radio Cover	153 X 1
BS-79	Switch Boot	154 X 3
BS-80	Shock Stay (USA-1)	155 156 157 158 X 1 GP
BS-81	Rear Bumper (")	159 X 1 GP
BS-82	Body (USA-1)	160 X 1 GP
BS-83	Tire (USA-1)	161 X 2 GP Hard Type
BS-84	Counter Gear Set	162 163 164 X 1
BS-85	Counter Gear Shaft	165 X 1
BS-86	Counter Gear Mount	166 X 1
BS-87	Wheel (USA-1)	167 X 2 GP
BS-88	Screw Set (USA-1)	1 set GP

No.	Parts Name	Key # & Q'ty
BSW-49	Toe-Zero Rear Plate	161 X 1
FM-29	Body Pin	162 X 10
FM-73	Pilot Shaft	163 X 1
FM-185	Joint	164 X 2
KC-7	King Pin	165 X 4
KC-18	φ 3 Stopper	166 X 10
KC-20	E Ring(E-4)	167 X 4
KC-45	Special Clutch Shoe	168 X 1 169 X 2
LD-70	Clutch Bearing	170 X 1 171 X 8
SD-54	Clutch Bell (13T)	172 X 1
SD-79	Antenna Pipe	173 X 5
OT-31	M3 Pivot Ball	174 X 10
OT-38	Silicone Grease	175 X 2
OT-39	E Ring(E-2.5)	176 X 10
EF-38	Strap	177 X 6
EF-39	NiCd Strap	178 X 6
CB-72	E Ring(E-3)	179 X 4
CB-110	Air Cleaner	180 X 1
CB-151	Center Shaft	181 X 2
FD-38	Black Shock (L)	182(1)(2)(3)(4)(5)(6)(7)(8)(9)(10) X 2 (11) X 4
TB-51	Body Mount	183 184 185 X 1 186 187 X 2
UM-84	Side Guard	188 X 2
DA-19	Carburetor Set	189 190 X 3 191 X 1
DA-30	Accessories Set	192 193 194 195 196 197 198 199 200 X 1 201 202 X 2
DA-31	Roll Bar Set	203 204 205 206 207 X 1 208 X 5
DA-35	Decal (USA-1)	209 210 X 1
1840	Double Sided Tape	211 X 1
1878	ScrewLockingCompound	212 X 2
1901	Ball Bearing (5x10)	213 X 2

Optional Spare Parts

No.	Parts Name	Key # & Q'ty
FM-75	Clutch Bearing	Full Ball Type
FM-82	Clutch Bell(12Z)	
SD-53	• (12T)	
SD-55	• (14T)	
FM-222	• (15T)	
FM-160	Special Engine Mount	175
BS-20	Universal Joint	149 + 150
BS-65	Fuel Tank	
BSW-1	Drive Bevel (S)	Steel
BSW-2	• (L)	Steel
BSW-3	Special Manifold	OS-ENYA
BSW-22	Flywheel	OS-21EX,OPS
BSW-48	Custom Silencer	
1951	Shock Oil (S•M•H)	x 3
1953	Silicone Oil -(S)	Viscosity 100S C,200S C
1954	• (M)	• 300S C,400S C
1955	• (H)	• 500S C,600S C
1956	• (Super Hard)	Diff,
BS-53	Shim Set	φ 4X10, φ 6X18, φ 12X16, φ 8X12
NB-13	Light Set	Light 2 Battery Case

The Super Hobby



This products is not to be sold in the United States. If you have purchased this product in the United States, please contact Kyosho U. S. A, phone number (217) 398-3630.

PRINTED IN JAPAN

ACG 11